

Superwhite 34 Blown Insulation – Cavity Wall.

November 2023 | Data Sheet

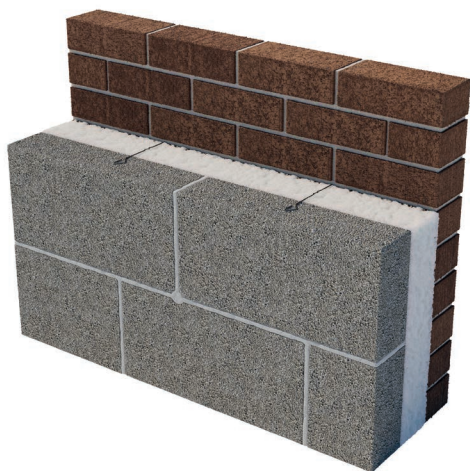

Description.

Superglass Superwhite 34 is a water repellent, non-combustible and British Board of Agrément (BBA) approved glass mineral wool blown cavity wall insulation for use as a full fill solution for new build external masonry cavity walls.

Application.

Superglass Superwhite 34 is designed to provide thermal insulation for new build masonry cavity walls with a minimum cavity width of 90mm and up to 12m in height. It can be installed in buildings over 12m in height subject to a satisfactory inspection of the wall construction and a height restriction waiver has been issued by Superglass Insulation. The product is BBA approved for all UK exposure zones (subject to conditions detailed in the BBA Certificate) and can also be installed in masonry party/separating walls.

Superwhite 34 may also be used in party walls and is a component in several Robust Details Solutions including proprietary system E-WM-33.

Installation:

Superglass Superwhite 34 is installed by a network of approved technicians after the walls are built and the building is watertight.

Performance.

Thermal Conductivity:

Declared thermal conductivity (lambda (λ) value) of 0.034W/mK.

Fire Classification:

Deemed non-combustible with a fire classification of Euroclass A1 (the highest possible rating) when tested to BS EN 13501-1 Reaction to Fire.



Typical applications:
New build external masonry cavity walls.



Thermal
Insulation



Non-
combustible



Easy to
Install



Recycled
Content

Intelligent Environments
Superglass

superglass.co.uk

Superwhite 34 Blown Insulation – Cavity Wall.

Technical Characteristics.

Product Specification.

Product Code	Nominal Bale Weight (kg)	Bales per pallet
1030	16.60	28

For an installed density of 25kg/m³ the following coverage should be obtained per bale

Cavity Width (mm)	Coverage (m ² /bale)**	Thermal Resistance (m ² K/W)
90	7.30	2.60
100	6.60	2.90
125	5.30	3.65
150	4.40	4.40
165	4.00	4.85

Please note that all dimensions are nominal.

Additional Information.

Buildings over 12m in height.

The product can be installed in buildings over 12m in height subject to a satisfactory inspection of the wall construction and a height restriction waiver has been issued by Superglass Insulation.

Superglass Insulation has a detailed programme for the assessment of buildings over 12m, as approved and maintained under surveillance by the BBA. Each installation beyond 12m must be individually assessed by the Superglass Insulation against this agreed assessment programme and documented approval given prior to the commencement of work.

Water Resistance

When the product is properly installed in accordance with BBA Certificate 14/5086 Product Sheet 2, it will resist any water transfer across the cavity to the inner leaf.

Vapour Resistivity

The product has a nominal vapour resistivity of 5 MNs/gm.

Guarantee

Superwhite 34 has a 10 year guarantee.

Environmental:

- Manufactured in accordance with ISO 14001 - Environmental Management Systems (EMS). Certificate number: EMS 646508.
- Contains no ozone-depleting substances or greenhouse gases. For more information, please refer to the Environmental Product Declaration (EPD).

- Made from up to 84% recycled glass.
- Generic BRE Green Guide Rating of A+.

Standards and Approvals:

- BS EN 14064-1: 2010 for In-situ formed loose-fill mineral wool products.
- BS EN 13172: 2012 Thermal insulation products – Evaluation of conformity.
- BS EN ISO 9001 - Quality Management Systems (QMS). Certificate number: FM 02264.

Certification:

- BBA certified. Certificate Number: 14/5086.
- UKCA certified to BS EN 14064-1: 2010. Certificate Number: 0086 CPR 742703.
- CE marked to EN 14064-1: 2010. Certificate Number: 0402-CPR-SC0003-13.

A copy of the product Declaration of Performance (DoP) can be downloaded from the Superglass website.

Handling & Storage:

The product is supplied compression packed in polythene to provide short term protection only. For long term protection, the product must be stored indoors, or under a waterproof covering and off the ground to protect from weather damage. The product should not be left permanently exposed to the elements.

All Superglass products are non-hygroscopic, will not rot, degrade, or sustain vermin and will not encourage the growth of mould, bacteria, or fungi.



Intelligent Environments
Superglass

Superglass Insulation Limited. Thistle Industrial Estate, Kerse Road, Stirling, Scotland FK7 7QQ

Technical

Hotline: 0808 1645 134

Email: technical.stirling@etexgroup.com

Customer Services

Tel: 01786 451170

Email: customerservice.stirling@etexgroup.com

Social

www.facebook.com/superglassinsulationuk

www.linkedin.com/company/superglassuk/

www.twitter.com/Superglass_UK

All rights are reserved, including those of photomechanical reproduction and storage in electronic media. Commercial use of the processes and work activities presented in this document is not permitted. Extreme caution was observed when putting together the information, texts and illustrations in this document. Nevertheless, errors cannot quite be ruled out. The publisher and editors cannot assume legal responsibility or any liability whatever for incorrect information and the consequences thereof. The publisher and editors will be grateful for improvement suggestions and details of errors pointed out.

REF: SWC3401