

# Westerton Orange Multi

## Product Technical Information Sheet

Wienerberger Code	24240060
Production Plant	Todhills
Manufacture	Soft Mud Moulded Stock
Configuration	Frogged
Colour	Orange Multi
Appearance	Flat
Work Size (mm)	215 x 102.5 x 65
Pack Quantity	500 No.
Individual Dry Brick Weight (kg)	2.2



## Technical Properties to BS EN 771-1

Size Tolerance (Mean/Range)	T1/R1
Gross Dry Density (kg/m <sup>3</sup> /Tolerance)	1630 (D1)
Compressive Strength (N/mm <sup>2</sup> )	≥20
Thermal Conductivity (W/(m·K)) λ <sub>10,dry,unit</sub> value (EN 1745 tabulated: S1)	P=90% 0.60
Durability Designation	F2
Water Absorption (%)	≤14
Initial Rate of Water Absorption (kg/(m <sup>2</sup> ·min))	Min. 1.2 Max. 2.8
Active Soluble Salts	S2
Reaction to Fire	Class A1

### Issue Date: 15/09/2020

Technical data correct at time of issue. Individual dry brick weights can vary and are for guidance only. Any questions regarding this data should be referred to the Wienerberger Technical Department. Due to the limitations of screen and print colour representation of product images it is advised that brick samples are viewed prior to ordering.

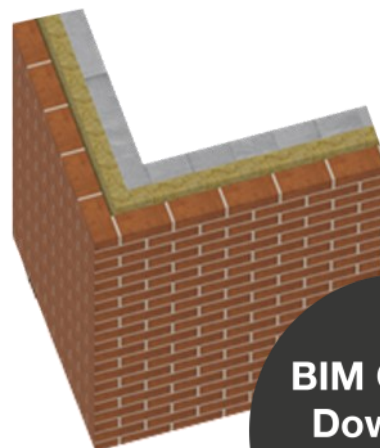

**BIM Objects  
Download**

