

GENERAL FITTING FOR OVER FASCIA VENTILATORS FITTED IN A VALLEY SITUATION

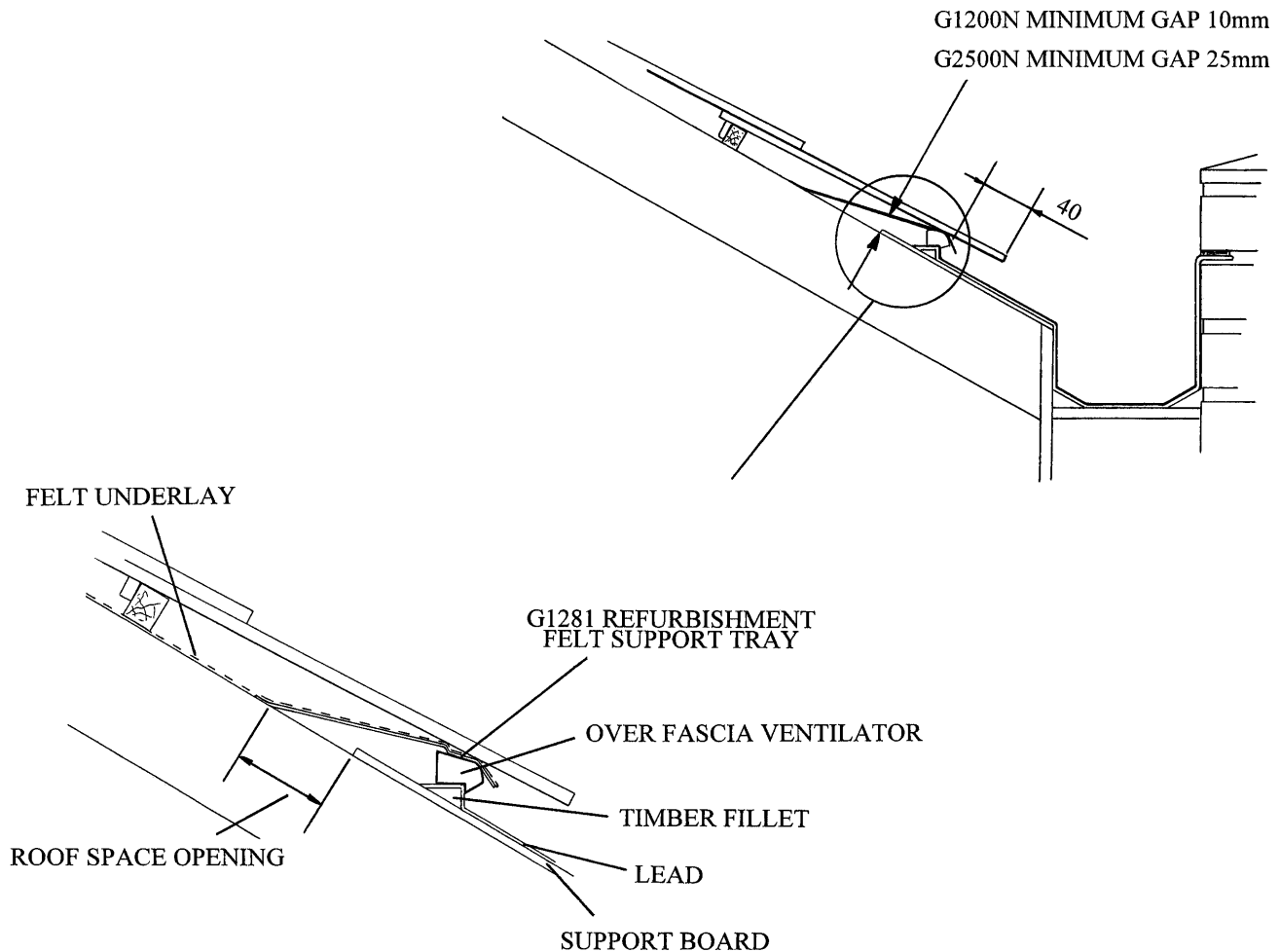

Description:

The G1200N and G2500N Over Fascia Ventilators can be fitted in a continuous run under tiles or slates when a parapet wall and valley detail is required to be ventilated to provide 10mm/M (G1200N) or 25mm/M (G2500N) of airflow into the roof space.

Note: - For More Detailed Information See Product Information Sheets: -

G1200N OVER FASCIA VENTILATOR - MBP 8010
 G2500N OVER FASCIA VENTILATOR - MBP 8011
 G1281 REFURBISHMENT FELT TRAY - MBP 8075

Fitting Instructions:

The Over Fascia Ventilators should be fitted as shown positioned 40mm under the front edge of the tile or slate on a timber fillet.

The G1281 Refurbishment Felt Support Tray should be positioned on top of the fascia vent and secured to the roof trusses as shown. Joints should be over lapped by a minimum of 150mm felt that should then be dressed over the tray as normal.

Note: - The G1281 Refurbishment Felt Support Tray may require trimming of the front edge to enable a clear air flow passage into the vent.

MANTHORPE BUILDING PRODUCTS LTD
 MANTHORPE HOUSE
 BRITAIN DRIVE
 CODNOR GATE BUSINESS PARK
 RIPLEY
 DERBYSHIRE DE5 3ND

TEL: 01773 303 000
 FAX: 01773 303 300
 EMAIL: mbp.care@manthorpebp.co.uk
 WEB: www.manthorpebp.co.uk

DRN M.A

Date: 24.06.19

DRG No

Issue

The company maintains a policy of continuous development of its product range and reserves the right to amend the specification without notice.

MBP 8146

B

GENERAL FITTING FOR OVER FASCIA VENTILATORS FITTED IN A CORBEL BRICK SITUATION

FELT UNDERLAY

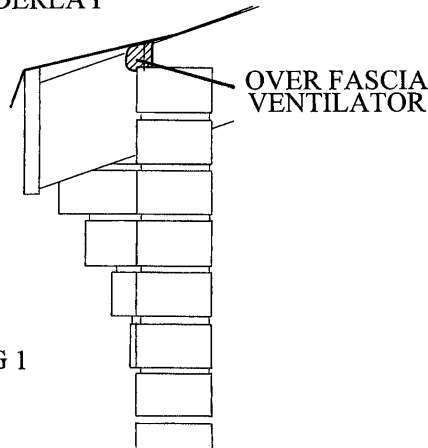
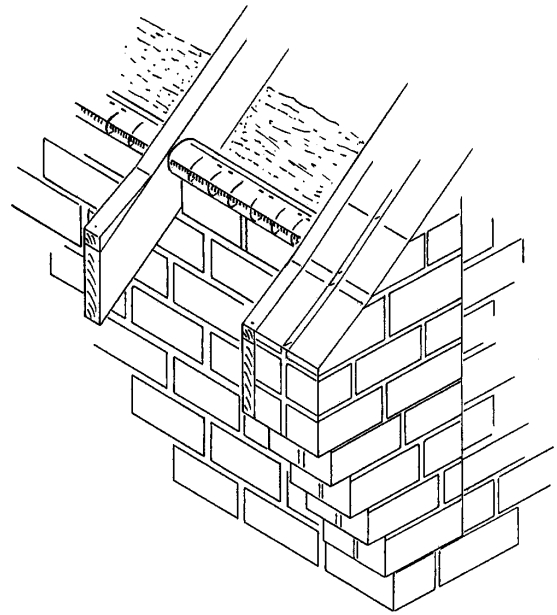

FIG 1



OVER FASCIA VENTILATOR

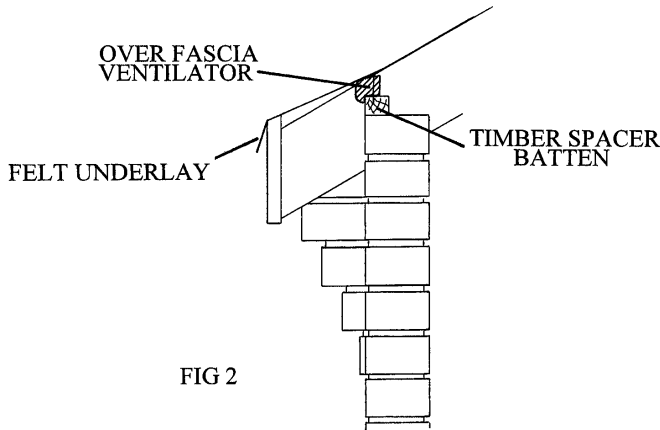

FIG 2

Description:

The G1200N and G2500N Over Fascia Ventilators can be fitted to the top of the brickwork when used in a corbel brickwork situation to provide 10mm²/M or 25mm²/M of airflow into the roof space.

Note: - For More Detailed Information See Product Information Sheets: -

G1200N OVER FASCIA VENTILATOR - MBP 8010
G2500N OVER FASCIA VENTILATOR - MBP 8011

Fitting Instructions:

The Over Fascia Ventilators (A) can be fixed in two ways.

- 1) Nailed directly to the brickwork by using masonry nails through the fixing holes provided and fitted tight up to the felt see (figure 1).
- 2) Fixed to a timber spacer batten fitted to the brickwork to push the Over Fascia Ventilator tight up against the felt see (figure 2).

Both over fascia ventilators can be easily cut to length using a fine toothed saw.

This product should be used in conjunction with other Manthorpe products to provide a complete roof ventilation system.

MANTHORPE BUILDING PRODUCTS LTD
MANTHORPE HOUSE
BRITAIN DRIVE
CODNOR GATE BUSINESS PARK
RIPLEY
DERBYSHIRE DE5 3ND

TEL: 01773 303 000
FAX: 01773 303 300
EMAIL: mbp.care@manthorpebp.co.uk
WEB: www.manthorpebp.co.uk

DRN M.A

Date: 24.06.19

DRG No

Issue

The company maintains a policy of continuous development of its product range and reserves the right to amend the specification without notice.

MBP 8145

B

OVER FASCIA VENTILATOR FITTED IN FLAT ROOF ABUTMENT DETAIL

CODE **G2500N**

Description:

The G2500N Over Fascia Ventilator can be fitted in flat roof abutment detail to give 25mm²/M of airflow when fitted as shown below.

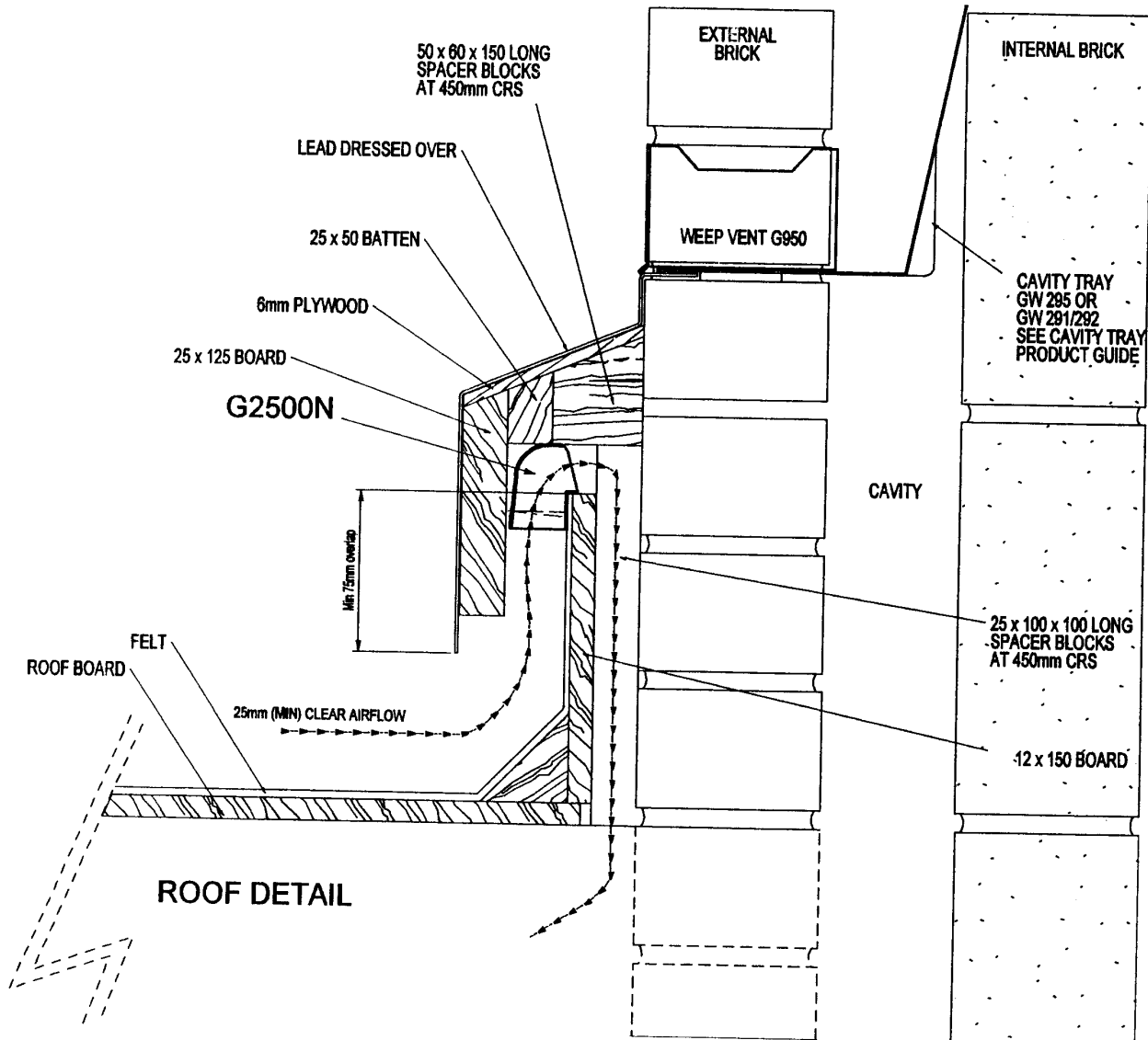

MANTHORPE BUILDING PRODUCTS LTD
 MANTHORPE HOUSE
 BRITAIN DRIVE
 CODNOR GATE BUSINESS PARK
 RIPLEY
 DERBYSHIRE DE5 3ND

TEL: 01773 303 000
 FAX: 01773 303 300
 EMAIL: mbp.care@manthorpebp.co.uk
 WEB: www.manthorpebp.co.uk

DRN M.A

Date 20.06.19

DRG No

MBP 8011

Issue

B

The company maintains a policy of continuous development of its product range and reserves the right to amend the specification without notice.

OVER FASCIA VENTILATOR FITTED IN MONO PITCH ROOF DEATIL

CODE **G1200N**

Description:

The G1200N Over Fascia Ventilator can be fitted in a mono roof abutment detail to give 10mm²/M of high level ventilation when fitted as shown below.

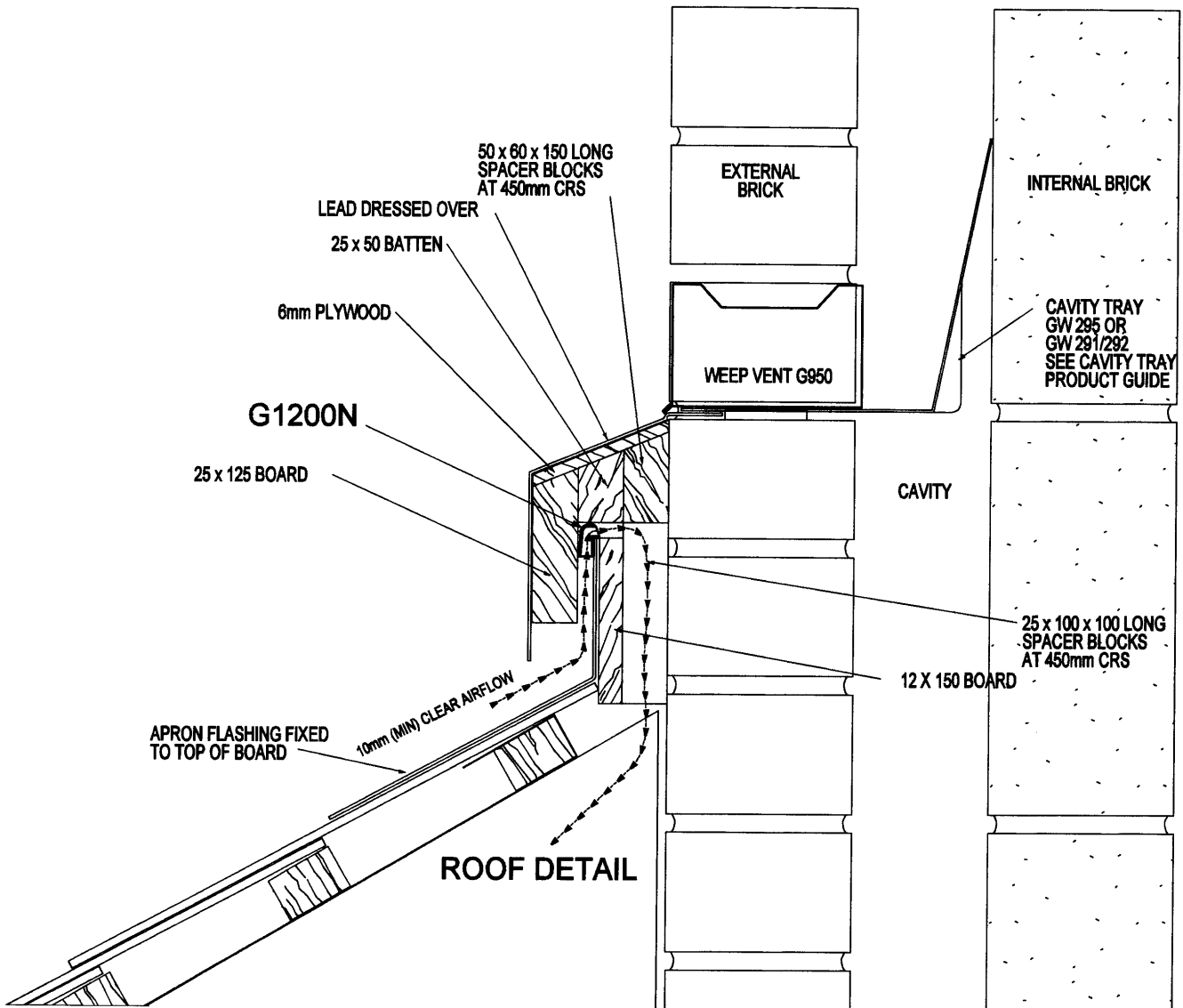

MANTHORPE BUILDING PRODUCTS LTD
 MANTHORPE HOUSE
 BRITAIN DRIVE
 CODNOR GATE BUSINESS PARK
 RIPLEY
 DERBYSHIRE DE5 3ND

TEL: 01773 303 000
 FAX: 01773 303 300
 EMAIL: mbp.care@manthorpebp.co.uk
 WEB: www.manthorpebp.co.uk

DRN M.A

Date 20.06.19

DRG No

Issue

The company maintains a policy of continuous development of its product range and reserves the right to amend the specification without notice.

MBP 8010

B