

TYPICAL INSTALLATION DETAIL

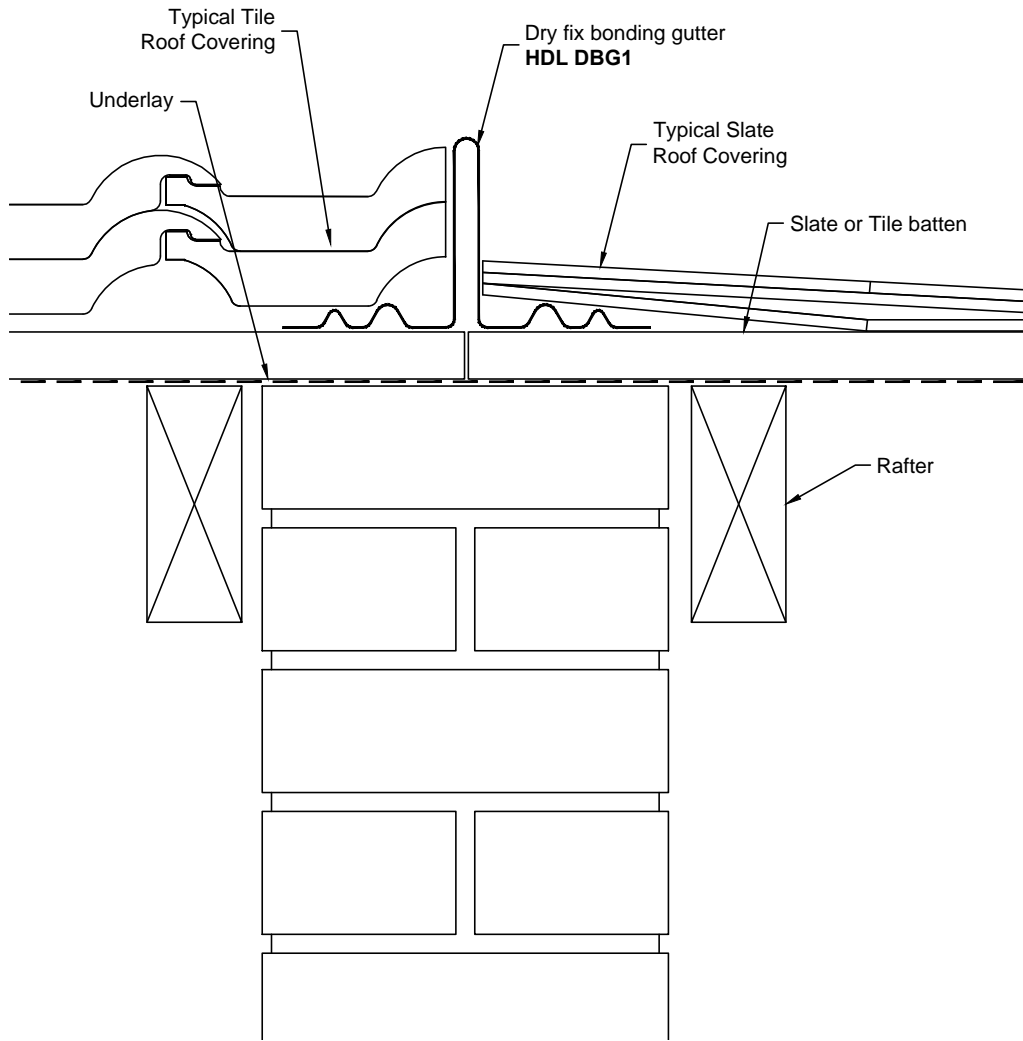

TYPICAL FIRE BREAK DETAIL

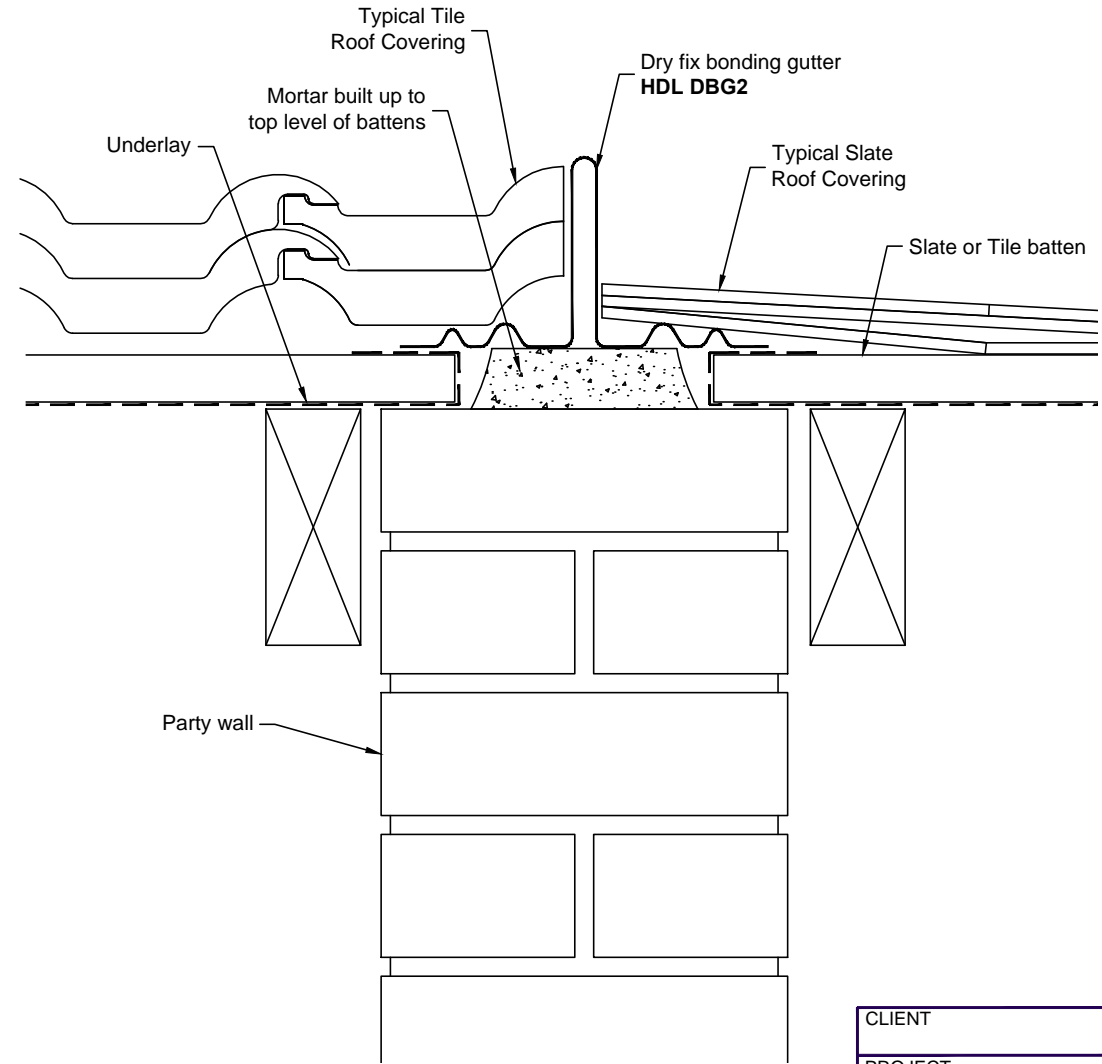

HDL DBG2

Is manufactured with a central upstand to suit profiled tiles on both sides and also typical scottish practice where there may be tiling battens on one side only.

Length: 3000mm
 Central Upstand Height: 100mm
 Width: 210mm

CLIENT	
PROJECT	
SCALE 1:4 @ A4	DATE 10.12.2015
DRAWING TITLE Dry Fix Bonding Gutter Typical Cross Section	
DRAWING NUMBER HDL DBG2	
HambleSide Danelaw Ltd	
T 01327 701900	
F 01327 701909	
W www.hambleSide-danelaw.co.uk	
A Long March, Daventry, NN11 4NR	

TYPICAL SCOTTISH INSTALLATION DETAIL

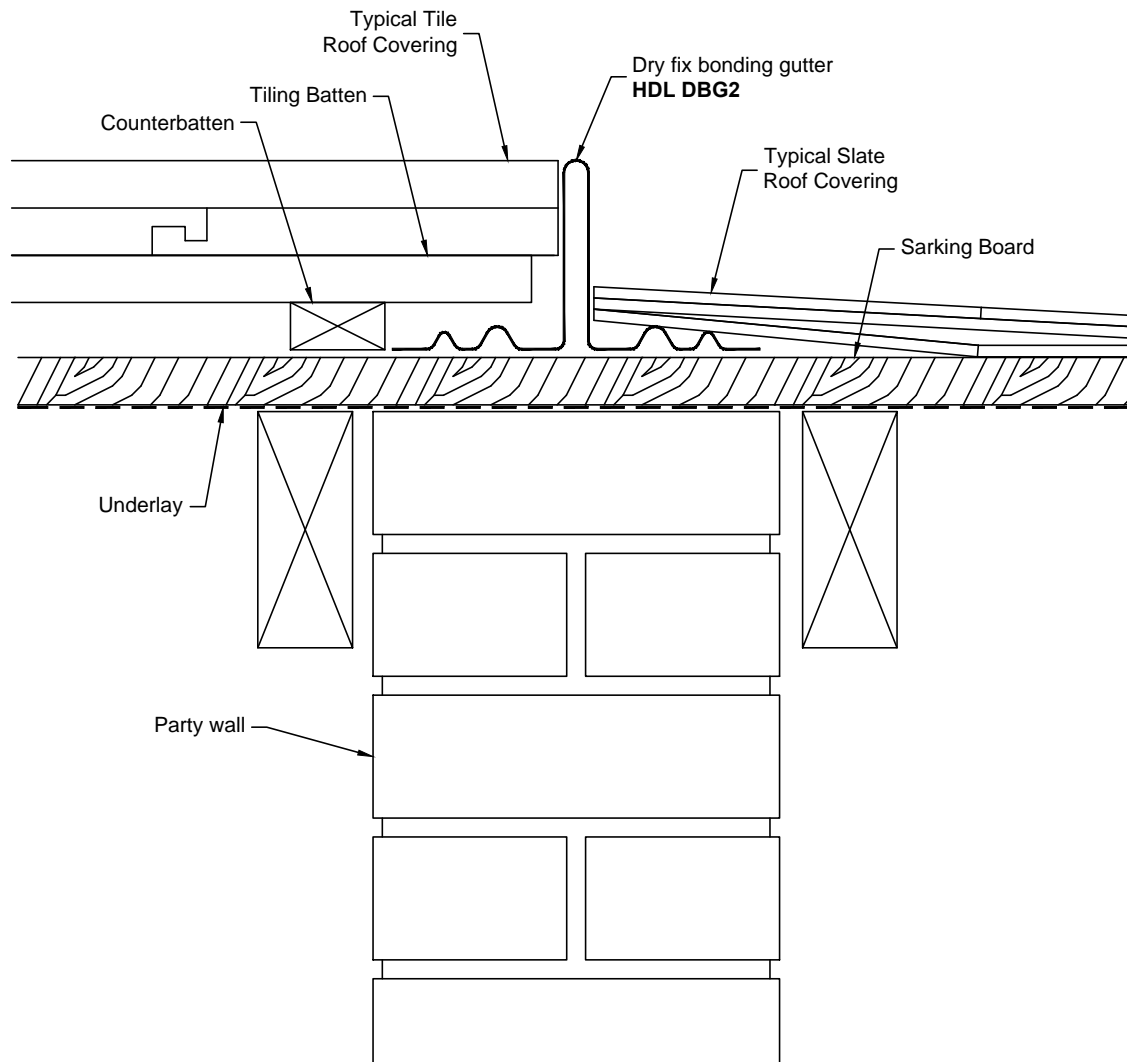

HDL DBG2

Is manufactured with a central upstand to suit profiled tiles on both sides and also typical scottish practice where there may be tiling battens on one side only.

Length: 3000mm
 Central Upstand Height: 100mm
 Width: 210mm

CLIENT	
PROJECT	
SCALE 1:4 @ A4	DATE 10.12.2015
DRAWING TITLE Dry Fix Bonding Gutter Typical Cross Section	
DRAWING NUMBER HDL DBG2	
HambleSide Danelaw Ltd	
T 01327 701900 F 01327 701909 W www.hambleSide-danelaw.co.uk A Long March, Daventry, NN11 4NR	



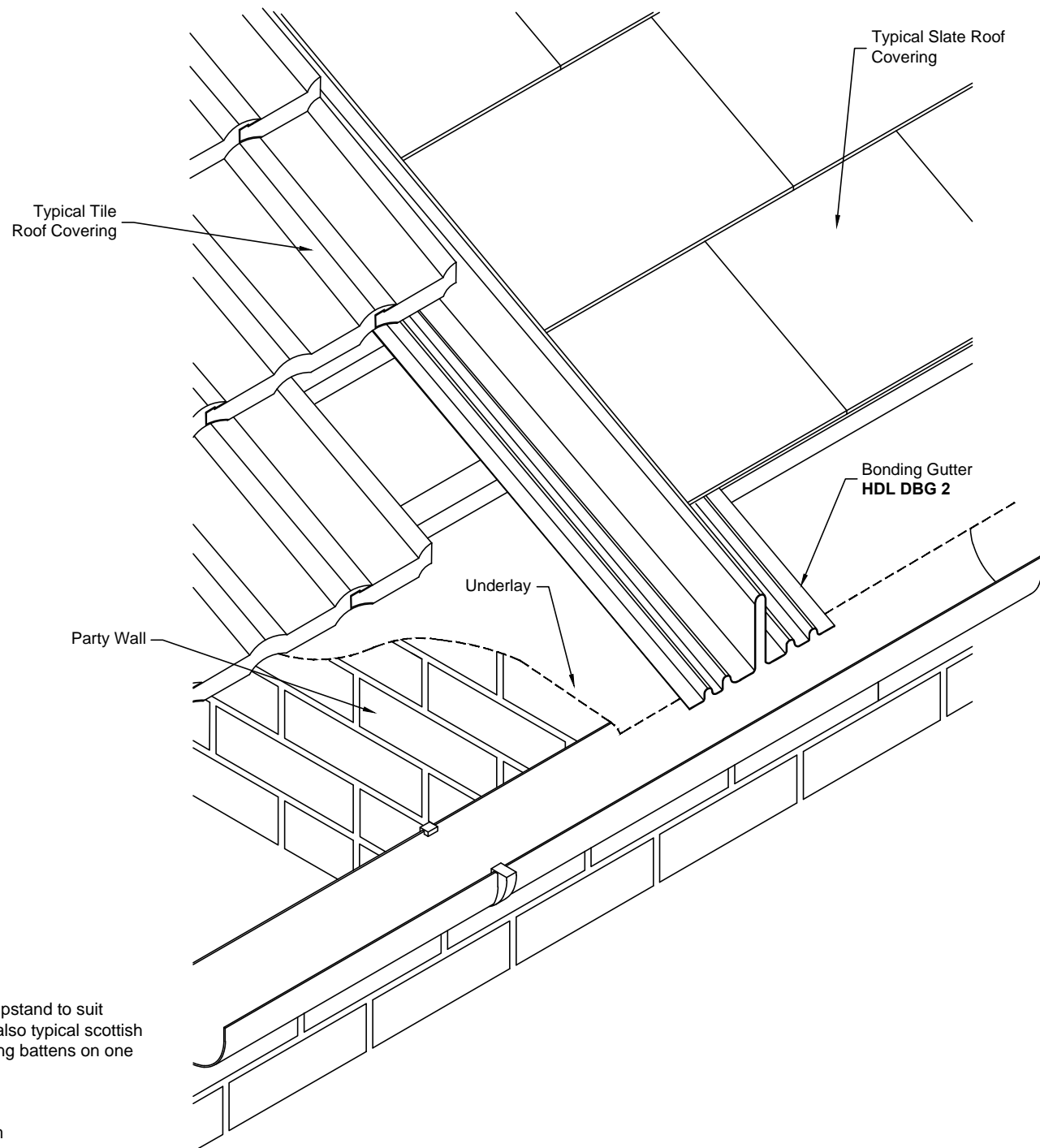

HDL DBG2

Is manufactured with a central upstand to suit profiled tiles on both sides and also typical scottish practice where there may be tiling battens on one side only.

Length: 3000mm
 Central Upstand Height: 100mm
 Width: 210mm

CLIENT	
PROJECT	
SCALE NTS	DATE 10.12.2015
DRAWING TITLE Dry Fix Bonding Gutter Typical Fixing Illustration	
DRAWING NUMBER HDL DBG2	
HambleSide Danelaw Ltd	
T 01327 701900	
F 01327 701909	
W www.hambleSide-danelaw.co.uk	
A Long March, Daventry, NN11 4NR	

