

Air Flow Solutions



Residential Fans

Ventilation for the home



RESIDENTIAL FANS



HEAT RECOVERY



INDUSTRIAL FANS



ACCESSORIES

Residential Fans

Why Ventilate?

AIRFLOW fans meet/exceed the requirements of the latest Building Regulations helping to combat the harmful effects of dampness and condensation and by extracting airborne pollutants such as odours, cooking smells,

humid and stale air. The potential hazards to health for occupants and possible damage to the fabric of the building can be largely eliminated.

Short key Functions



SWITCHING

Fan operates by remote switch

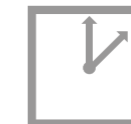

TIMER

Adjustable timer overrun



PULLCORD

Manual on/off control by integral pull cord



MOTION SENSOR

Passive infra red activation



CONTINUOUS VENTILATION

Continuous ventilation at trickle speeds



2 MINS

Delay start for 2 minutes



TWO SPEED

Two speed operation



SELV

Safety Extra Low Voltage



HUMIDITY

Adjustable humidity setting

Aura eco 100

Toilet, en-suite and bathroom ventilation



Key Features

- Axial fan
- Ventilation up to 54 m³/hr
- Slim compact styling
- Quick and easy to fit
- Quiet - 29 dB(A)
- Low watt motor - 6w
- Low SFP - 0.36 W/l/s
- Compatible with 100mm ducting
- IPX4 rating
- 3 year warranty

Aura eco 100

Highly reliable, low energy fan in a modular design for ease of installation and maintenance. The Aura eco 100 is designed to provide quiet extraction in a suitable application.

The fan comes in various control options and is recessed into the wall. The Aura range of fans are slim, compact, attractively styled, are easy to wipe clean and are ideal for through the wall installations.



Models

Basic	Control by Remote Switch
Timer	Timer can be set to run on between 2 and 30 minutes
Humidity Timer	Humidity sensor can be set between 60 - 90% RH
Motion Sensor Timer	PIR sensor activates fan



Technical Data

Specification	Aura eco 100B	Aura eco 100T	Aura eco 100HT	Aura eco 100MST
Air flow m³/hr / l/sec	54 / 15	54 / 15	54 / 15	54 / 15
Fan type	Axial	Axial	Axial	Axial
Controls	Basic	Timer	Humidity Timer	Motion Sensor Timer
Mounting	Wall / Ceiling	Wall / Ceiling	Wall / Ceiling	Wall / Ceiling
Sound pressure dB(A)@3m	29	29	29	29
Power watts	6	6	6	6
Amps	0.14	0.14	0.14	0.14
Specific Fan Power (SFP)	0.40	0.40	0.40	0.40
Duct diameter (mm)	100	100	100	100
Voltage	230v / 1ph / 50-60Hz	230v / 1ph / 50-60Hz	230v / 1ph / 50-60Hz	230v / 1ph / 50-60Hz
Rating	IPX4	IPX4	IPX4	IPX4
Material finish	Plastic	Plastic	Plastic	Plastic
Weight (kg)	0.56	0.56	0.56	0.56
Dimensions (H x W x D) mm	150 x 150 x 102	150 x 150 x 102	150 x 150 x 102	150 x 150 x 102
Part No.	9041347	9041348	9041349	9041350

Dimensions (mm)

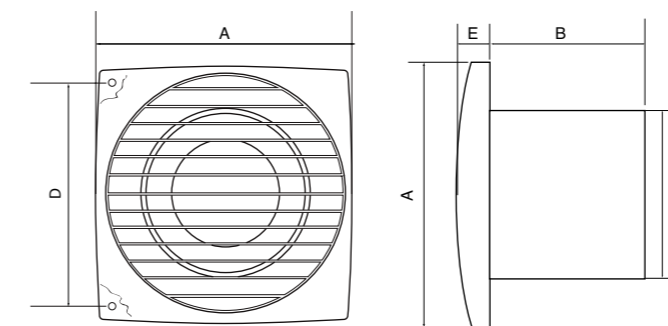

Model	A	B	C	D	E
Aura eco 100	150	102	100	122	17

Performance

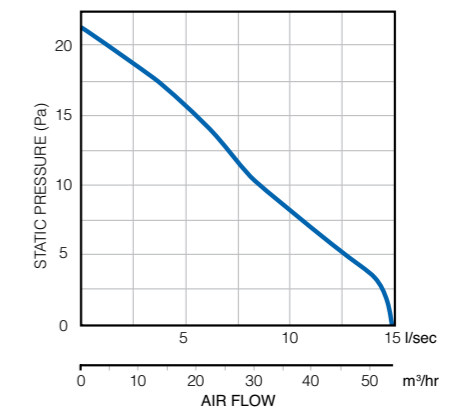

Controls and Accessories

A range of accessories including flexible and rigid ducting kits, controls and grilles are available.

Aura eco 150

Larger bathroom, utility room and kitchen ventilation (adjacent to hob)

Key Features



- Axial fan
- Ventilation up to 196 m³/hr
- Slim compact styling
- Quick and easy to fit
- Quiet - 35 dB(A)
- Low watt motor - 20w
- Low SFP - 0.3 W/l/s
- Compatible with 150mm ducting
- IPX4 rating
- 3 year warranty



Aura eco 150 range

Highly reliable, low energy fan in a modular design for ease of installation and maintenance. The Aura eco 150 is designed to provide quiet extraction in a suitable application.

The fan comes in various control options and is recessed into the wall or ceiling. The Aura range of fans are slim, compact, attractively styled, are easy to wipe clean and can be ducted over short lengths.



Models

Basic	Control by Remote Switch
Timer	Timer can be set to run on between 2 and 30 minutes
Humidity Timer	Humidity sensor can be set between 60 - 90% RH
Motion Sensor Timer	PIR sensor activates the fan



Technical Data

Specification	Aura eco 150B	Aura eco 150T	Aura eco 150HT	Aura eco 150MST
Air flow m ³ /hr / l/sec	196 / 54	196 / 54	196 / 54	196 / 54
Fan type	Axial	Axial	Axial	Axial
Controls	Basic	Timer	Humidity Timer	Motion Sensor Timer
Mounting	Wall / Ceiling	Wall / Ceiling	Wall / Ceiling	Wall / Ceiling
Sound pressure dB(A)@3m	35	35	35	35
Power watts	20	20	20	20
Amps	0.14	0.14	0.14	0.14
Specific Fan Power (SFP)	0.36	0.36	0.36	0.36
Duct diameter (mm)	150	150	150	150
Voltage	230v / 1ph / 50-60Hz	230v / 1ph / 50-60Hz	230v / 1ph / 50-60Hz	230v / 1ph / 50-60Hz
Rating	IPX4	IPX4	IPX4	IPX4
Material finish	Plastic	Plastic	Plastic	Plastic
Weight (kg)	0.9	0.9	0.9	0.9
Dimensions (H x W x D) mm	205 x 205 x 124	205 x 205 x 124	205 x 205 x 124	205 x 205 x 124
Part No.	9041351	9041352	9041353	9041354

Dimensions (mm)

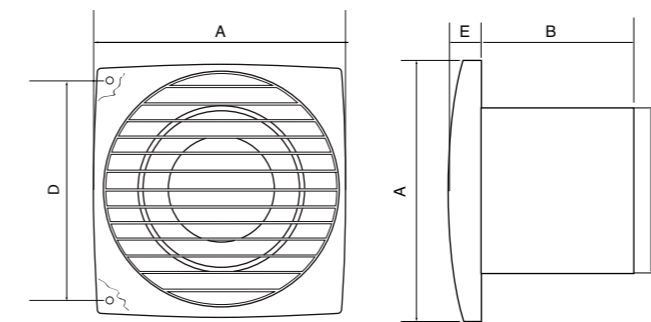

Model	A	B	C	D	E
Aura eco 150	205	124	150	174	19

Performance

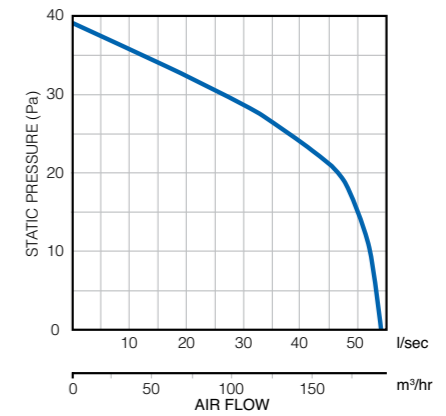

Controls and Accessories

A range of accessories including flexible and rigid ducting kits, controls and grilles are available.

Aura In-Line

Toilet, en-suite and bathroom ventilation



Key Features

- Axial in-line fan
- Ventilation up to 108 m³/hr
- Designed for ventilation of small and medium size rooms
- Use for both supply or extraction
- Compact and quiet in operation
- Mounting bracket included
- Ductable
- IPX4 rating
- 3 year warranty

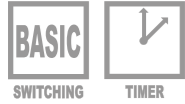

Aura In-Line range

Highly reliable fan in a modular design for ease of installation and maintenance. Aura In-Line Fans are designed to provide extraction levels that comply with the latest Building Regulations.

The fans are manually operated by a remote switch (switch not supplied). Timer control versions are also available. Install in-line with ducting for a quiet and discreet installation.

The Aura in-line fan comes with a fixing bracket and is compact, attractively styled and ductable over short lengths. They are the ideal solution for removing damp moist air, odours and airborne pollutants from toilets and bathrooms.



ALWAYS PULL FLEXIBLE DUCTING TAUGHT TO ENSURE INSTALLED PERFORMANCE AIR FLOW.



Models

- Basic** Control by Remote Switch
- Timer** Timer can be set to run on between 2 and 30 minutes

Technical Data

Specification	Aura In-Line 100B	Aura In-Line 100T
Air flow m ³ /hr* / l/sec*	108 / 30	108 / 30
Fan type	Axial	Axial
Controls	Basic	Timer
Mounting	In-Line	In-Line
Sound pressure dB(A)@3m	39	39
Power watts	16	16
Amps	0.01	0.01
Specific Fan Power (SFP)	0.53	0.53
Duct diameter (mm)	100	100
Voltage	230v / 1ph / 50Hz	230v / 1ph / 50Hz
Rating	IPX4	IPX4
Material finish	ABS	ABS
Weight (kg)	0.41	0.41
Dimensions (H x W x D) mm	110 x 160 x 113	110 x 160 x 113
Part No.	9041355	9041356

* Air flow at free discharge



Dimensions (mm)

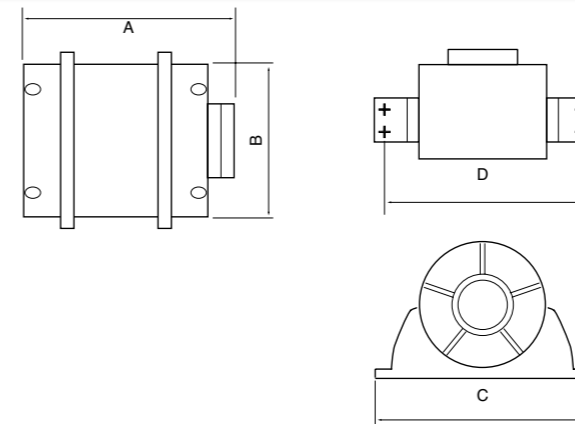

Model	A	B	C	D
Aura in-line 100	110	113	160	144

Performance

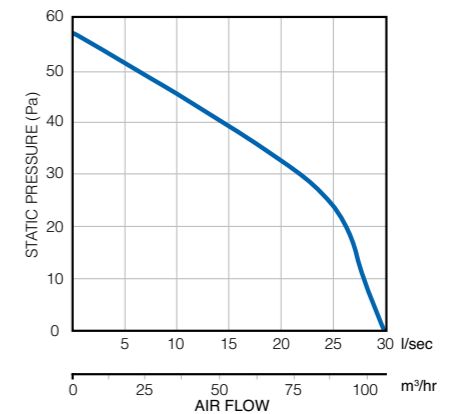

Controls and Accessories

A range of accessories including flexible and rigid ducting kits, controls and grilles are available. See accessories section from page 205 for more details.

Aura Shower Kit

Shower ventilation

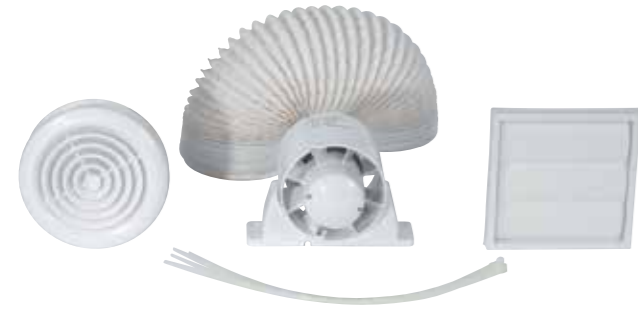

Key Features

- Axial in-line fan
- Ventilation up to 108 m³/hr
- Designed for ventilation / lighting above shower cubicles
- Use for both supply or extraction
- Compact and quiet in operation
- Mounting bracket included
- Ductable
- Halogen lamp option
- IPX4 rating
- 3 year warranty

Aura Shower Kit range

Highly reliable fan in a modular design for ease of installation and maintenance. Aura In-Line Fans are designed to provide extraction levels that comply with the latest Building Regulations.

The fans are manually operated by a remote switch (switch not supplied). Timer control versions are also available. Install in-line with ducting for a quiet and discreet installation.

The Aura in-line fan comes with a fixing bracket and is compact, attractively styled and ductable over short lengths. They are the ideal solution for removing damp moist air, odours and airborne pollutants from toilets and bathrooms.



ALWAYS PULL FLEXIBLE DUCTING TAUGHT TO ENSURE INSTALLED PERFORMANCE AIR FLOW.



Models

- Basic** Control by Remote Switch
- Timer** Timer can be set to run on between 2 and 30 minutes

Contents of Kits

- 9041420** Aura 100B, 3m flex duct, ties, extract valve, external grille
- 9041419** Aura 100T, 3m flex duct, ties, extract valve, external grille
- 9041422** Aura 100B, 3m flex duct, ties, halogen lamp + chrome and white grilles, external grille
- 9041421** Aura 100T, 3m flex duct, ties, halogen lamp + chrome and white grilles, external grille



Technical Data

Specification	Aura Shower Kit	Aura T Shower Kit	Aura Shower Kit with Hallogen Lamp	Aura T Shower Kit with Hallogen Lamp
Air flow m³/hr* / l/sec*	108 / 30	108 / 30	108 / 30	108 / 30
Fan type	Axial	Axial	Axial	Axial
Controls	Basic	Timer (adjustable)	Basic	Timer (adjustable)
Mounting	In-Line	In-Line	In-Line	In-Line
Sound pressure dB(A)@3m	39	39	39	39
Power watts	16	16	16	16
Amps	0.01	0.01	0.01	0.01
Specific Fan Power (SFP)	0.53	0.53	0.53	0.53
Duct diameter (mm)	100	100	100	100
Voltage	230v / 1ph / 50Hz	230v / 1ph / 50Hz	230v / 1ph / 50Hz	230v / 1ph / 50Hz
Rating	IPX4	IPX4	IPX4	IPX4
Material finish	ABS	ABS	ABS	ABS
Weight (kg)	0.41	0.41	0.41	0.41
Dimensions (H x W x D) mm	110 x 160 x 113	110 x 160 x 113	110 x 160 x 113	110 x 160 x 113
Part No.	9041420	9041419	9041422	9041421

* Air flow at free discharge

Dimensions (mm)

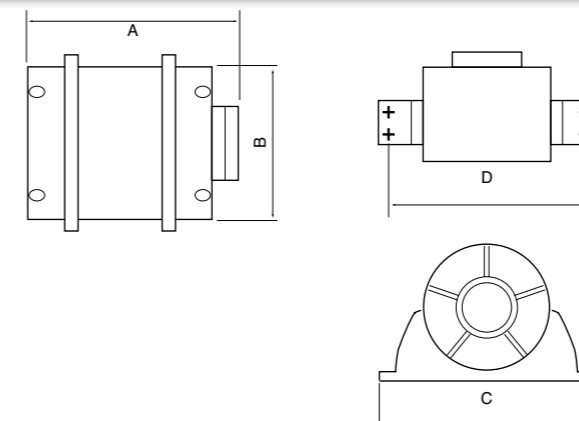

Model	A	B	C	D
Aura shower kit	110	113	160	144

Performance

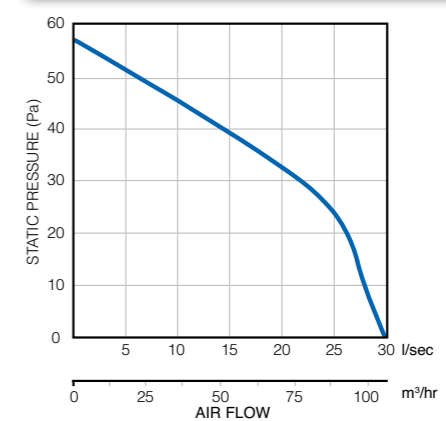

Controls and Accessories

A range of accessories including flexible and rigid ducting kits, controls and grilles are available.

Aura Smart

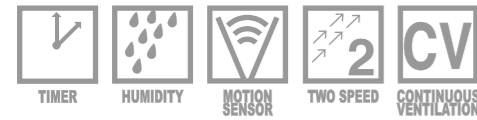

Key Features

- Two speed axial fan
- Flow rate up to 133 m³/hr
- Interchangeable spigots - 100/125mm
- Modern compact styling - optional front covers to match décor
- Quick and easy to fit
- Versatile positioning - portrait or landscape
- Exceptionally quiet - 21 dB(A)
- Energy efficient low watt motor - 3.8W
- Advanced controls for ultimate user comfort
- Universal voltage 100/240v - 50/60Hz
- IP44 rating
- Complies with Building Regulations
- 5 year warranty

Aura Smart

The Aura Smart is an innovative low energy axial fan with a unique design for ease of installation and maintenance. The fan is extra slim and with optional colour covers available, it will blend perfectly into the décor of any room. The fan is suitable for mounting anywhere outside of Zone 2 of your wetroom.

The fan comes with interchangeable spigots giving the user the option to use 100mm or 125mm ducting and increase the flow rate accordingly.

This smart fan is available with either humidity timer control or motion sensor humidity timer control giving the user the benefit of achieving the perfect micro climate within their home. Aura Smart has a one-touch control panel beneath the cover for control of the fan. A separate remote controller is also included for convenient control of all the functions – it's a Smart Fan!

Interval ventilation occurs automatically every 15 hours for a period of 2 hours - this ensures regular movement of the air and keeps the room fresh.



Models

Humidity Timer Humidity sensor activates fan - if humidity rises by less than 20% within 10 minutes, run on time reverts to 15 minutes instead of the preset rates of 30, 45 or 60 minutes.

Motion Sensor Humidity Timer PIR sensor activates fan to switch on - overrun timer kicks in - can be set at 5, 15 or 30 minutes. If humidity sensor activates the fan – run on time, to clear humidity can be set at 30, 45 or 60 minutes. If the humidity rises by less than 20% in 10 minutes the overrun time will revert to 15 minutes.



Technical Data

Specification	Aura Smart HT		Aura Smart MSHT		Covers		
	100mm	125mm	100mm	125mm	HT	Colour	MSHT
Spigot size	100mm	125mm	100mm	125mm	90000386	Marble	90000416
Air flow m ³ /hr*	72 / 106	83 / 133	72 / 106	83 / 133	90000387	Silver	90000417
Air flow l/sec*	20 / 29	23 / 37	20 / 29	23 / 37	90000388	Champagne	90000418
Fan type	Axial		Axial		90000389	Red	90000419
Controls	Humidity Timer		Motion Sensor Humidity Timer		90000390	Mauve	90000420
Mounting	Wall		Wall		90000391	Graphite	90000421
Sound pressure dB(A)@3m	22 / 31	21 / 32	22 / 31	21 / 32	90000392	Black	90000422
Adjustable delay start (min)	0, 2, 5		0, 2, 5				
Adjustable timer (min)	5, 15, 30		5, 15, 30				
Adjustable timer on humidity activation (min)	30, 45, 60		30, 45, 60				
Interval timer, auto start (hrs)	15		15				
Power watts	Up to 3.8		Up to 3.8				
Specific Fan Power (SFP)	0.13	0.1	0.13	0.1			
Building Regulations ADF	Yes		Yes				
Voltage	100-240V/50-60Hz		100-240V/50-60Hz				
Rating	IP44		IP44				
Weight (Kg)	0.63		0.63				
Dimensions (H x W x D)mm	206x152x86		206x152x86				
Part No.	90000384		90000385				



* Air flow at free discharge

Dimensions (mm)

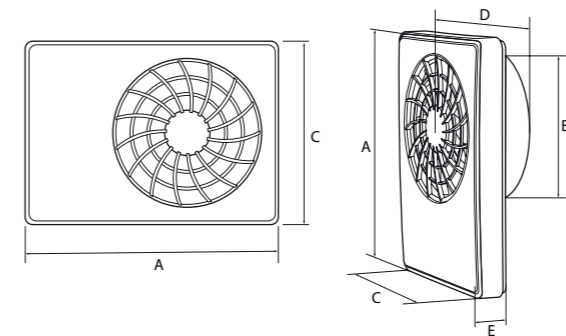

Model	A	B	C	D	E
Aura Smart	206	100/125	152	57	29

Performance

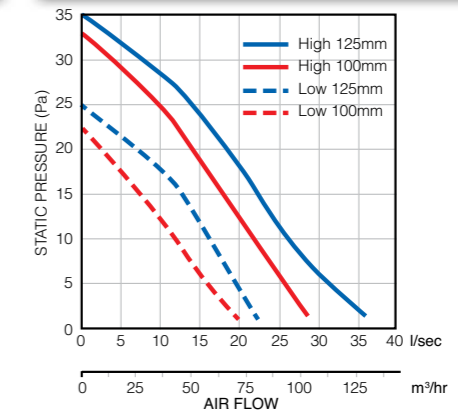

Controls and Accessories

A range of accessories including flexible and rigid ducting kits, controls and grilles are available.

QuietAir QT100

Toilet, bathroom and en-suite ventilation



Key Features

- Axial fan
- Two speed ventilation up to 90 m³/hr*
- Awarded Quiet Mark 2014 by Noise Abatement Society
- Extremely quiet, noise levels as low as 25 dB(A)
- Power consumption from only 5w
- Interval timer for routine auto extraction
- Very low SFP of 0.24 W/l/s
- Long life ball-bearing motor 40,000 hours
- Integral flow straightener / backdraught flap
- Powerful extraction for longer ducts
- Suitable for installation anywhere in Zone 1 of bathrooms when installed with an RCD
- IP45 rating
- Complies with Building Regulations
- 3 year warranty



QT100 range

The whisper quiet QuietAir QT100 is designed to provide powerful extraction levels that exceed the requirements of the latest Building Regulations.

The QuietAir QT100 is the quietest fan available complying with Building Regulations "Installed Performance" requirements when ducted.

QuietAir is a range of elegant, discreet axial fans that are extremely quiet with various control options that activate the fan only when needed – remote switching,

timer, humidity timer and motion sensor with timer. By using exceptionally low energy this helps to reduce carbon emissions and also save on your energy bills. It has a high efficiency impeller for extraction through up to 12m of rigid ducting with up to 10 x 90° bends and still complies with the Building Regulations.

Room refresh (interval timer) enables automatic extraction at pre-set times if required.



Models

Basic	Control by remote switch
Timer	Timer can be set to run on for 6,10,15 or 21 minutes
Humidity Timer	Humidity sensor can be set between 60 - 90% RH
Motion Sensor Timer	PIR sensor activates fan



Technical Data

Specification	QuietAir QT100B	QuietAir QT100T	QuietAir QT100HT	QuietAir QT100MST
Air flow m ³ /hr*	75 / 90	75 / 90	75 / 90	75 / 90
Air flow l/sec*	21 / 25	21 / 25	21 / 25	21 / 25
Fan type	Axial	Axial	Axial	Axial
Controls	Basic	Timer	Humidity Timer	Motion Sensor Timer
Mounting	Wall / Ceiling	Wall / Ceiling	Wall / Ceiling	Wall / Ceiling
Sound pressure dB(A)@3m	25/30	25/30	25/30	25/30
Delay start (min)	No	2	2	No
Adjustable timer (min)	No	6,10,15,21	6,10,15,21	15
Adjustable humidity (%RH)			60 - 90	
Interval timer, auto start (hrs)		0,8,12,24		
Power watts	5/9	5/9	5/9	5/9
Amps	0.06/0.04	0.06/0.04	0.06/0.04	0.06/0.04
Specific Fan Power (SFP)	0.24	0.24	0.24	0.24
Building Regulations ADF	Yes	Yes	Yes	Yes
Duct Diameter (mm)	100	100	100	100
Voltage	230v / 1ph / 50-60Hz	230v / 1ph / 50-60Hz	230v / 1ph / 50-60Hz	230v / 1ph / 50-60Hz
Rating	IP45	IP45	IP45	IP45
Max ambient temperature	40°C	40°C	40°C	40°C
Weight (kg)	0.8	0.8	0.8	0.8
Dimensions (H x W x D) mm	147 x 147 x 96	147 x 147 x 96	147 x 147 x 96	147 x 147 x 96
Part No.	9041259	9041260	9041261	9041262

* 2nd Speed activated by remote switch

Dimensions (mm)

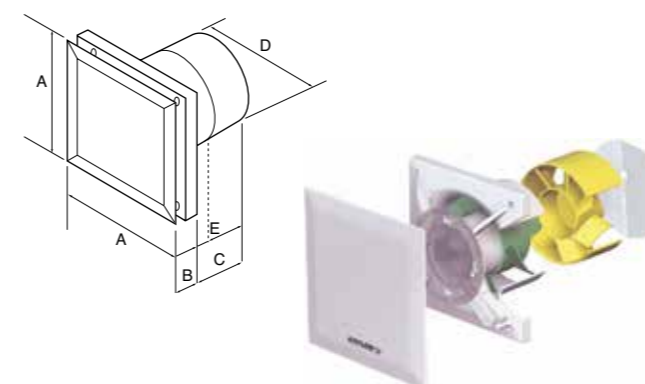

Model	A	B	C	D	E
QuietAir QT100	147	35	96	98	52

Performance

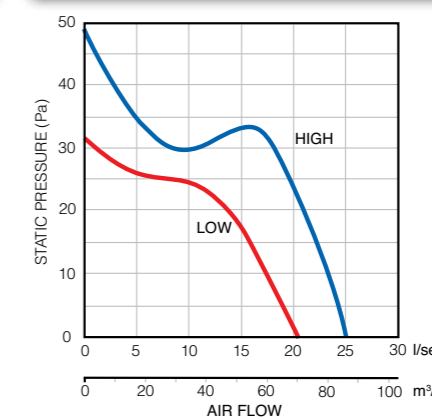

Controls and Accessories

A range of accessories including flexible and rigid ducting kits, controls and grilles are available.

See accessories section from page 205 for more details.

QuietAir QT120

Toilet, bathroom, utility room and kitchen (adjacent to hob)

Key Features



- Axial fan
- Two speed ventilation up to 170 m³/hr*
- Awarded Quiet Mark 2014 by Noise Abatement Society
- Quiet, noise level as low as 32 dB(A)
- Power consumption from only 10w
- Very low SFP of 0.24 W/l/s, IP45 rating
- Interval timer for routine auto extraction
- Long life ball-bearing motor 40,000 hours
- Integral flow straightener / backdraught flap
- Powerful extraction for longer ducts
- Suitable for installation anywhere in Zone 1 of bathrooms when installed with an RCD
- Install in a kitchen adjacent to the hob
- Complies with Building Regulations
- 3 year warranty



QT120 range

The powerful performance QuietAir 120 is designed to provide extraction levels that exceed the requirements of the latest Building Regulations.

QuietAir, is a range of elegant, discreet axial fans that are supremely quiet. By using exceptionally low energy they help to reduce carbon emissions but also save on your electricity bill.

Operated by a range of control options including basic switching, timer, humidity and motion sensor control.

Room refresh (interval timer) enables automatic extraction at pre-set times if required.



Models

Basic	Control by remote switch
Timer	Timer can be set to run on for 6,10,15 or 21 minutes
Humidity Timer	Humidity sensor can be set between 60 - 90% RH
Motion Sensor Timer	PIR sensor activates fan



Technical Data

Specification	QuietAir QT120B	QuietAir QT120T	QuietAir QT120HT	QuietAir QT120MST
Air flow m ³ /hr*	150 / 170	150 / 170	150 / 170	150 / 170
Air flow l/sec*	42 / 47	42 / 47	42 / 47	42 / 47
Fan type	Axial	Axial	Axial	Axial
Controls	Basic	Timer	Humidity Timer	Motion Sensor Timer
Mounting	Wall / Ceiling	Wall / Ceiling	Wall / Ceiling	Wall / Ceiling
Sound pressure dB(A)@3m	32/36	32/36	32/36	32/36
Delay start (min)	No	2	2	No
Adjustable timer (min)	No	6,10,15,21	6,10,15,21	15
Adjustable humidity (%RH)	-	-	60 - 90	-
Interval timer, auto start (hrs)	-	0,8,12,24	-	-
Power watts	10/13	10/13	10/13	10/13
Amps	0.09/0.08	0.09/0.08	0.09/0.08	0.09/0.08
Specific Fan Power (SFP)	0.24	0.24	0.24	0.24
Building Regulations ADF	Yes	Yes	Yes	Yes
Duct Diameter (mm)	120	120	120	120
Voltage	230v / 1ph / 50-60Hz	230v / 1ph / 50-60Hz	230v / 1ph / 50-60Hz	230v / 1ph / 50-60Hz
Rating	IP45	IP45	IP45	IP45
Max ambient temperature	40°C	40°C	40°C	40°C
Weight (kg)	1.05	1.05	1.05	1.05
Dimensions (H x W x D) mm	176 x 176 x 116	176 x 176 x 116	176 x 176 x 116	176 x 176 x 116
Part No.	9041497	9041498	9041499	9041500

* 2nd Speed activated by remote switch

Dimensions (mm)

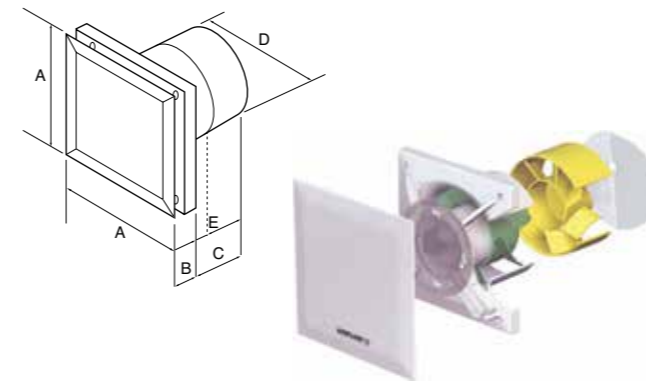

Model	A	B	C	D	E
QuietAir QT120	176	39	116	118	70

Performance

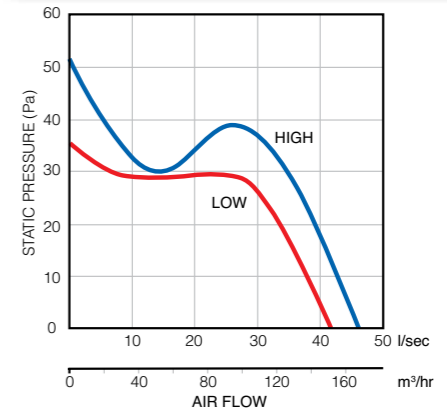

Controls and Accessories

A range of accessories including flexible and rigid ducting kits, controls and grilles are available.

QuietAir QT150

Kitchen



Key Features

- Axial fan
- Two speed ventilation up to 260 m³/hr
- Quiet, noise level as low as 35 dB(A)
- Power consumption from only 6w
- Very low SFP of 0.09 W/l/s, IP45 rating
- Interval timer for routine auto extraction
- Long life ball-bearing motor 40,000 hours
- Integral flow straightener / backdraught flap
- Powerful extraction for longer ducts
- Variable speed control version
- Install in a kitchen / light commercial
- Complies with Building Regulations
- 3 year warranty



QT150 range

The powerful performance QuietAir 150 is designed to provide extraction levels that exceed the requirements of the latest Building Regulations. Ideal for kitchens and larger rooms.

QuietAir, is a range of elegant, discreet axial fans that are supremely quiet. By using exceptionally low energy they help to reduce carbon emissions but also save on your electricity bill.

Operated by a range of control options including basic switching, timer, humidity and variable speed control.

Room refresh (interval timer) enables automatic extraction at pre-set times if required.



Models

Basic	Control by remote switch
Timer	Timer can be set to run on for 6,10,15 or 21 minutes
Humidity Timer	Humidity sensor can be set between 60 - 90% RH
Variable speed	Controlled by remote switch



Technical Data

Specification	QuietAir QT150B	QuietAir QT150T	QuietAir QT150HT	QuietAir QT150VS
Air flow m³/hr*	220 / 260	220 / 260	220 / 260	50 - 260
Air flow l/sec*	61 / 72	61 / 72	61 / 72	13 - 72
Fan type	Axial	Axial	Axial	Axial
Controls	Basic	Timer	Humidity Timer	Variable Speed
Mounting	Wall / Ceiling	Wall / Ceiling	Wall / Ceiling	Wall / Ceiling
Sound pressure dB(A)@3m	35/39	35/39	35/39	35/39
Delay start (sec's)	No	0,45,90,120	0,45,90,120	No
Adjustable timer 9mins)	No	6,10,15,21	6,10,15,21	No
Adjustable humidity (%RH)	-	-	60 - 90	-
Interval timer, auto start (hrs)	-	0,8,12,24	-	-
Power watts	6/10	6/10	6/10	6/10
Amps	0.12/0.07	0.12/0.07	0.12/0.07	0.12/0.07
Specific Fan Power (SFP)	0.09/0.13	0.09/0.13	0.09/0.13	0.09/0.13
Building Regulations ADF	Yes	Yes	Yes	Yes
Duct Diameter (mm)	145	145	145	145
Voltage	230v / 1ph / 50Hz	230v / 1ph / 50Hz	230v / 1ph / 50Hz	230v / 1ph / 50Hz
Rating	IP45	IP45	IP45	IP45
Max ambient temperature	40°C	40°C	40°C	40°C
Weight (kg)	1.2	1.2	1.2	1.2
Dimensions (H x W x D) mm	210 x 210 x 142	210 x 210 x 142	210 x 210 x 142	210 x 210 x 142
Part No.	90000454	90000455	90000456	90000458
Variable speed controller				9041569*

* refer to accessories section.

Dimensions (mm)

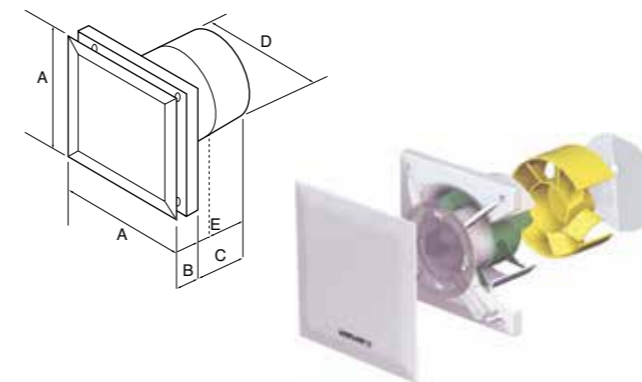

Model	A	B	C	D	E
QuietAir QT150	210	48	142	145	76

Performance

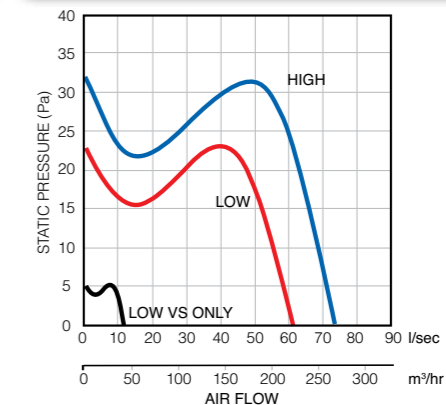

Controls and Accessories

A range of accessories including flexible and rigid ducting kits, controls and grilles are available.

Maxivent eco

Larger bathroom, utility room and kitchen



Key Features

- Axial fan
- High performance fan up to 260 m³/hr
- Easy to fit and clean
- Can be mounted in the wall or ceiling
- Interchangeable fixing holes to easily replace most other 150mm fans
- Variable speed controller available
- Thermally protected motor
- Low watt motor 28w
- Low SFP - 0.38 W/l/s
- Silent automatic shutter
- IP45 rating
- Complies with Building Regulations
- 3 year warranty



Maxivent eco range

Highly reliable and powerful axial fan in a modular design for ease of installation and maintenance. Maxivent is designed to provide extraction levels that comply with the latest Building Regulations.

Maxivent fans offer quiet powerful performance in units equipped with auto shutters. These stylish, modern 150mm axial fans will blend comfortably with existing décor and are quick and easy to install. They are the ideal solution for removing damp moist air, odours and airborne pollutants from kitchens and utility rooms.

Models

Pull Cord	Activated by pull cord
Timer	Timer can be set to run on between 1 and 30 minutes
Humidity Pull Cord	Humidity sensor can be set between 40 - 95% RH, override with pull cord



Technical Data

Specification	Maxivent eco P	Maxivent eco T	Maxivent eco H
Air flow m ³ /hr	260	260	158 / 260
Air flow l/sec	72	72	44 / 72
Fan type	Axial	Axial	Axial
Controls	Pull Cord	Timer	Humidity / Pull Cord
Mounting	Wall / Ceiling	Wall / Ceiling	Wall / Ceiling
Sound pressure dB(A)@3m	57	57	46/57
Power watts	28	28	28
Amps	2	2	2
SFP@72 l/sec	0.38	0.38	0.38
Building Regulations ADF	Yes	Yes	Yes
Duct diameter (mm)	150	150	150
Voltage	230v / 1ph / 50-60Hz	230v / 1ph / 50-60Hz	230v / 1ph / 50-60Hz
Rating	IP45	IP45	IP45
Weight (kg)	2.45	2.45	2.45
Dimensions (H x W x D) mm	225 x 225 x 105	225 x 225 x 105	225 x 225 x 105
Part No.	72678201	72678301	72678401
Variable speed controller		9041033*	

* refer to accessories section.

Dimensions (mm)

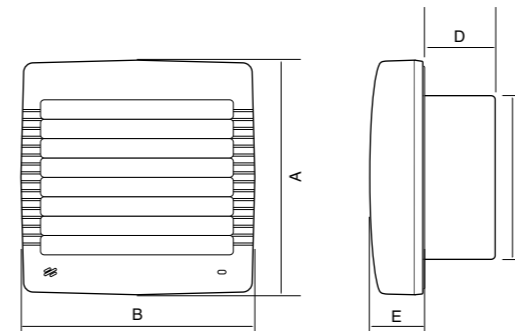

Model	A	B	C	D	E
Maxivent eco	225	225	150	60	45

Performance

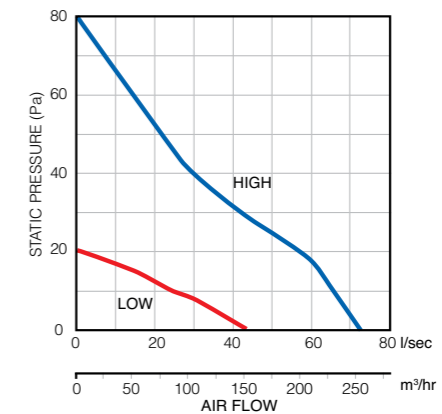

Controls and Accessories

A range of accessories including flexible and rigid ducting kits, controls and grilles are available.





Unique, elegant, efficient



"A revolution in fan design. You have never seen a fan like it or installed a fan like it either"



In 2004 Airflow introduced iCON. A radical new design which brought style, colour and a new level of functionality to the bland world of boxy extractor fans.

The changes were not just cosmetic, but the results of a complete rethink of the way in which fans are designed, specified, sold and installed.

Today, as we introduce the next generation of energy saving iCON, these award winning fans remain the market leader for simplicity and style with its unique, interchangeable module concept continuing to save time and money for distributors and installers alike.

iCON® 15

iCON 15 is ideal for toilets, en-suite, shower rooms and bathrooms. Recessed into the wall or ceiling, it is stylish and unobtrusive, even in the smallest space.

iCON® 30

iCON 30 is quiet, powerful and designed for recessed or surface mounting in walls or ceilings in larger toilets, bathrooms and utility rooms.

iCON® 60

iCON 60 is the largest fan in the range, suitable for recessed or surface mounting in walls or ceilings and is highly efficient in domestic kitchens, changing areas and residents' lounges.



Chrome



Anthracite



Silver



Sandstone



Its looks aren't everything

Installation

iCON has been designed with simplicity in mind. A quick, core drilled hole enables immediate fixing of iCON. The twist on/off cover requires only a single side entry fixing screw.



Cantilever fixing lugs enable recessed installation on uneven surfaces. iCON 30 and iCON 60 are also supplied with a narrow contour skirt for surface mounting if preferred.



The 'snap-in' module is quick to fit and wire, giving the installer a choice of controls on-site.



Modular versatility and simplicity. Select the fan, iCON 15, iCON 30, iCON 60 and add the module. Any module fits any fan.*

*subject to voltage

- Simple twist on/off cover mechanism
- Cantilever lugs to facilitate uneven surfaces
- 'Snap-in' interchangeable module, quick to fit and wire
- Fit the control module required for the particular job

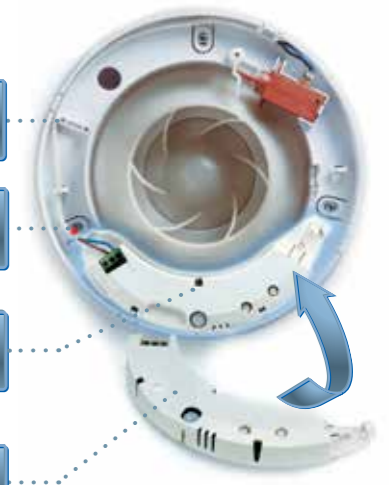

Wholesalers and Installers save too!

Designed with the busy contractor in mind with modular design and maximum fan choice, you save time and make more money. Just carry three basic fans and a range of inexpensive fan control modules to install fans quickly and move faster from site to site.

- Go from site to site
- Just carry three basic fans and a choice of control modules
- All modules fit all fans.*
- Reduce trips to the wholesaler for site-specific fans.

*subject to Voltage



Minimal stock and maximum choice equals more profit

Wholesalers only need to stock three basic fans and offer a range of control modules to...

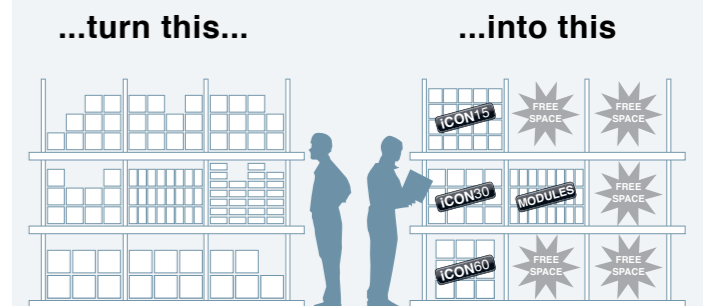

STOP using up valuable shelving space with boxes for every type of fan.

SAVE up to half your valuable shelving space by stocking three basic fans and a range of popular control modules.

iCON 15

Stylish toilet and bathroom ventilation



Key Features

- Axial fan
- Flow rate up to 68 m³/hr
- Stylish, slim and unobtrusive in walls or ceilings
- Low SFP 0.49 W/l/s
- Different colour covers available
- Unique iris shutter, prevents backdraughts, operates silently
- Interchangeable control modules match fan to installation requirements
- IPX4 rating
- Complies with Building Regulations
- 3 year warranty



iCON 15

iCON 15 is ideal for toilets, en-suites, shower rooms and bathrooms. Recessed into the wall or ceiling, it is stylish and unobtrusive, even in the smallest of spaces. The circular design means no squaring up is required, adding to the already simple installation procedure.

iCON 15 is designed to provide ventilation levels that comply with the latest Building Regulations. The iCON fan is an efficient, stylish and unique ventilation solution for

the modern home. The shutter design makes switching on and off almost silent and helps reduce external noise ingress.

The slim profile and iris shutter of the iCON make it a fan which will blend discreetly into any setting. The iCON 15 Shower Kit is supplied with adjustable timer module and ducting installation kit.



Modules

See page 40 for module functionality

72573602	Pull Cord
72612601	Timer
72687103	Humidity, Pull Cord with Timer overrun
72687104	Motion Sensor with Timer overrun
72687102	Motion Sensor Humidity Timer
72675701	Continuous Ventilation at 8/13 l/sec
72675702	Delayed Timer with Pull Cord
72675703	2 Speed Humidity Pull Cord boost



Technical Data

Specification	iCON 15	iCON 15C
Air flow m ³ /hr / l/sec	68 / 19	68 / 19
Fan type	Axial	Axial
Mounting	Wall / Ceiling	Wall / Ceiling
Sound pressure dB(A)@3m	35	35
Power watts	9.2	14.5
Specific Fan Power (SFP)	0.49	-
Building Regulations ADF	Yes	-
Duct diameter (mm)	100	100
Voltage	230/1/50Hz	230/1/50Hz
Rating	IPX4	IPX4
Max ambient temperature	40°C	40°C
Weight (kg)	0.74	0.74
Dimensions (H x W x D) mm	197 x 197 x 40	197 x 197 x 40
Part No.	72683501	72591501

Covers

52634504	Silver
52634505	Sandstone
52634502	Chrome
52634503	Anthracite

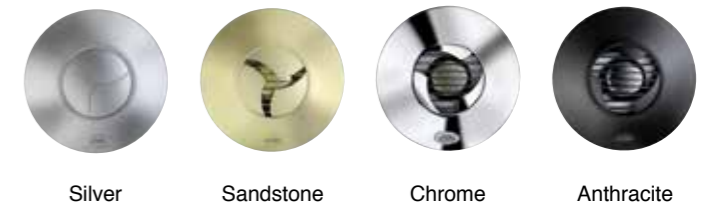

Dimensions (mm)

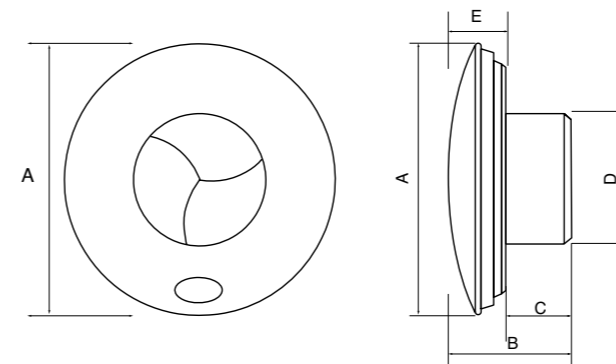

Model	A	B	C	D	E
iCON 15	197	92.5	52.5	100	40

Performance

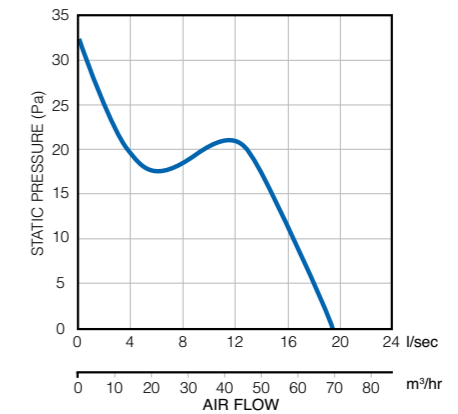

Controls and Accessories

A range of accessories including flexible and rigid ducting kits, controls and grilles are available.

iCON 30

Stylish toilet, bathroom and utility room ventilation



Key Features

- Mixed flow fan
- Flow rate up to 118 m³/hr
- Recess or surface mounting
- Different colour covers available
- Perfect for longer duct runs
- Unique iris shutter, prevents backdraughts, operates silently
- Interchangeable control modules match fan to installation requirements
- Circular design, no squaring up
- IPX4 rating
- Complies with Building Regulations
- 3 year warranty



iCON 30

iCON 30 is quiet, powerful and designed for recessed or surface mounting in walls or ceilings in larger toilets, bathrooms and utility rooms.

iCON 30 is designed to provide ventilation levels that comply with the latest Building Regulations.

The iCON fan is an efficient, stylish and unique ventilation solution for the modern home. The shutter design makes switching on and off almost silent and helps reduce external noise ingress.

The slim profile and iris shutter of the iCON make it a fan which will blend discreetly into any setting.



Modules

See page 40 for module functionality

72573602	Pull Cord
72612601	Timer
72687103	Humidity, Pull Cord with Timer overrun
72687104	Motion Sensor with Timer overrun
72687102	Motion Sensor Humidity Timer
72675701	Continuous Ventilation at 8/13 l/sec
72675702	Delayed Timer with Pull Cord
72675703	2 Speed Humidity Pull Cord boost

Technical data

Specification	iCON 30
Air flow m ³ /hr / l/sec	118 / 32
Fan type	Mixed Centrifugal / Axial
Mounting	Wall / Ceiling
Sound pressure dB(A)@3m	34.5
Power watts	30
Building Regulations ADF	Yes
Duct diameter (mm)	100
Voltage	230v / 1ph / 50Hz
Rating	IPX4
Max ambient temperature	40°C
Weight (kg)	1.11
Dimensions (H x W x D) mm	225 x 225 x 141
Part No.	72591601



Covers

52634507	Silver
52634508	Sandstone
52634506	Anthracite



Silver Sandstone Anthracite

Dimensions (mm)

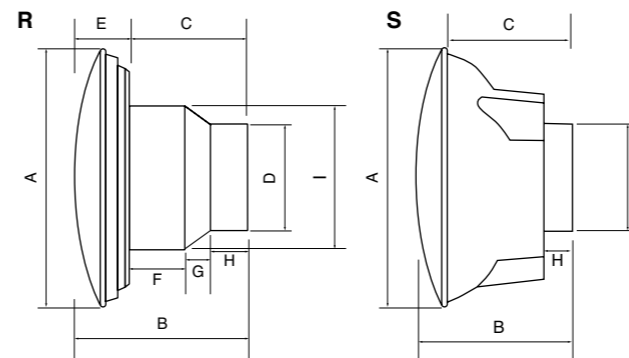

R = Recessed without skirt S = Surface mounted with skirt

Model	A	B	C	D	E	F	G	H	I
iCON 30 (R)	225	144	101	97	43	51	20	30	148
iCON 30 (S)	225	144	92	97	-	-	-	29	-

Performance

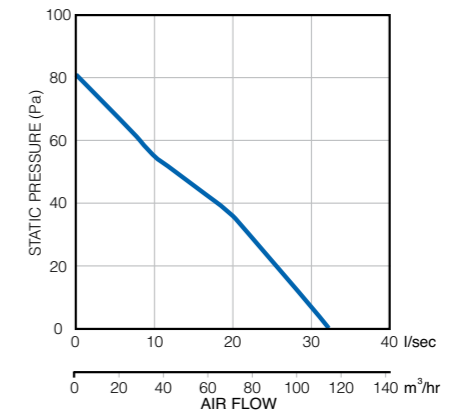

Controls and Accessories

A range of accessories including flexible and rigid ducting kits, controls and grilles are available.

iCON 60

Stylish large bathroom, utility room and kitchen ventilation

Key Features

- Mixed flow fan
- Flow rate up to 260 m³/hr
- Recess or surface mounting
- Different colour covers available
- Perfect for longer duct runs
- Unique iris shutter, prevents backdraughts, operates silently
- Interchangeable control modules match fan to installation requirements
- Circular design, no squaring up
- IPX4 rating
- Complies with Building Regulations - ADF
- 3 year warranty



iCON 60

iCON 60 is the largest, most powerful fan in the range. It is suitable for recessed or surface mounting in walls or ceilings and is highly efficient in domestic kitchens, large bathrooms and utility rooms.

iCON 60 is designed to provide ventilation levels that comply with the latest Building Regulations.

The iCON fan is an efficient, stylish and unique ventilation solution for the modern home. The shutter design makes switching on and off almost silent and helps reduce external noise ingress. The slim profile and iris shutter of the iCON make it a fan which will blend discreetly into any setting.



Modules

See page 40 for module functionality

72573602	Pull Cord
72612601	Timer
72687103	Humidity, Pull Cord with Timer overrun
72687104	Motion Sensor with Timer overrun
72687102	Motion Sensor Humidity Timer
72675701	Continuous Ventilation at 8/13 l/sec
72675702	Delayed Timer with Pull Cord
72675703	2 Speed Humidity Pull Cord boost

Technical data

Specification	iCON 60
Air flow m ³ /hr / l/sec	260 / 72
Fan type	Mixed Centrifugal / Axial
Mounting	Wall / Ceiling
Sound pressure dB(A)@3m	44.6
Power Watts	75
Building Regulations ADF	Yes
Duct diameter (mm)	150
Voltage	230v / 1ph / 50Hz
Rating	IPX4
Max ambient temperature	40°C
Weight (kg)	1.97
Dimensions (H x W x D) mm	280 x 280 x 165
Part No.	72591701

Dimensions (mm)

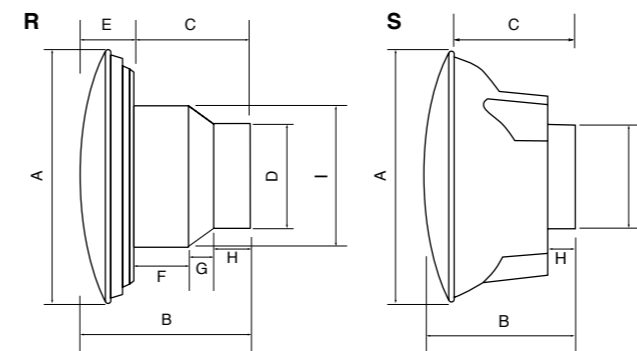

R = Recessed without skirt S = Surface mounted with skirt

Model	A	B	C	D	E	F	G	H	I
iCON 60 R	280	165	110	148	55	38	20	52	177
iCON 60 S	280	165	80	148	-	-	-	46	-



Covers

52634510	Silver
52634511	Sandstone
52634509	Anthracite



Silver Sandstone Anthracite

Performance

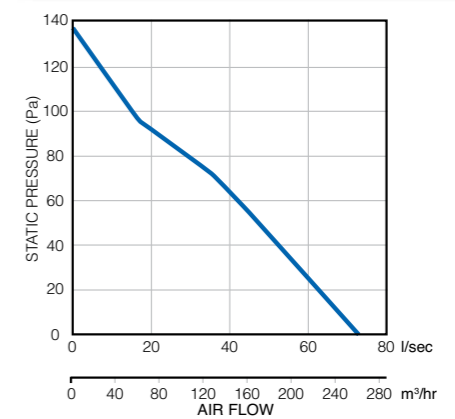

Controls and Accessories

A range of accessories including flexible and rigid ducting kits, controls and grilles are available.

iCON 15S eco

Stylish toilet and bathroom ventilation



Key Features

- Low energy axial fan
- Flow rate up to 79 m³/hr
- Stylish, slim and unobtrusive in walls or ceilings
- Different colour covers available
- Unique iris shutter, prevents backdraughts, operates silently
- Interchangeable control modules match fan to installation requirements
- Low watt motor - 7.5w
- SFP 0.34 W/l/s
- Universal voltage 100/240v - 50/60Hz
- IPX4 rating
- Complies with Building Regulations
- 3 year warranty

iCON 15S eco

iCON 15S eco 12 volt low energy fans with brushless DC motors offer significantly reduced energy consumption compared with standard AC motors. Fitted with ball-bearing motors for extra long life, each model is supplied with a remote mounting 100/240v AC to 12vDC transformer. Stylish, slim and unobtrusive in walls or ceilings. The circular design means no squaring up is required, adding to the already simple installation procedure.

iCON 15S eco is designed to provide ventilation levels that comply with the latest Building Regulations.

The iCON fan is an efficient, stylish and unique ventilation solution for the modern home. The shutter design makes switching on and off almost silent and helps reduce external noise ingress. The slim profile and iris shutter of the iCON make it a fan which will blend discreetly into any setting.



Modules

See page 40 for module functionality

72573603	Pull Cord
72574204	Pull Cord with adjustable Timer
72574202	Motion Sensor with Timer overrun
72574203	Motion Sensor with Timer overrun
72574201	Passive Infra Red Humidity Timer
72682307	Delay Start Timer with Pull Cord



Technical Data

Specification	iCON 15S eco
Air flow m ³ /hr / l/sec	79 / 22
Fan type	Axial
Mounting	Wall / Ceiling
Sound pressure dB(A)@3m	35
Power watts	7.5
Specific Fan Power (SFP)	0.34
Building Regulations ADF	Yes
Duct diameter (mm)	100
Voltage	100/240v-50/60Hz
Rating	IPX4
Max ambient temperature	40°C
Weight (kg)	0.74
Dimensions (H x W x D) mm	197 x 197 x 40
Part No.	72683701

Covers

52634504	Silver
52634505	Sandstone
52634502	Chrome
52634503	Anthracite



Dimensions (mm)

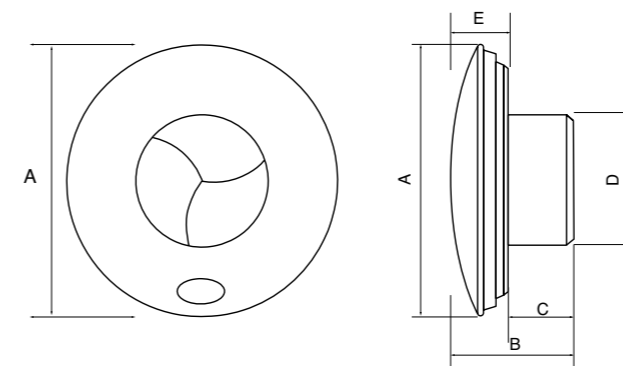

Model	A	B	C	D	E
iCON 15S eco	197	85	45	100	40

Performance

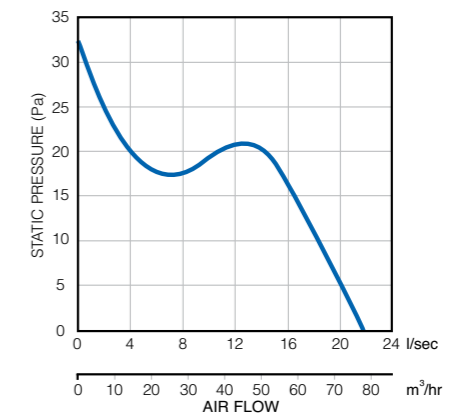

Controls and Accessories

A range of accessories including flexible and rigid ducting kits, controls and grilles are available.

iCON 30S eco

Stylish toilet, bathroom and utility ventilation



Key Features

- Low energy mixed flow fan
- Flow rate up to 123 m³/hr
- Stylish, slim and unobtrusive in walls or ceilings
- Recessed or surface mounting
- Different colour covers available
- Unique iris shutter, prevents backdraughts, operates silently
- Interchangeable control modules match fan to installation requirements
- Low watt motor - 13w
- SFP 0.38 W/l/s
- Universal voltage 100/240v - 50/60Hz
- IPX4 rating
- Complies with Building Regulations
- 3 year warranty

iCON 30S eco

iCON 30S eco 12 volt low energy fans with brushless DC motors offer significantly reduced energy consumption compared with standard AC motors. Fitted with ball-bearing motors for extra long life, each model is supplied with a remote mounting 100/240v AC to 12v DC transformer. Stylish, slim and unobtrusive in walls or ceilings.

The iCON fan is an efficient, stylish and unique ventilation solution for the modern home. The shutter design makes switching on and off almost silent and helps reduce external noise ingress. The slim profile and iris shutter of the iCON make it a fan which will blend discreetly into any setting.

iCON 30S eco is designed to provide ventilation levels that comply with the latest Building Regulations.



Modules

See page 40 for module functionality

72573603	Pull Cord
72574204	Pull Cord with adjustable Timer
72574202	Motion Sensor with Timer overrun
72574203	Motion Sensor with Timer overrun
72574201	Passive Infra Red Humidity Timer
72682307	Delay Start Timer with Pull Cord



Technical Data

Specification	iCON 30S eco
Air flow m ³ /hr / l/sec	123 / 34
Fan type	Mixed Centrifugal / Axial
Mounting	Wall / Ceiling
Sound pressure dB(A)@3m	34.5
Power watts	13
Specific Fan Power (SFP)	0.38
Building Regulations ADF	Yes
Duct diameter (mm)	100
Voltage	100/240v-50/60Hz
Rating	IPX4
Max ambient temperature	40°C
Weight (kg)	1.1
Dimensions (H x W x D) mm	225 x 225 x 141
Part No.	72683801

Covers

52634507	Silver
52634508	Sandstone
52634506	Anthracite

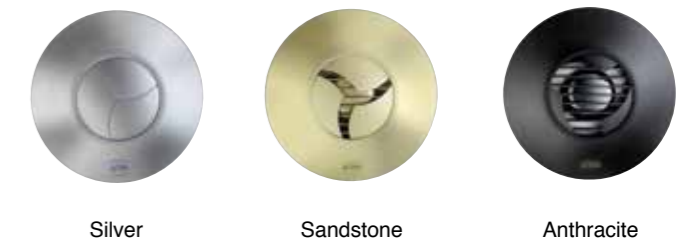

Dimensions (mm)

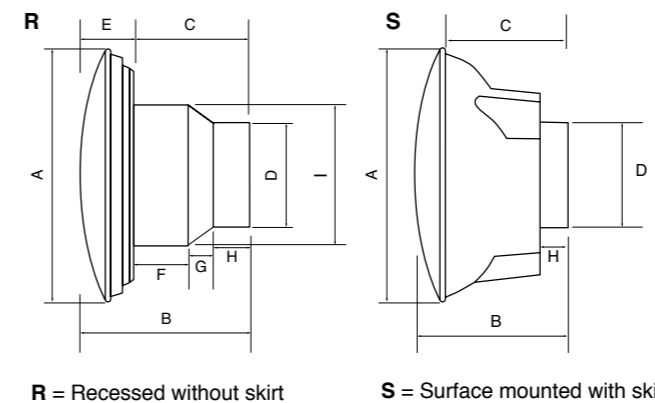

Model	A	B	C	D	E	F	G	H	I
iCON 30S eco (R)	225	144	101	97	43	51	20	30	148
iCON 30S eco (S)	225	144	92	97	-	-	-	29	-

Performance

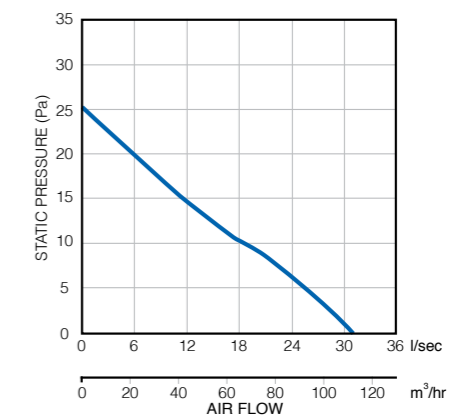

Controls and Accessories

A range of accessories including flexible and rigid ducting kits, controls and grilles are available.

iCON 15 eco

Stylish toilet and bathroom ventilation

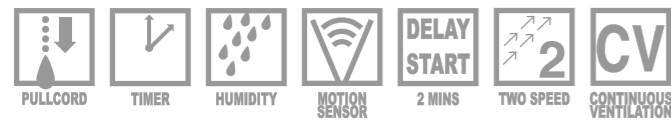

Key Features

- Super low energy axial fan
- Flow rate 79 m³/hr
- Switch Mode Power Supply (SMPS) located in the module
- Stylish, slim and unobtrusive in walls or ceilings
- Different colour covers available
- Unique iris shutter, prevents backdraughts, operates silently
- Quiet operation 35 dB(A)
- Interchangeable control modules match fan to installation requirements
- Low watt motor – 7.5W
- SFP 0.34 W/l/s
- Voltage supply 100/240v-50/60Hz
- IPX4 rating
- Complies with Building Regulations
- 3 year warranty

iCON 15 eco

iCON 15 eco with the brand new SMPS technology located in the module converts 100/240v AC power into 12v DC power. The advantage of this quicker and easier installation is a neater and more compact method of powering a low energy fan than a bulky transformer.

iCON 15 eco is designed to provide ventilation levels that comply with the latest Building Regulations. The Specific Fan Power is also well within the parameters of the energy requirements of the Building Regulations

The iCON fan is an efficient, stylish and unique ventilation solution for the modern home. The shutter design makes switching on and off almost silent and helps reduce external noise ingress. The slim profile and iris shutter of the iCON make it a fan which will blend discreetly into any setting.



Modules

See page 41 for module functionality

72687127	Pull Cord
72687128	Timer
72687129	Humidity Pull Cord with Timer overrun
72687130	Motion Sensor with Timer overrun
72687131	Motion Sensor Humidity Timer
72687132	Continuous Ventilation at 8/13 l/sec
72687133	Delayed Timer
72687134	2 Speed Humidity Pull Cord boost

Note: This fan requires a module to operate



Technical Data

Specification	iCON 15 eco
Air flow m ³ /hr / l/sec	79 / 22
Fan type	Axial
Mounting	Wall / Ceiling
Sound pressure dB(A)@3m	35
Power watts	7.5
Specific Fan Power (SFP)	0.39
Building Regulations ADF	Yes
Duct diameter (mm)	100
Voltage	100/240v-50/60Hz
Rating	IPX4
Max ambient temperature	40°C
Weight (kg)	0.74
Dimensions (H x W x D) mm	197 x 197 x 40
Part No.	72687121

Dimensions (mm)

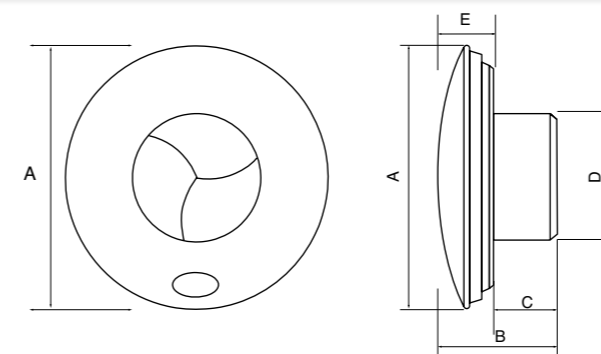

Model	A	B	C	D	E
iCON 15 eco	197	85	45	100	40

Covers

52634504	Silver
52634505	Sandstone
52634503	Anthracite
52634502	Chrome



Silver Sandstone Chrome Anthracite

Performance

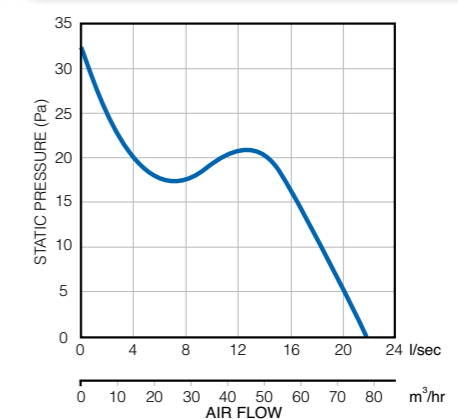

Controls and Accessories

A range of accessories including flexible and rigid ducting kits, controls and grilles are available.

iCON 30 eco

Stylish toilet, bathroom and utility ventilation

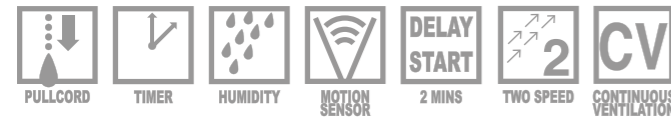

Key Features

- Super low energy mixed flow fan
- Flow rate up to 112 m³/hr
- Switch Mode Power Supply (SMPS) located in the module
- Stylish, slim and unobtrusive in walls or ceilings
- Recessed or surface mounting
- Different colour covers available
- Unique iris shutter, prevents backdraughts, operates silently
- Quiet operation from 34dB(A)
- Interchangeable control modules match fan to installation requirements
- Low watt motor – 14W
- SFP 0.45 W/l/s
- Voltage supply 100/240v-50/60Hz
- IPX4 rating
- Complies with Building Regulations

iCON 30 eco

iCON 30 eco with the brand new SMPS technology located in the module converts 100/240v AC power into 12v DC power. The advantage of this quicker and easier installation is a neater and more compact method of powering a low energy fan than a bulky transformer.

iCON 30 eco is designed to provide ventilation levels that comply with the latest Building Regulations. The Specific Fan Power is also well within the parameters of the energy requirements of the Building Regulations

The iCON fan is an efficient, stylish and unique ventilation solution for the modern home. The shutter design makes switching on and off almost silent and helps reduce external noise ingress. The slim profile and iris shutter of the iCON make it a fan which will blend discreetly into any setting.



Modules

See page 41 for module functionality

72687127	Pull Cord
72687128	Timer
72687129	Humidity Pull Cord with Timer overrun
72687130	Motion Sensor with Timer overrun
72687131	Motion Sensor Humidity Timer
72687132	Continuous Ventilation at 8/13 l/sec
72687133	Delayed Timer
72687134	2 Speed Humidity Pull Cord boost

Note: This fan requires a module to operate

Technical Data

Specification	iCON 30 eco
Air flow m ³ /hr / l/sec	112 / 31
Fan type	Mixed Centrifugal / Axial
Mounting	Wall / Ceiling
Sound pressure dB(A)@3m	34
Power watts	14
Specific Fan Power (SFP)	0.45
Building Regulations ADF	Yes
Duct diameter (mm)	100
Voltage	100/240v-50/60Hz
Rating	IPX4
Max Ambient Temperature	40°C
Weight (kg)	1.11
Dimensions (H x W x D) mm	225 x 225 x 141
Part No.	72687122

Dimensions (mm)

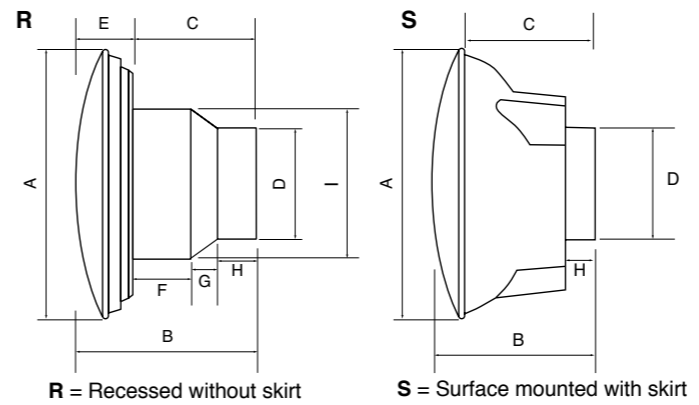

Model	A	B	C	D	E	F	G	H	I
iCON 30 eco (R)	225	144	101	97	43	51	20	30	148
iCON 30 eco (S)	225	144	92	97	-	-	-	29	-



Covers

52634507	Silver
52634508	Sandstone
52634506	Anthracite

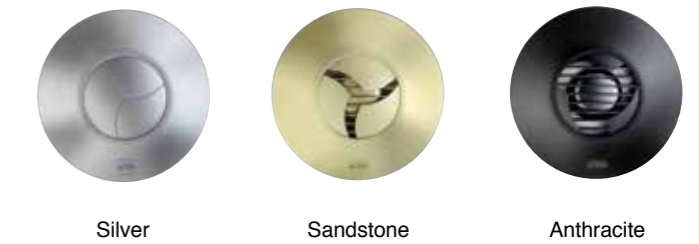

Performance

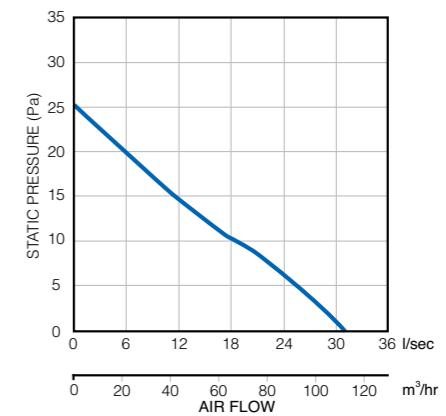

Controls and Accessories

A range of accessories including flexible and rigid ducting kits, controls and grilles are available.

iCON 60 eco

Stylish large bathroom, utility room and kitchen ventilation - coming soon

Key Features

- Super low energy mixed flow fan
- Switch Mode Power Supply (SMPS) located in the module
- Stylish, slim and unobtrusive in walls or ceilings
- Recessed or surface mounting
- Different colour covers available
- Unique iris shutter, prevents backdraughts, operates silently
- Quiet operation
- Interchangeable control modules match fan to installation requirements
- Low watt motor
- Voltage supply 100/240v-50/60Hz
- IPX4 rating
- Complies with Building Regulations
- 3 year warranty



iCON 60 eco

iCON 60 eco with the brand new SMPS technology located in the module converts 100/240v AC power into 12v DC power. The advantage of this quicker and easier installation is a neater and more compact method of powering a low energy fan than a bulky transformer.

iCON 60 eco is designed to provide ventilation levels that comply with the latest Building Regulations. The Specific Fan Power is also well within the parameters of the energy requirements of the Building Regulations

The iCON fan is an efficient, stylish and unique ventilation solution for the modern home. The shutter design makes switching on and off almost silent and helps reduce external noise ingress. The slim profile and iris shutter of the iCON make it a fan which will blend discreetly into any setting.



Modules

See page 41 for module functionality

72687127	Pull Cord
72687128	Timer
72687129	Humidity, Pull Cord with Timer overrun
72687130	Motion Sensor with Timer overrun
72687131	Motion Sensor Humidity Timer
72687132	Continuous Ventilation at 8/13 l/sec
72687133	Delayed Timer
72687134	2 Speed Humidity Pull Cord boost

Note: This fan requires a module to operate



Technical Data

Specification	iCON 60 eco
Air flow m³/hr / l/sec	tba / tba
Fan type	Mixed Centrifugal / Axial
Mounting	Wall / Ceiling
Sound pressure dB(A)@3m	tba
Power watts	tba
Building Regulations ADF	Yes
Duct diameter (mm)	150
Voltage	100/240v-50/60Hz
Rating	IPX4
Max ambient temperature	40°C
Weight (kg)	1.97
Dimensions (H x W x D) mm	280 x 280 x 165
Part No.	72687123

Covers

52634510	Silver
52634511	Sandstone
52634509	Anthracite



Silver Sandstone Anthracite

Dimensions (mm)

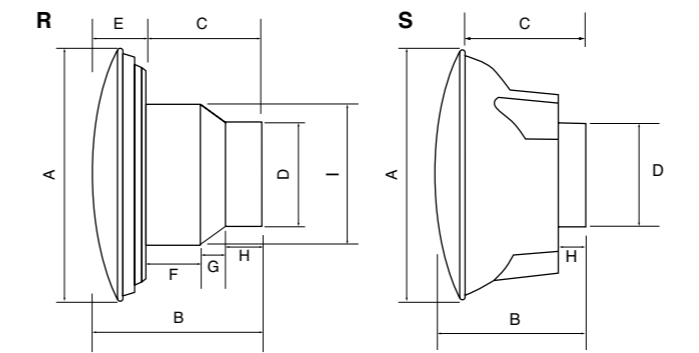

R = Recessed without skirt S = Surface mounted with skirt

Model	A	B	C	D	E	F	G	H	I
iCON 60 eco R	280	165	110	148	55	38	20	52	177
iCON 60 eco S	280	165	80	148	-	-	-	46	-

Performance

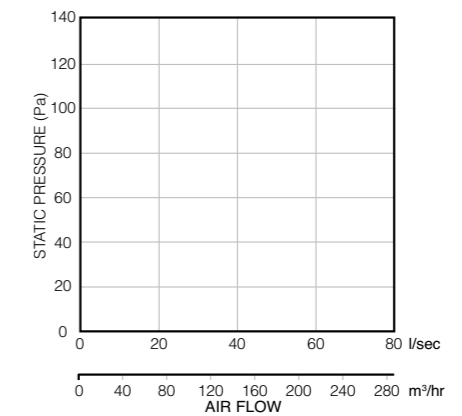

See website for details - coming soon

Controls and Accessories

A range of accessories including flexible and rigid ducting kits, controls and grilles are available.



Choose the function
Select the module
It's iCON simple



The module concept which is unique to iCON, gives one the option of determining how you wish to control your fan and based on your requirement select the appropriate module. Airflow has invested extensively in the research and development of our modules to bring our customers the most versatile controllability available in the extractor fan market. Our extensive range of control functions has helped the iCON product range become the leading brand it is today.

The same module is compatible with all three size iCON's – 15, 30 and 60. However, it should be noted that there are specific 240V modules and different low voltage SELV modules (please refer to the table below for details and part numbers of the various modules).

Replacing a module is also a lot simpler and cheaper than replacing the entire fan.

Modules for use in 240V iCON Fans iCON 15 - 72683501 iCON 30 - 72591601 iCON 60 - 72591701

Part No.	Control	Function
72573602	PCM	Manual on/off control by pull cord switch
72612601	TM	Adjustable timer between 1 - 30 minutes, remote or light switch operation
72687103	HTM	Adjustable humidity setting between 40 - 90% RH, adjustable timer and momentary pull cord to override
72687104	PRTM	Motion sensor activation with adjustable timer
72687102	PRHTM	Motion sensor activation with adjustable humidity setting and adjustable timer
72675701	CV2	Continuous Ventilation at 8/13 l/sec. Module automatically recognizes fan installation. Boost to a maximum flow rate of the fan by remote switching
72675702	DTM	Delayed start for 2 minutes after light switch operation (ideal for quick visits) then adjustable timer between 2 - 45 minutes (DTM only)
72675703	2SHM	Remote light switch operation activates low speed. Boost speed activated by automatic humidity sensor (adjustable 40 - 90% RH) or manually by pull cord (detachable if required)

Modules for use in 12V iCON SELV Fans with remote transformer iCON 15S eco - 72683701 iCON 30S eco - 72683801

72573603	PCS	Manual on/off control by pull cord switch
72574204	PCTS	Adjustable timer between 1 - 30 minutes, pull cord/ remote or light switch operation
72574202	HTS	Adjustable humidity setting 40 - 90% RH, adjustable timer and pull cord to override
72574203	PRTS	Motion sensor activation with adjustable timer
72574201	PRHTS	Motion sensor activation with adjustable humidity setting and adjustable timer
72682307	DTS	Delayed start for 2 minutes after light switch operation (ideal for quick visits) then adjustable timer between 2 - 45 minutes (DTS only)

Modules with integral transformer for use in 12V iCON fans iCON 15 eco - 72687121 iCON 30 eco - 72687122 iCON 60 eco - 72687123

Part No.	Control	Function
72687127	PCE	Manual on/off control by pull cord switch
72687128	TE	Adjustable timer between 1 - 30 minutes, remote or light switch operation
72687129	HTE	Adjustable humidity setting between 40 - 90% RH, adjustable timer and momentary pull cord to override
72687130	MSTE	Motion sensor activation with adjustable timer
72687131	MSHTE	Motion sensor activation with adjustable humidity setting and adjustable timer
72687132	CVE	Continuous Ventilation at 8/13 l/sec. Module automatically recognizes fan installation. Boost to a maximum flow rate of the fan by remote switching
72687133	DTE	Delayed start for 2 minutes after light switch operation (ideal for quick visits) then adjustable timer between 2 - 45 minutes (DTE only)
72687134	2SHE	Remote light switch operation activates low speed. Boost speed activated by automatic humidity sensor (adjustable 40 - 90% RH) or manually by pull cord (detachable if required)

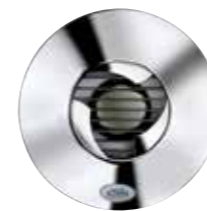

Chrome



Anthracite



Silver



Sandstone

Adding colour and style to your home with a coloured iCON cover

Colour Covers	iCON 15	iCON 30	iCON 60
Anthracite	52634503	52634506	52634509
Silver	52634504	52634507	52634510
Sandstone	52634505	52634508	52634511
Chrome	52634502	N/A	N/A

To complement the décor of your home, we also offer the flexibility to upgrade the white cover to Anthracite, Sandstone, Silver or Chrome (iCON 15 only). This is perfect for customers looking for a fan that blends seamlessly into the surroundings adding colour and co-ordination to any toilet, en-suite, bathroom, utility room or kitchen at a surprisingly low cost.

The covers are simple to fit and can be easily cleaned by simply wiping off with a damp cloth.

We are convinced that our exclusive design and product configuration possibilities, have contributed to iCON fans, modules and covers becoming one of the most successful brand names in the extractor fan business.

iCONstant

Continuous Ventilation



Key Features

- Continuous running axial fan
- Trickle flow rate from 22 m³/hr
- Boost flow rate up to 97 m³/hr
- Stylish circular design suitable for wall and ceiling mounting
- Ideal for New Build and Refurbishments
- LED lamp to indicate fan failure
- Very quiet running fan
- Low energy motor – economical to operate
- Timer and humidity timer versions
- IPX5 rating
- Complies with Building Regulations
- SAP Appendix Q eligible*
- 3 year warranty

iCONstant.

The market for Decentralised Mechanical Extract Ventilation (dMEV) fans is particularly prevalent in the social housing sector as specifiers, but also landlords and tenants, seek a ventilation solution that will satisfy the need for an energy efficient, economical to run and low noise fan with minimum human intervention.

iCONstant helps eliminate the problems of condensation and mould growth by continuously extracting the damp, moist air that is the source of the problem.

Choose iCONstant, the quiet, low energy dMEV fan from Airflow.

* pending approval



Models

Timer	Timer can be set to run on between 2 and 45 minutes
Humidity Timer	Intelligent humidity sensor with timer overrun control

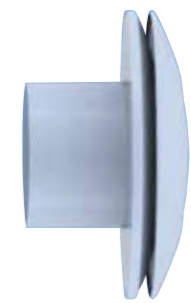

Technical Data

Specification	iCONstant		
Air flow m ³ /hr (trickle/boost)	22 / 29	29 / 47	47 / 97
Air flow l/sec (trickle/boost)	6 / 8	8 / 13	13 / 27
Fan type	Axial		
Controls	Timer/ Humidity Timer		
Sound pressure dB(A)@3m	tba	tba	tba
Power watts	1.61 / 1.81	1.81 / 2.51	2.51 / 5.31
Amps	3		
Specific Fan Power (SFP)	0.27 / 0.23	0.23 / 0.19	0.19 / 0.20
Building Regulations ADF	Yes		
Duct diameter (mm)	100		
Voltage	100/240V-50/60Hz		
Rating	IPX5		
Weight (kg)	tba		
Dimensions (H x W x D) mm	197 x 197 x 120		
Part No.	72687117 (T)	72687118 (HT)	

* results pending

Dimensions (mm)

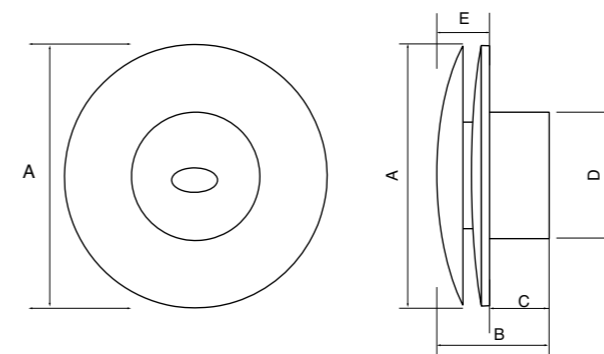

Model	A	B	C	D	E
iCONstant	197	120	70	100	50



Performance

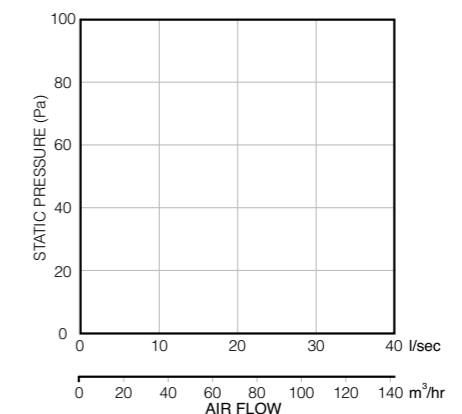

See website for details

Controls and Accessories

A range of accessories including flexible and rigid ducting kits, controls and grilles are available.

iCONstant

Continuous Ventilation

Why dMEV?

dMEV fans comply with Part F System 3 of the Building Regulations often referred to as Continuous Mechanical Extract Ventilation. The Airflow iCONstant dMEV continuous ventilation fan will provide the perfect solution for both new build and retrofitting into any domestic home, particularly where there has been an

increased level of insulation making it more airtight or the homeowner/tenant has a particular problem with condensation or mould. The iCONstant with Timer or Humidity Timer functionality are also SAP Appendix Q eligible*.

* pending approval

Economical to Operate – less than a light bulb

iCONstant has been developed to consume minimal energy by using a highly efficient DC motor. The motor draws a mere 0.91w on the trickle speed of 6 l/sec. The boost speed on the humidity version is intelligently controlled so as to minimise the period of the boost flow and not significantly ramp up the running costs.

The yearly running cost of the iCONstant is less than that of a low energy light bulb. A small price to pay to ensure the well-being of the occupier and help preserve the fabric of the building.

Versatile Applications – one fan for all rooms

iCONstant dMEV fans can be used in any of the wet rooms. The required trickle rate is selected by the installer when the fan is fitted – this is dependent on the application - for toilets select 6 l/sec, en-suites, bathrooms and utility rooms select 8 l/sec and for kitchens it is 13 l/sec.

The boost speed will be the next speed level up with a maximum speed of 27 l/sec. The boost to the higher speed is activated by one of the following methods; momentary pull cord, remote switch or intelligent humidity sensor.

Simple Controllability – optimizing your ventilation

On the timer version, the boost speed is set to run on for between 2 and 45 minutes. With the Humidity Timer version, the intelligent humidity sensor will activate the boost speed when a set point is reached – this can be

adjusted anywhere between 60% and 90%. When the set point is reached after the boost speed kicks in, the fan will revert to the trickle speed once again.



Packed with useful features with the user in mind

Airflow's intelligent humidity sensor offers the additional feature of being able to recognize a rapid increase in humidity and activates the boost speed before the pre-set value is reached so that preventive ventilation commences. Should this occur, the fan reverts to the trickle speed when the humidity level is within 10% of the set-point. The benefits of this are that energy consumption is kept to a minimum and noise levels are reduced whilst ensuring optimum ventilation is achieved.

Another feature is the ability to delay the start of the boost function by two minutes on the live switch and humidity sensor. This is particularly advantageous for those quick visits during the middle of the night and to avoid waking up the entire household every time someone visits the loo. The boost activation on the pull cord is instant.

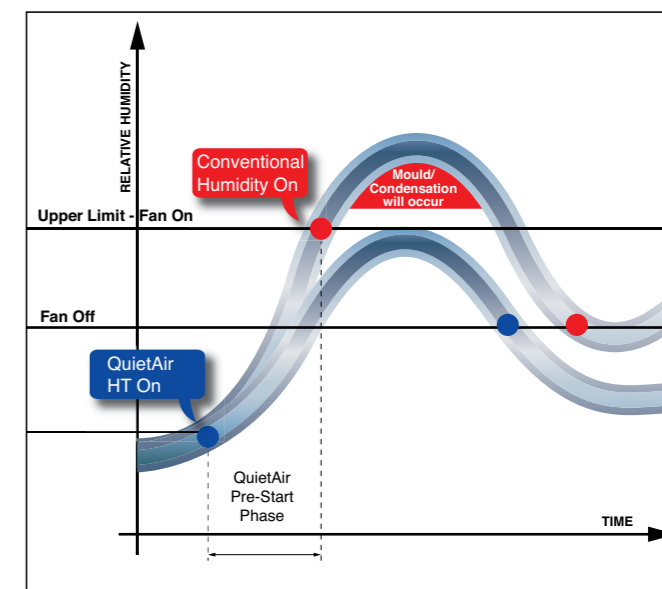

Another stylish design from Airflow

As the fans are extremely quiet in continuous mode, we have introduced an LED light which flashes through the cover in the event of a failure.

The iCONstant is designed to be recessed into either the wall or the ceiling. The white cover can be wiped clean with a wet cloth or removed with the simple twist

off action when the cover and or inner parts require a proper clean. Should you wish to hide the momentary pull cord in ceiling installations for example, we have designed the product in such a way that the cord can be neatly stowed away within the fan.

User safety is our priority

As we have achieved IPX5 ingress protection rating on this product, you will be able to fit the iCONstant anywhere within Zones 1 and 2 of your bathroom/ en-suite. This makes our product incredibly safe to operate which is another reason for housing associations and landlords to specify iCONstant, also it is easy for the installer to position the fan. Airflow is one of the few suppliers to offer a dMEV product with this rating.



It's an all-round win for iCONstant

iCONstant's circular design is based on our very successful iCON brand of extractor fans. Customers like our circular design as this enhances the style and

appearance of the room plus a round fan is simple and quicker to install saving on costs once again.

LOOVENT eco

A fan for every room

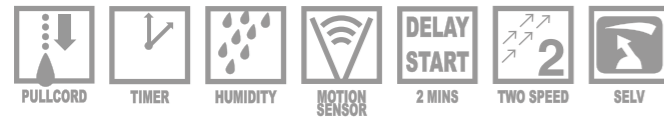

Key Features

- Two speed centrifugal fan
- Flow rate up to 110 m³/hr
- Compact design - smallest 30 l/sec fan in class
- For toilets, bathrooms, en-suites, utility rooms and kitchens (adjacent to hob)
- Well proven, centrifugal, filterless technology
- Surface or recessed, portrait or landscape
- Simple replacement of existing Loovent - same mounting and spigot position
- Economical to operate - from 3.6w
- Timer, humidity timer and motion sensor Timer versions
- SELV versions - low voltage
- Voltage supply 100/240v-50/60Hz
- IPX5 rating
- Complies with Building Regulations
- 5 year warranty

The next generation...

From an excellent pedigree of fans for over 40 years comes the next generation of fans – LOOVENT eco. A powerful, discreetly styled fan in a modular design for ease of installation and maintenance to ensure effective ventilation with minimal noise level and energy efficiency in mind.

It is exceptionally quiet with various “on-demand” control options that only activate the fan when needed - timer, humidity timer and motion sensor with timer. The low

energy motor helps reduce carbon emissions and saves on energy bills.

The LOOVENT eco is truly versatile in that it can be surface or recessed mounted into the wall or ceiling and fitted in either the portrait or landscape position.

LOOVENT eco is ideal for replacing the old Loovent 01C or existing Loovent 01 as the spigot position is identical and the back plates are the same size keeping reworking to a minimum.



Models

Timer / SELV T	Timer can be set to run on between 2 and 45 minutes
Humidity Timer / SELV HT	Humidity sensor can be set between 40 - 90% RH
Motion Sensor Timer	PIR sensor activates fan to switch on, timer overrun



Technical Data

Specification	LOOVENT eco T	LOOVENT eco HT	LOOVENT eco MST
Air flow m ³ /hr (low / boost)	62 / 110	62 / 110	62 / 110
Air flow l/sec (low / boost)	17 / 31	17 / 31	17 / 31
Fan type	Centrifugal	Centrifugal	Centrifugal
Controls	Timer	Humidity Timer	Motion Sensor Timer
Sound pressure dB(A)@3m	29 / 47	29 / 47	29/47
Power watts	3.6 / 12	3.6 / 12	3.6 / 12
Amps	3	3	3
Specific Fan Power (SFP)	0.21 / 0.40	0.21 / 0.40	0.21/0.40
Building Regulations ADF	Yes	Yes	Yes
Duct diameter (mm)	100	100	100
Voltage	100/240v-50/60Hz	100/240v-50/60Hz	100/240v-50/60Hz
Rating	IPx5	IPx5	IPx5
Weight (kg)	1,0	1,0	1,0
Dimensions (H x W x D) mm	167 x 187 x 138	167 x 187 x 138	167 x 187 x 138
Part No.	72684305	72684306	72684307
	72684309 (SELV)	72684310 (SELV)	N/A

Dimensions (mm)

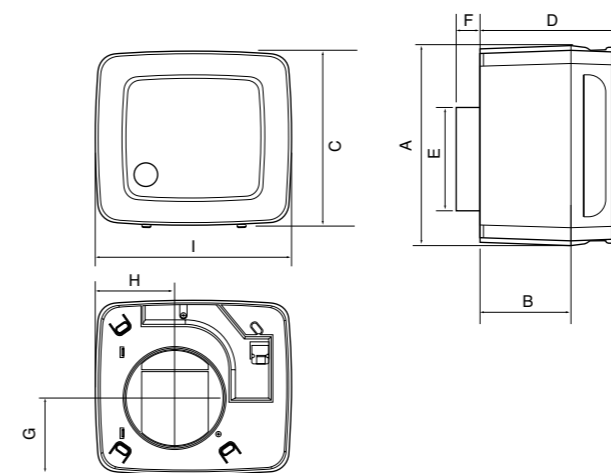

Model	A	B	C	D	E	F	G	H	I
LOOVENT eco	99	85.5	167	138.5	99	22	74.5	75	187

Performance

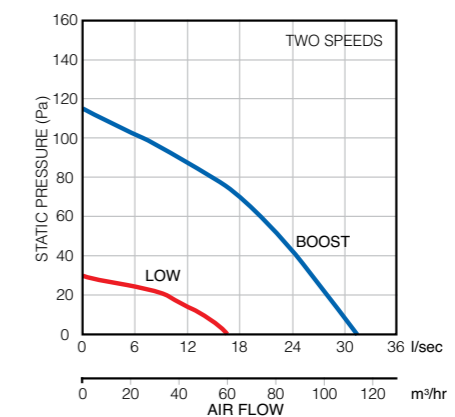

Controls and Accessories

A range of accessories including flexible and rigid ducting kits, controls and grilles are available.

LOOVENT eco dMEV

Continuous ventilation



Key Features

- Continuous running centrifugal fan
- Trickle flow rate from 25 m³/hr
- Boost flow rate up to 110 m³/hr
- Compact design - smallest footprint in class
- Ideal for New Build and Refurbishments in toilets, bathrooms, en-suites, utility rooms and kitchens (adjacent to hob)
- Surface or recessed, portrait or landscape
- Simple replacement of existing Loovent - same mounting and spigot position
- Economical to operate - from 2.8w
- Timer and humidity timer versions
- SELV versions - low voltage
- Voltage supply 100/240v-50/60Hz
- IPX5 rating
- Complies with Building Regulations
- SAP Appendix Q eligible
- 5 year warranty

The next generation...

The dMEV continuous ventilation versions are the ideal solution for maintaining the perfect air quality in the domestic home. The LOOVENT eco dMEV versions with timer and humidity timer functionality are SAP Appendix Q eligible, making them perfect for the new build market.

The trickle rate should be selected on installation depending on the application - 7 l/sec for toilets, 9 l/sec for bathrooms / en-suites / utility rooms and 16 l/sec for kitchens. Boost speed is activated by the pull cord,

humidity sensor or a remote switch (light / door switch). Boost speeds are 15,15 and 31 l/sec respectively. The pre-set run on timer period will apply and revert back to the trickle speed after this time.

LOOVENT eco is ideal for replacing the old Loovent 01C or existing Loovent 01 as the spigot position is identical and the back plates are the same size keeping reworking to a minimum.

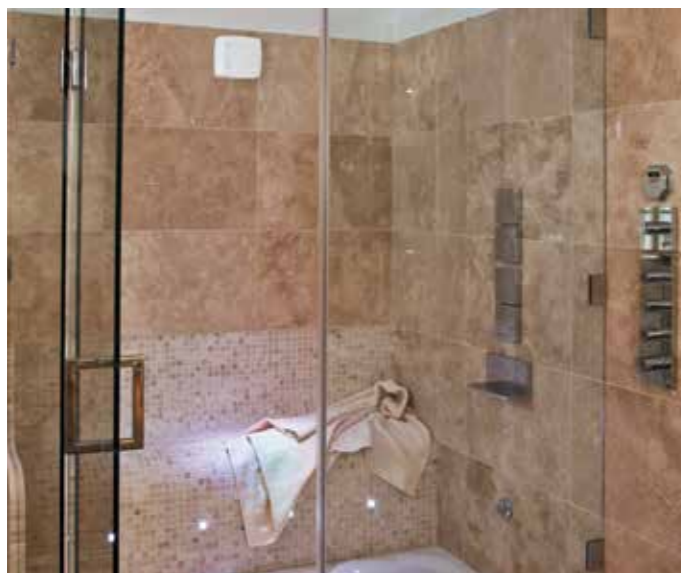

Models

Timer / SELV T Timer can be set to run on between 2 and 45 minutes

Humidity Timer / SELV HT Humidity sensor can be set between 40 - 90% RH

Technical Data

Specification	LOOVENT eco dMEV		
Air flow m ³ /hr (trickle / boost)	25 / 55	33 / 55	59 / 110
Air flow l/sec (trickle / boost)	7 / 15	9 / 15	16 / 31
Fan type	Centrifugal		
Controls	Timer / Humidity Timer		
Sound Pressure dB(A)@3m	25 / 46	25 / 46	28 / 46
Power watts	2.8 / 8.9	3 / 8.9	2.8 / 12
Amps	3		
Specific Fan Power (SFP)	0.40 / 0.59	0.32 / 0.59	0.17 / 0.40
Building Regulations ADF	Yes		
Duct diameter (mm)	100		
Voltage	100/240v-50/60Hz		
Rating	IPx5		
Weight (kg)	1,0		
Dimensions (H x W x D) mm	167 x 187 x 138		
Part No.	72684308 (T)	72684311 (HT)	
	72684312 (SELV)	72684313 (SELV)	



Dimensions (mm)

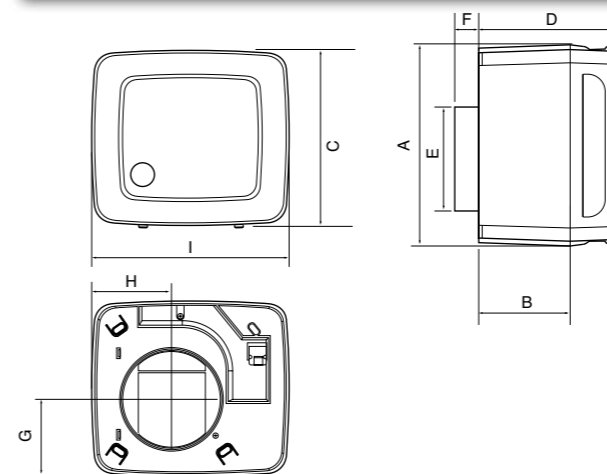

Model	A	B	C	D	E	F	G	H	I
LOOVENT eco	99	85.5	167	138.5	99	22	74.5	75	187



Performance

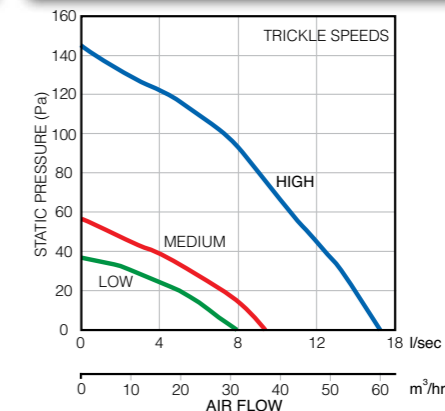

SAP Appendix Q Performance

Unit configuration	Location	Flow rate	Specification fan power (W/l/s)
In room	Kitchen	13.3 l/sec	0.18
	Wet room	7 or 9.3 l/sec	0.31
Through wall	Kitchen	16.9 l/sec	0.19
	Wet room	10.0 l/sec	0.33

Controls and Accessories

A range of accessories including flexible and rigid ducting kits, controls and grilles are available.

Loovent

Toilet and bathroom ventilation



Key Features

- Proven centrifugal fan
- Flow Rate up to 111 m³/hr
- Surface or recessed mounted
- Compact design - smallest 30 l/sec fan in class
- Well proven, centrifugal, filterless technology
- Integral magnetic anti-backdraught flap
- Thermally protected motor
- IPX4 rating
- TÜV approved
- Complies with Building Regulations
- 3 year warranty



Loovent

Highly reliable and powerful fan in a modular design for ease of installation and maintenance.

Loovent centrifugal fans are perfect where longer duct runs are required as they are powerful enough to overcome pressure loss. All Loovents are designed to provide extraction levels that comply with the latest Building Regulations.

The Loovent fan offers a choice of timer and humidity controls, ensuring efficient ventilation, which can be used with 100mm ducting. They provide the ideal solution for removing damp moist air, odours and airborne pollutants from en-suites, bathrooms and utility rooms.

The new LOOVENT eco range offers a full range of functionality including SAP Appendix Q approved dMEV versions - See page 76.



Models

Timer	Remote switch with run on timer adjustable between 5 and 45 minutes
Humidity Timer 2 Speed	Humidity sensor 40-95% RH activates low speed - pull cord boost with run on timer

Technical Data

Specification	Loovent TM 01	Loovent HT2S (H51)
Air flow m ³ /hr	111	60 / 111
Air flow l/sec	31	17 / 31
Fan type	Centrifugal	Centrifugal
Controls	Timer	Timer / Humidity
Mounting	Surface / Recess	Surface / Recess
	Wall / Ceiling	Wall / Ceiling
Sound Pressure dB(A)@3m	58	41 / 58
Power watts	30	30 / 70
Amps	2	2
Building Regulations ADF	Yes	Yes
Duct diameter (mm)	100	100
Voltage	230v / 1ph / 50Hz	230v / 1ph / 50Hz
Rating	IPX4	IPX4
Material finish	ABS	ABS
Weight (kg)	1.5	1.5
Dimensions (H x W x D) mm	162 x 181 x 112	162 x 181 x 112
Part No.	71766401	71766406



Dimensions (mm)

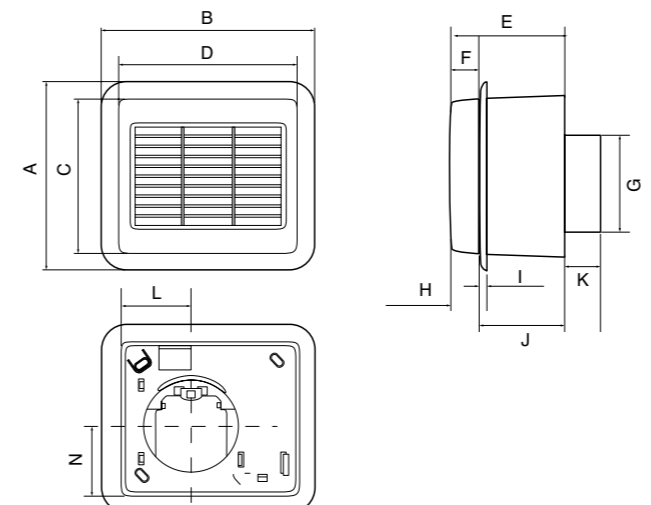

Model	A	B	C	D	E	F	G	H	I	J	K	L	N
Loovent	199	217	162	181	112	26	97	31-33	4-8	85	35	72	72

Performance

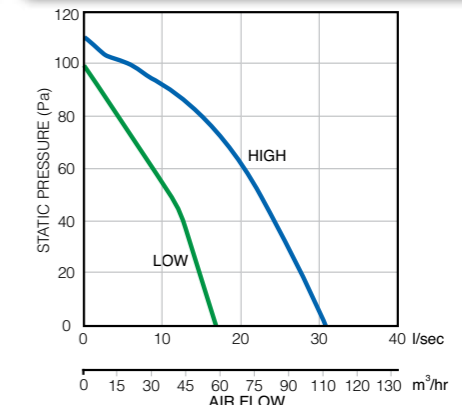

Controls and Accessories

A range of accessories including flexible and rigid ducting kits, controls and grilles are available.

Roomvent

Bathroom and utility room ventilation



Key Features

- Powerful centrifugal fan
- Flow rate up to 173 m³/hr
- Easy to fit airbrick size case
- Fixing pack supplied including bezel
- Recess or surface mounted to a wall or ceiling (bezel supplied)
- Integral magnetic backdraught flap
- Thermally protected motor
- IPX4 rating
- Complies with Building Regulations
- 3 year warranty



TIMER

Roomvent

Highly reliable and powerful centrifugal fan in a modular design for ease of installation and maintenance. The Roomvent is designed to provide extraction levels that comply with the latest Building Regulations.

Operated by adjustable timer, via a light or optional door switch. The Roomvent range comprises a selection of high performance fans for higher performance ventilation.

They are the ideal solution for removing damp moist air, odours and airborne pollutants from larger rooms. The motor, fan and plug-in timer are on a separate chassis for easy installation.



Models

Timer Remote Switch with timer which can be set to run on between 3 and 50 minutes

Wall Fan Timer Fan with timer to run on between 3 and 50 minutes



Technical Data

Specification	Roomvent T (07)	Roomvent WFT
Air flow m ³ /hr / l/sec	97 / 27	173 / 48
Fan type	Centrifugal	Centrifugal
Controls	Timer	Timer
Mounting	Wall / Ceiling	Wall / Ceiling
Sound pressure dB(A)@3m	50	60
Power watts	50	50
Amps	2	2
Building Regulations ADF	Yes	Yes
Duct diameter (mm)	100	100
Voltage	230v / 1ph / 50Hz	230v / 1ph / 50Hz
Rating	IPX4	IPX4
Material finish	ABS	ABS
Weight (kg)	3.2	3.2
Dimensions (H x W x D) mm	156 x 228 x 252	156 x 228 x 252
Part No.	71616301	71616501

Dimensions (mm)

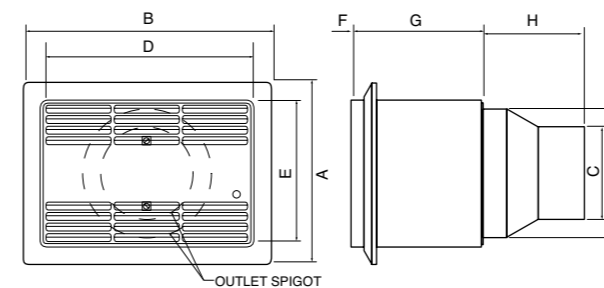

Model	A	B	C	D	E	F	G	H	I
Roomvent	196	270	100	228	156	27	115	110	140

Performance

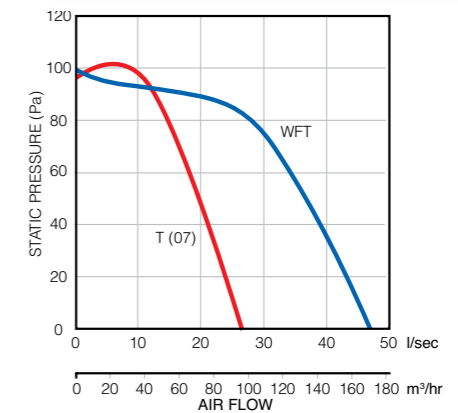

Controls and Accessories

A range of accessories including flexible and rigid ducting kits, controls and grilles are available.

Supervent

Kitchen ventilation

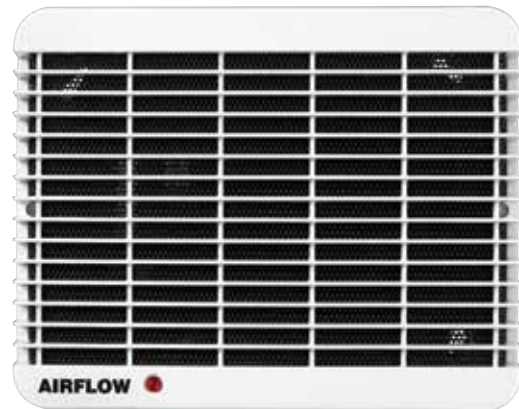

Key Features

- Powerful centrifugal fan
- Flow rate up to 260 m³/hr
- Two speed versions available
- Recess or surface mounted into a wall or ceiling (bezel supplied)
- Window fitting with optional window kit
- Easy to clean, integral, re-usable grease filter
- Thermally protected motor
- Easy to fit with 100mm outlet
- Demco approved
- Integral magnetic backdraught flap
- IPX4 rating
- Complies with Building Regulations
- 3 year warranty

Supervent range

Highly reliable and powerful centrifugal fan in a modular design for ease of installation and maintenance. The Supervent is designed to provide extraction levels that comply with the latest Building Regulations.

Supervent fans are small in size but big in performance. This range of powerful fans provides compact units that are ideal for almost any kitchen application. A

centrifugal fan that is simple to install and exceptionally versatile, delivering 150mm fan performance levels through 100mm ducting. These are the ideal solution for removing damp moist air, odours and airborne pollutants from kitchens.

The washable, built-in grease filter protects the motor in kitchen applications.



Models

2 Speed Basic	Manual control by remote switch
Timer	Timer can be set to run on between 5 and 30 minutes Speed adjustment possible on the unit
Humidity Pull Cord	Humidity sensor adjustable between 40 and 90% RH with pull cord override



Technical Data

Specification	Supervent SV6	Supervent SV6T	Supervent SV6HP
Air flow m ³ /hr	68 / 245	260	68 / 245
Air flow l/sec	19 / 68	72	19 / 68
Fan type	Centrifugal	Centrifugal	Centrifugal
Controls	2 Speed / Basic	Timer	Humidity / Pull Cord
Mounting	Wall / Ceiling / Two Room	Wall / Ceiling / Two Room	Wall / Ceiling / Two Room
Sound Pressure dB(A)@3m	38 / 59	59	38 / 59
Power watts	90	90	90
Amps	2	2	2
Building Regulations ADF	Yes	Yes	Yes
Duct diameter (mm)	100	100	100
Voltage	230v / 1ph / 50Hz	230v / 1ph / 50Hz	230v / 1ph / 50Hz
Rating	IPX4	IPX4	IPX4
Material finish	ABS	ABS	ABS
Weight (kg)	2.45	2.45	2.45
Dimensions (H x W x D) mm	200 x 250 x 143	200 x 250 x 143	200 x 250 x 143
Part No.	71908801	72357001	71939302

Dimensions (mm)

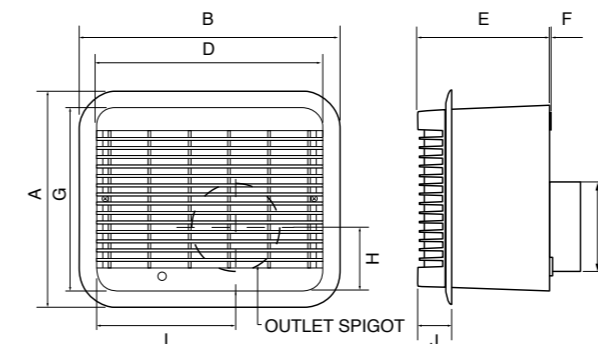

Model	A	B	C	D	E	F	G	H	I
Supervent	236	286	97	250	143	2	200	69	153

Performance

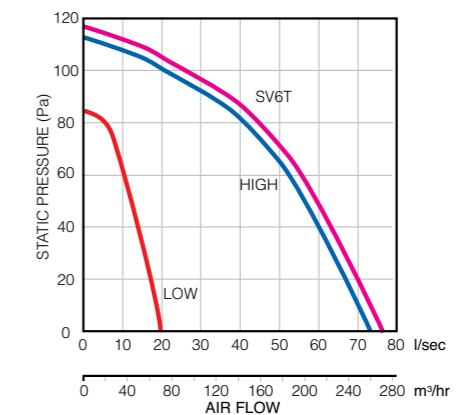

Controls and Accessories

A range of accessories including flexible and rigid ducting kits, controls and grilles are available.

Aventa In-Line

Bathroom, en-suite, utility room and kitchen ventilation

Key Features

- In-line mixed flow fans
- Flow rate up to 280 m³/hr
- Designed for ducted installations
- High pressure, low noise
- Compact and quiet in operation
- Two speed (normal and boost)
- Adjustable overrun timer version
- Access to monitor and impeller without dismantling ductwork
- Low watt motor from 21w
- IPX4 rating
- Complies with Building Regulations
- 3 year warranty



Aventa In-Line range

The Aventa range provides compact, quiet and powerful remote mounted ventilation for ducted installations. Available in high performance, two speed versions they are less bulky than larger in-line centrifugal fans and can be installed in loft spaces or service shafts for remote extraction.

With high flow / high pressure development characteristics they can be used with flexible ducting and flat duct systems to ensure compliance with Building

Regulations guidance ensuring installed performance and extraction conditions are met.

Combining two Aventa fans allows for even more powerful operation. Mounting in parallel (left hand image on facing page) doubles the air flow, whilst two fans in series (right hand image on facing page) leads to a doubling of the air pressure for longer duct runs.



Applications

- Basic** Basic remote switching
- Timer** Timer can be set to run on between 2 and 30 minutes



Technical Data

Specification	Aventa 100B	Aventa 100T	Aventa 125B	Aventa 125T
Air flow m ³ /hr*	145 / 187	145 / 187	220 / 280	220 / 280
Air flow l/sec*	40 / 52	40 / 52	61 / 78	61 / 78
Fan type	Mixed Flow	Mixed Flow	Mixed Flow	Mixed Flow
Controls	Basic	Timer	Basic	Timer
Mounting	In-Line	In-Line	In-Line	In-Line
Sound Pressure dB(A)@3m	27 / 36	27 / 36	28 / 37	28/37
Power watts	21 / 33	21 / 33	23 / 37	23/37
Amps	0.11 / 0.21	0.11 / 0.21	0.18 / 0.27	0.18 / 0.27
Building Regulations ADF	Yes	Yes	Yes	Yes
Duct diameter (mm)	100	100	125	125
Voltage	230v / 1ph / 50Hz	230v / 1ph / 50Hz	230v / 1ph / 50Hz	230v / 1ph / 50Hz
Rating	IPX4	IPX4	IPX4	IPX4
Material finish	ABS	ABS	ABS	ABS
Weight (kg)	1.5	1.5	1.5	1.5
Dimensions (H x W x D) mm	190 x 246 x 126	190 x 246 x 126	190 x 246 x 136	190 x 246 x 136
Part No.	9041085	9041086	9041087	9041088

* Air flow at free discharge

Dimensions (mm)

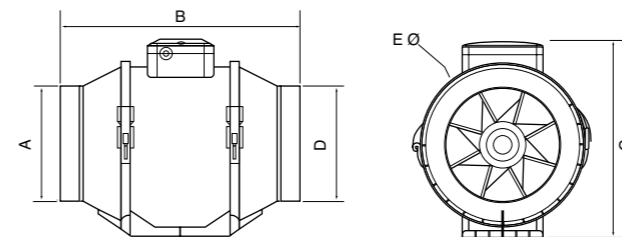

Model	A	B	C	D
AV100	96	246	190	126
AV125	123	246	190	136

Performance

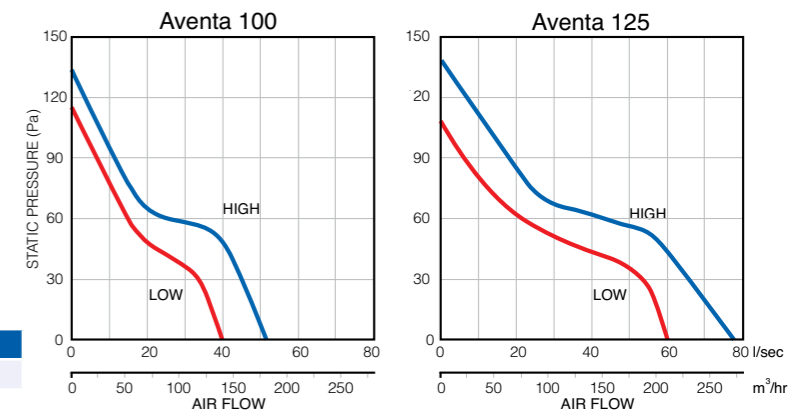

Double the flow - mount in parallel

Double the pressure - mount in series



Controls and Accessories

A range of accessories including flexible and rigid ducting kits, controls and grilles are available.

Aventa Shower Kit

Shower ventilation

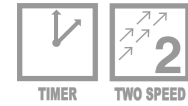

Key Features

- In-line mixed flow fan
- Flow rate up to 280 m³/hr
- Designed for ducted installations
- High pressure, low noise
- Compact and quiet in operation
- Two speed (normal and boost)
- Adjustable overrun timer version
- Access to motor and impeller without dismantling ductwork
- Low watt motor from 25w
- IPX4 rating
- Complies with Building Regulations
- 3 year warranty

Aventa Shower Kit

The Aventa range provides compact, quiet and powerful remote mounted ventilation for ducted installations.

Available in high performance, two speed versions they are less bulky than larger in-line centrifugal fans and can be installed in loft spaces or service shafts for remote extraction.

With high flow/high pressure development characteristics they can be used with flexible ducting and flat duct systems to ensure compliance with latest Building Regulations guidance ensuring installed performance and extraction conditions are met.



ALWAYS PULL FLEXIBLE DUCTING TAUGHT TO ENSURE INSTALLED PERFORMANCE AIR FLOW.



Applications

Timer Timer can be set to run on between 2 and 30 minutes

Contents of Kit

- 9041407** AVT 100T, 6m flex duct, ties, extract valve, external grille
- 9041408** AVT 100T, 6m flex duct, ties, halogen light, chrome and white grilles and external grille
- 9041406** AVT 125T, 6m flex duct, ties, extract valve, external grille



Technical Data

Specification	Aventa 100T Shower Kit	Aventa 100T Shower Kit with Light	Aventa 125T Shower Kit
Air flow m ³ /hr*	145 / 187	145 / 187	220 / 280
Air flow l/sec*	40 / 52	40 / 52	61 / 78
Fan type	Mixed Flow	Mixed Flow	Mixed Flow
Controls	Timer	Timer	Timer
Mounting	In-Line	In-Line	In-Line
Sound pressure dB(A)@3m	27 / 36	27 / 36	28 / 37
Power watts	21 / 33	21 / 33	23 / 37
Amps	0.11 / 0.21	0.11 / 0.21	0.18 / 0.27
Building Regulations ADF	Yes	Yes	Yes
Duct diameter (mm)	100	100	125
Voltage	230v / 1ph / 50Hz	230v / 1ph / 50Hz	230v / 1ph / 50Hz
Rating	IPX4	IPX4	IPX4
Material finish	ABS	ABS	ABS
Weight (kg)	1.5	1.5	1.5
Dimensions (H x W x D) mm	190 x 246 x 126	190 x 246 x 126	190 x 246 x 136
Part No.	9041407	9041408	9041406

* Air flow at free discharge

Dimensions (mm)

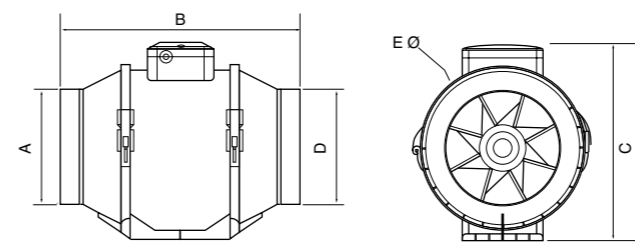

Model	A	B	C	D	E
AV100	96	246	190	96	126
AV125	123	246	190	123	136

Performance

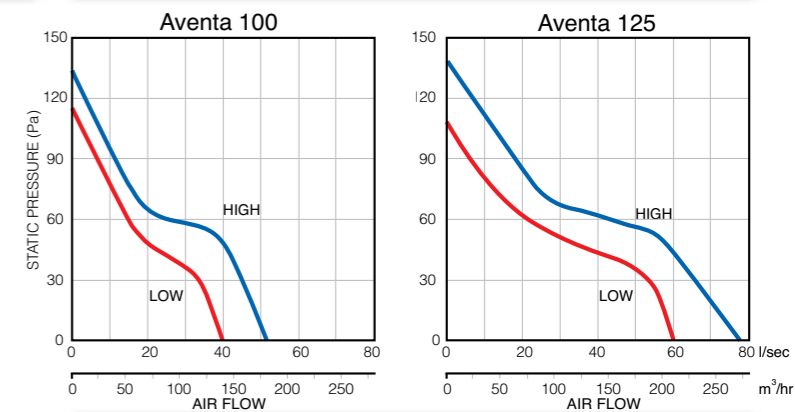

Controls and Accessories

A range of accessories including flexible and rigid ducting kits, controls and grilles are available.

Air Flow Solutions



Always Innovating

Our constant search for new and better ways to save energy, improve the indoor environment and provide you with high quality, reliable and easy to use products that contribute to a low carbon future continues.

visit: airflow.com

for the latest, products, data sheets, application advice and information

CI/SfB
(57)

Customer Services : 01494 560800

Technical Support : 01494 560950



AirflowDevelopments Ltd



AirflowDevelopments1



AirflowD

Call: 01494 560800

Visit: airflow.com



Airflow Developments Limited
Aidelle House, Lancaster Road,
Cressex Business Park,
High Wycombe, Buckinghamshire,
United Kingdom, HP12 3QP

E-mail: info@airflow.com
Telephone: +44 (0) 1494 525252
Facsimile: +44 (0) 1494 461073
airflow.com

© Airflow Developments Limited. Airflow Developments Limited reserve the right, in the interests of continuous development, to alter specifications without prior notice. All orders are accepted subject to our conditions of sale which are available on request



80000191 - Issue1 03/14