

Clip for fixing Cedral Click on a metal (aluminium or galvanised steel) supporting frame.

ARTICLE NUMBER: 4050868

TECHNICAL CHARACTERISTICS

Clip

Dimensions : 37 x 60 x 0,6 mm
Ø 4,2 mm hole for screw fixing
Material: stainless steel quality A2
Werkstoff 1.4310

Rivet

Dimensions : 4,0 x 8 mm
head diameter 8 mm
head thickness max 1,4 mm
Material : stainless steel quality A2
ISO 15983 A2

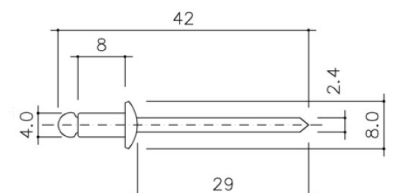
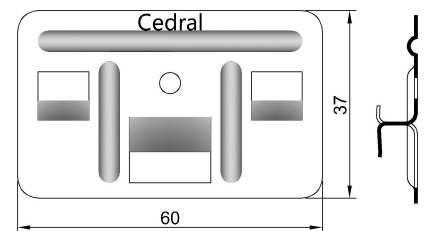
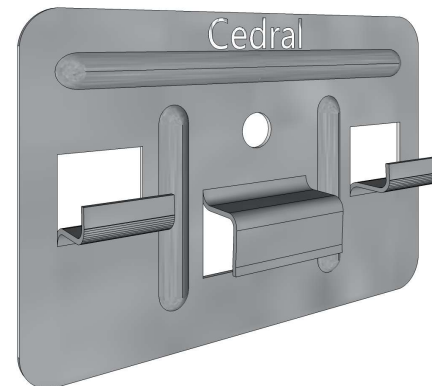

PACKAGING

Packaging: 250 clips per box, including 260 rivets

PROCESSING

Consult the application guidelines for Cedral Click fixed on metal sub-construction

Disclaimer

The information in this Material Information Sheet is correct at time issuing. However, due to our committed program of continuous material and system development we reserve the right to amend or alter the information contained therein without prior notice. Please contact your local Etex Facade Sales Organization to ensure you have the most current version.

All information contained in this document is copyrighted ©.

All figures contained in this document are illustrations and should not be used as construction drawings.

This information is supplied in good faith and no liability can be accepted for any loss or damage resulting from its use.

