

# RESTEC



roofing systems

## PRODUCT & SUPPORT CATALOGUE

FLEXITEC

GRPROOF

1020 PRO  
GRPROOF

PLATINUM  
FLEXITEC

ACRYL 475  
TEX

RESTRIMS



# Contents

PAGE **2**

Contact Us &  
Online Resources

PAGE **3**

**FLEXITEC**<sup>2020</sup>

Features  
Applications  
Installation  
Components  
Balcony Finishes

PAGE **8**

**PLATINUM**  
**FLEXITEC**

Features

PAGE **9**

**GRP**<sup>1010</sup>**PROOF**

Features  
Applications  
Installation  
Components

PAGE **13**

**RESTRIMS**

Introduction  
Range

PAGE **15**

**ACRYL**<sup>475</sup>**TEX**

Features  
Applications

PAGE **16**

Applications &  
Accessories

PAGE **17**

**RESTEC**  
roofing systems





Technical Support  
Product Demonstrations  
Comprehensive Training  
Social Networking

# Contact & Support

As genuine UK manufacturers who have developed liquid roofing and GRP products for over 35 years, you can rest assured our support and services are unrivalled in the merchant market, and we pride ourselves on providing instant answers and assistance for any enquiry.

Department	Tel	Email
Sales & Orders	01352 736 353	orders@restecroofing.co.uk
Technical	01352 746 133	technical@restecroofing.co.uk
Logistics	07775 921 913	logistics@robertsmanufacturing.co.uk
Enquiries	01352 748 610	enquiries@restecroofing.co.uk

 **CALL US 0845 4504 193**

 **Unit 25, Castle Park Industrial Estate, Flint, Flintshire, CH6 5XA**

 **www.restecroofing.co.uk**

## About Us

Restec Limited is part of the Roberts Group a long-established and leading UK manufacturer of liquid applied roofing systems. Restec's mission is to bring these quality, high-performance roofing products into the building merchant market. All our systems use tried-and-tested formulations engineered for optimum roofing performance across a range of applications and conditions.



## Why Choose Us?

### Services

- ✓ Manufacturing
- ✓ Hands On Training
- ✓ Social Networking
- ✓ In Depth Demonstrations
- ✓ Technical Advice
- ✓ UK Leading Experts
- ✓ On Site Support
- ✓ Online Tools







# FLEXITEC

## Multi-surface GRP roofing system

One Resin.  
Countless possibilities

**Flexitec 2020** is a flexible, single resin GRP system that has revolutionised the liquid roofing industry with full overlay and new deck capabilities. Combining the best elements of fibreglass with the versatility of overlay systems, no other flat roof system performs at this level across so many applications.

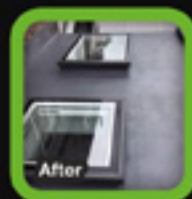

10m<sup>2</sup> **FLEXITEC**  
ROOF KIT!

Everything in  
one box! **pg6**



### WHY CHOOSE **FLEXITEC**?

Unlike traditional fibreglass systems, **Flexitec 2020** isn't just limited to timber deck. The system can also be used to coat existing surfaces such as felt, concrete, asphalt, single-ply plus many more. This means that old roofs can often be retained and over-coated, without the need for stripping. No matter the size, shape or complexity, **Flexitec 2020** provides a seamless, tough and flexible membrane for any roof or balcony area.

- ✓ Highly versatile and capable of coating virtually all common surfaces.
- ✓ Ideal combination of flexibility and toughness.
- ✓ Only 30-60 mins cure time per coat - genuinely rapid installations.
- ✓ BROOF(t4) Fire Rating for unrestricted use.
- ✓ 20 Year Materials Guarantee accessible to trained installers.
- ✓ LABC Registered Detail for assured compliance with building regulations.



GO TO OUR WEBSITE



# 2020 FLEXITEC Application

Depending on the type, roughness and porosity of the surface to be coated, the priming requirements and amount of material required can vary. The table below outlines suitable **substrates**, **primers** and typical **coverage rates**.

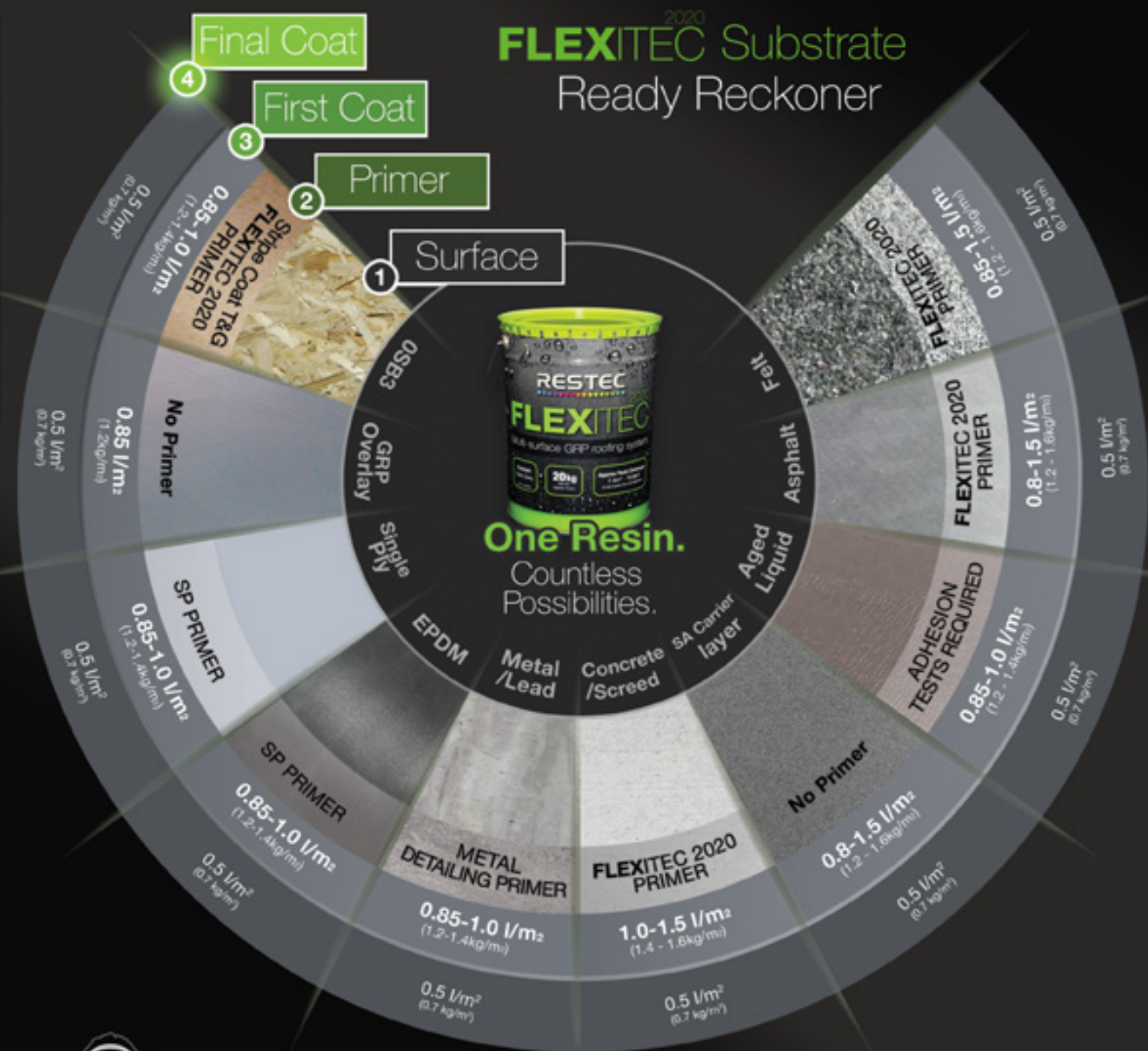

**\*Adhesion tests** maybe required for certain substrates to confirm preparation & priming requirements. All coverage rates are indicative only and subject to confirmation on the site. We recommend adding a minimum 10% wastage to the coverage rates shown above.







Before starting any roof, remember the **4 C'S** to ensure a successful installation:

**COVERAGE:** Know how much material to use

**CATALYST:** Know how much powder hardener to use

**CONSOLIDATION:** Ensure matting is fully worked into resin

**CARE:** Take time to follow guidance to ensure a high quality finished job

## 1 Assess



**Assess the substrate:** Ensure the substrate is in an adequate condition with moisture readings no higher than **20%**. If in doubt take a core sample & perform an adhesion test.

## 2 Deck



**Install decking:** If the substrate is unsuitable and/or adhesion test has failed, you must remove back to bare joists & install OSB3 18mm T&G boards in accordance with manufacturer's recommendations.

## 3 Trim



**Apply RESTRIMS:** If existing edges are in sound condition you can encapsulate them following step 5&6. For a cleaner look **RESTRIMS** should be installed around perimeter.

## 4 Prime



**Prime:** The entire roof using the appropriate primer listed on page 4 "Application". If installing onto OSB3 all joints must be treated in accordance with the Application Manual.

## 5 1<sup>st</sup> Coat



**1<sup>st</sup> coat:** Apply two thirds of the required amount of resin to the substrate, roll out 225g/m<sup>2</sup> CSM and work thoroughly with your roller. Apply the final third of resin over the top and ensure a pinhole-free surface.

## 6 2<sup>nd</sup> Coat



**2<sup>nd</sup> coat:** Once first coat has cured, an additional layer of resin should now be applied over the entire roof. Achieving a superior finish backed by **20-year guarantee** for trained installers.



### DON'T FORGET!

You can find powder hardener addition charts on every Restec tin and the Restec Mixing Bucket.



Download  
**Manual**



## 2020 **FLEXITEC RESIN**

Main liquid component used for both the base & top coats.

Pack Size	Coverage	Code
20kg	7.4 - 10.6m <sup>2</sup> Two coat application	162003
10kg	3.7 - 5.3m <sup>2</sup> Two coat application	162002

## 2020 **FLEXITEC PRIMER**

A universal primer for most surfaces including felt, asphalt, concrete, PVC single ply & timber.



Pack Size	Coverage	Code
5kg	17-26m <sup>2</sup>	158105

## **POWDER HARDENER**

Added to Flexitec 2020 Resin & Primer to trigger curing process.



Pack Size	Code
1kg	102013

## **RESTEC 225g/m<sup>2</sup> CSM**

Chopped strand mat reinforcement embedded in the first coat.



Pack Size	Coverage	Code
~120m <sup>2</sup>	111m <sup>2</sup>	104111
30m <sup>2</sup>	28.8m <sup>2</sup>	104322
15m <sup>2</sup>	14.4m <sup>2</sup>	104321

## 2020 **FLEXITEC 10M<sup>2</sup> ROOF KIT**



Pack	Contains	Code
10m <sup>2</sup> Kit	Materials & tools for up to a roof to 10m <sup>2</sup>	101162

## 2020 **FLEXITEC DETAILER**

A flexible, fibre-reinforced resin for use on roof detailing, inaccessible areas, levelling & minor repairs.



Pack Size	Coverage	Code
5kg	2-3m <sup>2</sup>	162011

## **METAL DETAILING PRIMER**

A single pack, fast drying metal primer in a resealable 250ml tin.



Pack Size	Coverage	Code
6x 250ml	10-30m <sup>2</sup> per box of 6	122067

## **SP PRIMER**

A moisture curing primer for PVC, TPO & EPDM single - ply.



Pack Size	Coverage	Code
1ltr	12-15m <sup>2</sup>	122006

## **ACETONE**

Used for cleaning tools & as a pre-surface treatment for some substrates.



Pack Size	Code
5ltr	109106
1ltr	109026

## **WINTER ACCELERATORS**

Low temperature additive to allow in installations down to 1°C.



Pack	Coverage	Code
Resin	1 pack per 10kg Resin	162005
Primer	1 pack per 5kg Primer	158106





# Balcony System

## Balcony & Walkway Finishes

**FLEXITEC 2020** offers a seamless, durable and attractive finish for balconies, walkways and terraces. When used in conjunction with the **FLEXITEC 2020** Balcony Sealer, a high-performance PMMA finishing resin, the system provides an extremely hard wearing finish that can accommodate heavy foot traffic and balcony usage.

### NOT SURE ON QUANTITY?

Contact us for  
product code,  
pack sizes and  
coverage rates  
**0845 4504 193**



**1 QUARTZ SAND AGGREGATE**  
with **FLEXITEC BALCONY** - Sealer Light Grey

**2 QUARTZ SAND AGGREGATE**  
with **FLEXITEC BALCONY** - Sealer Dark Grey

**3 QUARTZ SAND AGGREGATE**  
with **FLEXITEC BALCONY** - Sealer Clear

**4 BARN OWL BLEND AGGREGATE**  
with **FLEXITEC BALCONY** - Sealer Clear

**5 VINEYARD BLEND AGGREGATE**  
with **FLEXITEC BALCONY** - Sealer Clear

**6 HILLSIDE BLEND AGGREGATE**  
with **FLEXITEC BALCONY** - Sealer Clear

**7 BAYSIDE BLEND AGGREGATE**  
with **FLEXITEC BALCONY** - Sealer Clear

**8 HARVEST BLEND AGGREGATE**  
with **FLEXITEC BALCONY** - Sealer Clear

**9 MIST BLEND AGGREGATE**  
with **FLEXITEC BALCONY** - Sealer Clear

**10 GREEN MINERAL SLATE CHIPPINGS**

**11 BLUE MINERAL SLATE CHIPPINGS**

**MOST CUSTOMERS WILL PREFER LIGHT GREY FLEXITEC 2020 BENEATH THE GRIT AS IT HELPS SHOWCASE THE AGGREGATE COLOUR.**

SAMPLES ARE AVAILABLE FROM RESTEC ON REQUEST.





# RESTEC PLATINUM FLEXITEC

BBA approved liquid roofing system

## Advanced liquid roofing system

**Flexitec Platinum** is a BBA Approved multi-surface GRP roofing system, that offers advanced liquid technologies exclusively available to trained Platinum Installers via Restec Partner Merchants. Much like our standard **Flexitec 2020**, our Platinum system can be used with full overlay and new deck capabilities.

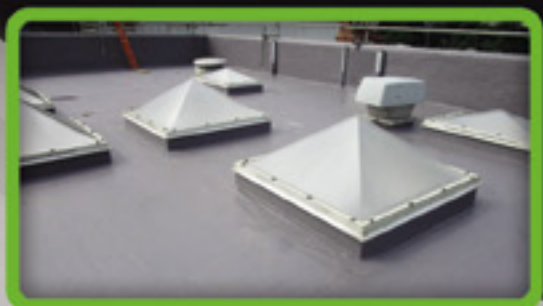

## WHY CHOOSE <sup>PLATINUM</sup> FLEXITEC?

BBA Certified (Certificate No 20 /5833) flexible GRP system, featuring a minimum 25 Year Durability Rating and backed by Restec's Technical Support team. **Flexitec Platinum** offers an Enhanced Platinum Guarantee tailored to meet the needs of the client including surveys and specifications as required.

- ✓ BBA approved liquid applied system.
- ✓ Supported by Restec's trusted Platinum System guarantee.
- ✓ Minimum 25 Year lifespan.
- ✓ BROOF(t4) fire rated for unrestricted use on flat roofs.
- ✓ Approved for use on zero fall roof applications in accordance with Certificate No. 20/5833.
- ✓ Certified to resist root penetration, when used for "Green Roof" applications.

Email us at [technical@restecroofing.co.uk](mailto:technical@restecroofing.co.uk)





# GRP ROOF

High performance fibreglass system

The ultimate  
flat roof protection.

Specially formulated to provide lasting waterproof protection for roofs and balconies, the GRP Roof 1010 System offers unrivalled performance at exceptional value.



## WHY CHOOSE **GRP ROOF** 1010?

**GRP Roof 1010** brings innovative liquid roofing technology into the merchant market. Engineered for optimum roofing performance, the system offers seamless waterproofing for all your flat roofing needs regardless of size or complexity.

- ✓ 20 Year Guarantee on materials.
- ✓ Engineered for optimum roofing performance.
- ✓ Flexible technology for reduced risk of cracking.
- ✓ Excellent inter-coat adhesion, no flaking or delamination.
- ✓ BROOF (t4) Fire Rating for unrestricted use.
- ✓ LABC Registered Detail for assured compliance with building regulations.



GO TO OUR WEBSITE



## Seamless Waterproofing For Any Flat Roof

Large or small, simple or complex **GRP**ROOF<sup>1010</sup> is ideal for waterproofing all types of flat roof and balcony areas.



## 12 SUITABLE APPLICATIONS



### ROOF OVER 50m<sup>2</sup>?

Or longer than 10 linear meters  
require an E280 expansion trim.  
For more details please see  
**RESTRIMS** on page 14.

- |                    |                      |                  |                 |
|--------------------|----------------------|------------------|-----------------|
| 1. Balconies       | 4. Bay windows       | 7. Orangeries    | 10. Dormers     |
| 2. Flat roof areas | 5. Vertical cladding | 8. Garages       | 11. Box-gutters |
| 3. Steps           | 6. Terraces          | 9. Pitched roofs | 12. Sedum roofs |







Before starting any roof, remember the **4 C'S** to ensure a successful installation:

**COVERAGE:** Know how much material to use

**CATALYST:** Know how much liquid hardener to use

**CONSOLIDATION:** Ensure laminate is consolidated until transparent

**CARE:** Take time to follow guidance to ensure a high quality finished job

## 1 Install Decking



**Install decking:** OSB3 18mm T&G boards should be installed to provide a suitable surface for **GRP<sup>PROOF</sup> 1010** in accordance with the manufacturer's guidelines.

## 2 Trim



**Apply RESTRIMS:** The appropriate RESTRIMS should be installed around perimeter of the roof. Please refer to the **RESTRIMS pg14** for further guidance.

## 3 Preparation



**Preparation:** Pre-cut the 450g CSM over the entire roof area, ensuring each run overlaps the previous by a minimum 50mm (feathered edge over straight). Use taping mat to seal **RESTRIMS** to the deck, trim joints and all other details.

## 4 Details



**Details:** Mix a small batch of resin to seal trims to the deck & complete details. Using your application roller & brush to dress the CSM into place. Ensure you consolidate using paddle roller.

## 5 Laminate



**Laminate roof:** Working in m<sup>2</sup> sections apply resin with hardener to the deck, roll out pre-cut CSM & apply more resin on top. Consolidate using paddle roller until the laminate looks transparent.

## 6 Top Coating



**Top coating:** Sand entire roof using 40 grit sandpaper. Wipe clean with acetone. **RESTRIMS** & roof can be covered with catalysed **GRP<sup>PROOF</sup> 1010**. Top coat at a rate of 0.6kg per m<sup>2</sup>.



### DON'T FORGET!

You can find catalyst addition charts on every Restec tin and the Restec Mixing Bucket.



Download  
**Manual**



1010  
**GRP**ROOF  
BASE RESIN



Pack Size	Coverage	Code
20kg	16m <sup>2</sup>	160102
10kg	8m <sup>2</sup>	160101

1010  
**GRP**ROOF  
TOP COAT



Pack Size	Coverage	Code
20kg	30m <sup>2</sup>	160104
10kg	15m <sup>2</sup>	160103

CSM **FIBREGLASS** 450g/m<sup>2</sup>

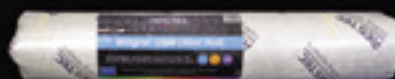

Pack Size	Coverage	Code
Bulk Pack	77m <sup>2</sup>	104306
30m <sup>2</sup> Roll	28.8m <sup>2</sup>	104303
15m <sup>2</sup> Roll	14.42m <sup>2</sup>	104302

CSM **FIBREGLASS** 600g/m<sup>2</sup>

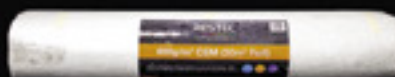

Pack Size	Coverage	Code
Bulk Pack	58m <sup>2</sup>	104313
30m <sup>2</sup> Roll	28.8m <sup>2</sup>	104312
15m <sup>2</sup> Roll	14.42m <sup>2</sup>	104311

LIQUID  
CATALYST



Pack Size	Code
5kg	102006
1kg	102005

1010  
**GRP**ROOF 10m<sup>2</sup>  
ROOF KIT



Pack Contains	Code
10m <sup>2</sup> Kit Materials for waterproofing a roof up to 10m <sup>2</sup>	101160

GRP  
TOOLING KIT



Pack Contains	Code
Kit Application rollers, paddle rollers, brushes and more	109163

TAPING MAT

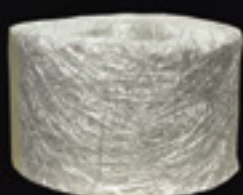

Pack Size	Code
Small 18 LM	104005
Large 110 LM	104004

ACETONE



Pack Size	Code
5 ltr	109106
1 ltr	109026

CATALYST  
DISPENSER



Pack Size	Code
80ml	109102

15KG SLATE  
CHIPPINGS



Pack Colour	Code
Blue mineral	109049
Green mineral	109046

## Extra Additions:

**GRP**ROOF BASE COAT WINTER ACCELERATOR

**GRP**ROOF TOP COAT WINTER ACCELERATOR

**GRP**ROOF FINISHING TISSUE

Pack Size	Code
300g	160111
150g	160112
100 lm	107046







## RES TRIMS

1. Drip Trim
2. Wall Fillet Trim
3. Cover Flashing
4. Flat Trim
5. Raised Edge Trim
6. Corner Piece

## TRIM Installation



**Battens installed**  
to perimeter of the  
roof.



**Continuous bead**  
of adhesive where  
trim meets batten.



**18mm clout nails**  
fixed every 100 -  
150mm centres.



**Trims can be cut**  
with snips or angle  
grinder.



**Minimum 50mm**  
overlap when  
bonding trims.

## PRE-FORMED ACCESSORIES

### THROUGH WALL OUTLET

Size	Code
150mm x150mm length 600mm	155067
100mm x100mm length 600mm	155068



### PIPE COLLAR

**Size**  
110mm  
**Code**  
155069

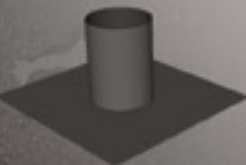

### FLAT ROOF OUTLET

**Size**  
110mm  
**Code**  
155070



## CORNER TRIMS

### CORNER (C1)

(a.k.a Universal External corner)

Individual

**Code**  
157109



### EXTERNAL (C3)

(for use with Wall Fillet  
D260 Trim)

Individual

**Code**  
157132

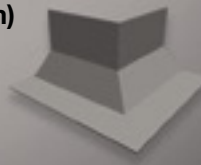

### INTERNAL (C3)

(for use with Wall Fillet  
D260 Trim)

Individual

**Code**  
157133







## Premium GRP Roof Trims

(Supplied as a Pack of 10)

**DRIP 65mm (A170)**

Length 3m

**Code:** 157112

**DRIP 85mm (A200)**

Length 3m

**Code:** 157113

**UPSTAND FASCIA 100mm (B230)**

(a.k.a Raised Edge) Length 3m

**Code:** 157114

**UPSTAND FASCIA 120mm (B260)**

(a.k.a Raised Edge) Length 3m

**Code:** 157115

**WALL FILLET (D260)**

Length 3m

**Code:** 157116

**LONG LEG WALL FILLET (D300)**

Length 3m

**Code:** 157123

**COVER FLASHING (C100)**

(a.k.a Simulated Lead) Length 3m

**Code:** 157105

**EXPANSION (E280)**

Length 3m

**Code:** 157117

**FLAT SHEET - 300mm (F300)**

Length 3m

**Code:** 157122

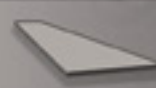
**FLAT SHEET - 300mm ROLL (F300)**

Length 20m roll

**Code:** 157107

**FLAT SHEET - 600mm ROLL (F600)**

Length 20m roll

**Code:** 157108

**SHORT INTERNAL ANGLE (AT170INT)**

Length 3m

**Code:** 157118

**LONG INTERNAL ANGLE (AT220INT)**

Length 3m

**Code:** 157120

**SHORT EXTERNAL ANGLE (AT150EXT)**

Length 3m

**Code:** 157119

**LONG EXTERNAL ANGLE (AT275EXT)**

Length 3m

**Code:** 157121

**LEAD ROLL (ER35/40)**

(a.k.a Rolled Rib Roofing Trim) Length 3m

**Code:** 157130

**STANDING SEAM (ER15)**

Length 3m

**Code:** 157131





## Acrylex 475 Repair System

Size: 5kg Code: 168001

Size: 20kg Code: 168002

**RESTEC**  
roofing systems

# 475 ACRYLTEX

## One coat roof repair system with fibres

**Ideal solution for  
quick & easy roof repairs**

**Ideal for carrying out fast repairs to flat  
roofs, pitched roofs and gutters.**

Suitable substrates include weathered  
asphalt and bituminous surfaces,  
concrete, brickwork, fibreglass, felt, metal  
(galvanised and ferrous).



## WHY CHOOSE **ACRYLTEX**<sup>475</sup>?

**AcrylTex 475** is an advanced acrylic containing fibres for extra strength and durability. The system requires no training prior to application, is ready to use straight out of the tin and impervious to rainfall immediately after application.

- ✓ Waterproofs instantly
- ✓ Only one coat needed for fast repairs
- ✓ Ready to use straight out of the tin  
- no catalysing or mixing components required
- ✓ Contains fibres that provide extra strength for  
the coating and interlace to cover small gaps
- ✓ Ideal for maintenance work
- ✓ Rainfall after application has  
no adverse effect



GO TO OUR WEBSITE



# Application Tools & Stock Additions

**UPDATES AVAILABLE!**  
On our social media.



**RESTEC**  
ROOFING SYSTEMS

Provide a **full range** of application tools and sundries.

The following is a selection of some of the key items

**RESTEC**  
ROOFING SYSTEMS

## MIXING BUCKET

Code 109195

## APPLICATION TOOLS

### BLUE STRIPE ROLLER SLEEVE



Measure	Code
100mm (4")	109181
175mm (7")	109183
250mm (10")	109185



### ROLLER PUSH FIT FRAME

Measure	Code
100mm (4")	109180
175mm (7")	109182
250mm (10")	109184

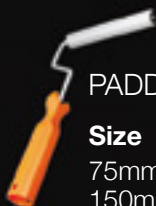

### PADDLE ROLLER

Size	Code
75mm	109013
150mm	109014
225mm (diameter 21mm)	109120
225mm (diameter 45mm)	109121

### DETAILING BRUSHES



Measure	Code
50mm Detail Brush (Pack of 12)	109023



Measure	Code
25mm Detail Brush (Pack of 12)	109024

### PRO EXTENDABLE POLE WITH SCREW FIT HEAD



Measure	Code
1.2 - 2.4m (4-8') (Inc. push-fit adaptor)	109186

## EXTRA TOOLS

### INFRA-RED "LASER" THERMOMETER



Code
109099

### TRIMMING KNIFE



Code
109017

## SA CARRIER LAYER

### 15.M<sup>2</sup> ROLL



Code
107117

### PRIMER



Code
107113





# Support Services



## Stock delivered from

**RESTEC**  
roofing systems

A variety of **merchandise, literature** and **point of sale** is available to optimise product displays, increase awareness and bolster sales.

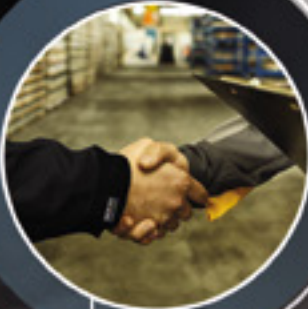

## Initial welcome to

**RESTEC**  
roofing systems

Meet a member of the **Restec** team to discuss systems, services and stocking requirements.



## Staff training by

**RESTEC**  
roofing systems

Staff training ensures **increased knowledge** on the entire **Restec range**, covering tips and tricks on stocking and promoting each system correctly whilst also covering basic installation guidance.



Online Resources







# Every step of the way!

## Product experience day's



**Product experience days** help raise awareness whilst showcasing installation guidance. Backed by **posters, flyers** and **social media** advertisement helps encourage attendance.

## Technical support by



**Restec's** dedicated **Technical Support** service is on hand to answer your questions 5 days week. We provide instant answers so you can help your customers whilst they wait.



## Contractor training by



Comprehensive training carried out by **Restec's leading GRP and liquid roofing experts**, you will learn best-practice installation and application techniques including one-to-one guidance and hands on experience. Trained contractors will receive a unique trainer ID and certification to support **Restec's 20 Year Guarantee on materials**.





**RESTEC**  
roofing systems

Restec Limited

Unit 25, Castle Park Industrial Estate, Flint, Flintshire, CH6 5XA

0845 4504 193

[www.restecroofing.co.uk](http://www.restecroofing.co.uk)

Part of  
**Roberts  
Group**



**7NFRC**  
LEADING ROOFING EXCELLENCE



Follow us online @restecroofing

