

# SUPAFIX CAVITY CLOSER FIRE RATED

Uniclass L3272:P7114	EPIC F642:X725
C/SFB (31.9)	Hn6

OCT 2021

## Features

- » Easy to install
- » Economical
- » Weather resistant
- » Reduces risk of condensation, mould and moisture migration across the cavity
- » Complies with Part L Building Regulations when the window is installed with a minimum set back of 30mm
- » No ties required – simply nail to blocks
- » Overcomes cavity width variations
- » Up to one hour fire integrity

## Standards

- » ISO 9001 ..... Yes
- » BBA Certificate ..... Yes
- » Part L Compliance 2010 .... Yes
- » Robust Detail BR262 ..... Yes
- » BS EN 13163 ..... Yes

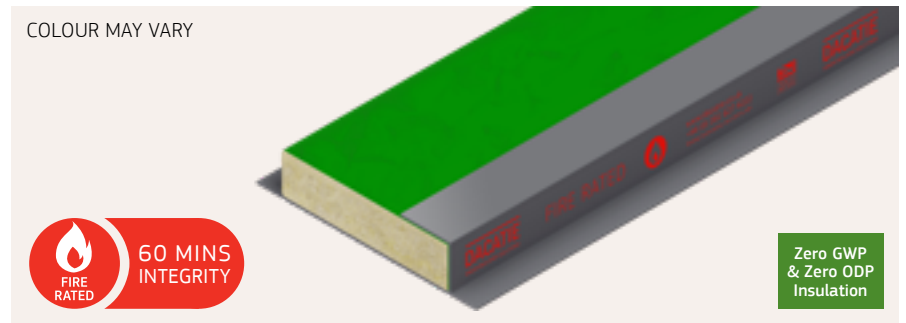

## Product Description

Supafix Fire Rated (SFR) non-combustible insulated cavity closers are the economical way to achieve Building Regulations compliance and 1 hour fire integrity when closing cavities around window and door openings. SFR can be used with all types of door and window openings including timber, PVCu and aluminium. It overcomes the traditional difficulties of closing cavities at wall openings by providing a simple and efficient solution to thermal bridging. It is available in a range of sizes to fit cavity widths 50–100mm with sufficient design flexibility to tolerate rogue cavity widths, thus reducing time and cost on site.

## Product Function

Supafix Fire Rated is recommended for closing the cavity around window and door openings in second fix installations when a frame former is not required. Suitable for use in conventional brick & block, and timber frame constructions. SFR is simply cut to length, eliminating the need for cut blocks, bricks or special reveal blocks.

## Installation/ Application Detail

- » SFR is cut to the height or width of the cavity opening and then push fitted into the cavity.
- » Slight cavity width variations can be overcome by applying light pressure. For this purpose a margin of insulating material projects from the PVCu encasement to allow firm friction fit. In cases of extreme cavity width variation, this projecting insulation can be trimmed on site with a knife to allow insertion into the cavity.
- » For check reveal version a mechanical fixing should always be used to secure the flange to the internal blockwork (i.e. nail to the blockwork or similar).
- » The ribbed surface of the SFR cavity closer will accept wet plaster or plasterboard on dabs. Best practice would suggest priming the closer surface prior to finishing.

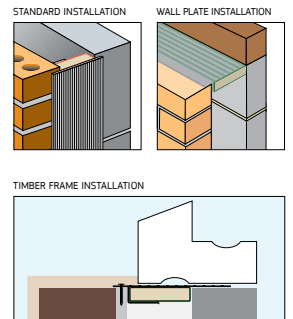

# SUPAFIX CAVITY CLOSER FIRE RATED

## Specification

- » Fire Rated..... Yes
- » Check Reveal Available..... Yes
- » 1st Fix..... No
- » 2nd Fix..... Yes
- » Min Cavity Width (mm) ..... 50
- » Max Cavity Width (mm) ..... 100
- » Lengths ..... 2.4m
- » Thermal Conductivity (K Value  $\lambda$  90/90) = 0.036 W/mK
- » Thermal Resistance (R Value) = 0.694 m<sup>2</sup>K/W

## Order Codes

STANDARD:

SFR + cavity width in mm

CHECK REVEAL:

CSFR + cavity width in mm

## Storage & Packaging

Dacatie's closers are supplied in polythene sleeves that are designed for transporting and protecting the products. It is not recommended that the packs are stored in direct sunlight. When storing the Cavity Closers for longer periods of time it is recommended the product should be stored indoors, or under cover.

## Technical Data

PROFILE:

Non water absorbing rigid PVCu extruded profile (colour may vary).

INSULATION:

Weather resistant polythene with encapsulated 140kg/m<sup>3</sup> mineral wool (colour may vary).

FLUSH/STANDARD:

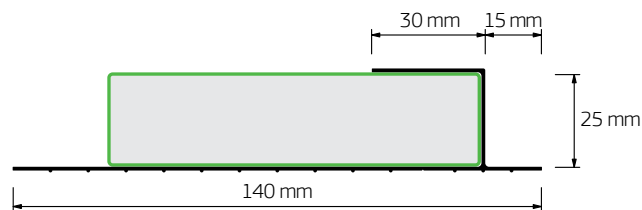

CHECK REVEAL:

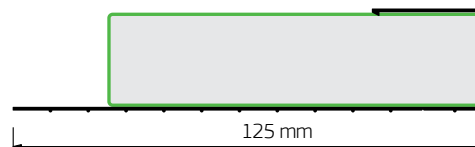

## SUPAFIX CAVITY CLOSER FIRE RATED

### Building Regulations

Building Regulation (Part L) compliance is important. The path of minimum thermal resistance through the closer must be at least 0.45 m<sup>2</sup>K/W, which Dacatie closers exceed, as stipulated in robust details "limited thermal bridging and air leakage" when the window is installed with a minimum set back of 30mm.



### Fire Resistance

Fire resistance testing of Supafix Fire Rated cavity closers was carried out at Warrington Fire Research. The test utilised the general principles for fire resistance testing given in BS476: Part 20: 1987 "methods for determination of the fire resistance elements of construction" to determine performance under this criteria.

Supafix Fire Rated provides a minimum of 30 minutes resistance in regards of fire integrity and 60 minutes in regards of fire insulation.

### Fire Statement

Dacatie fire rated cavity closers have been tested in vertical and horizontal positions. The tests carried out indicate the fire integrity performance relating to the cavity closer component itself. The fire barrier performance will depend on the structural stability and fire integrity of the surrounding building.

When specifying, it must be ensured that all of the construction elements which make up the internal or external leaf of the wall are compatible with a cavity fire barrier, in terms of the length of fire integrity and the insulation required. It is particularly important to look into any deflection or distortion which could occur, causing gaps to form between the construction and the fire barrier, as this could compromise the position and therefore functionality of the installed fire barrier.

Dacatie cannot accept liability for the failure of a cavity fire barrier if it has been installed or deployed in an incorrect manner. This includes where deflection or distortion has occurred, causing gaps to appear around the fire barrier. The correct specification and installation of the barrier is of paramount importance to effectiveness and liability in the case of fire, and barriers must be fitted according to the manufacturer's guidelines.

### Specification Statement

The insulated cavity closer around window and door openings is to be a Dacatie product, supplied by Quantum Profile Systems Ltd, Salmon Fields, Royton, Oldham, OL2 6JG and installed in accordance with the manufacturer's recommendations.

# SUPAFIX CAVITY CLOSER FIRE RATED

## Sustainability

- » ISO 14001 ..... Yes
- » GWP ..... <5
- » ODP ..... Zero
- » Green Guide ..... B

## Environment

Dacatie's closer insulation has no CFC's, HCFC's in the manufacturing process and represents no known threat to the environment. Dacatie's closer insulation has a low impact on the environment and is classified as zero ODP and zero GWP.

## Health & Safety

Dacatie has an approved Health and Safety Policy and is committed to working and supplying products safely. A Dacatie COSHH data sheet is available and can be downloaded from the Dacatie website [www.dacatie.co.uk](http://www.dacatie.co.uk).

D-0019/#01/2019-10

## GWP levels less than 5, ODP Zero and Green Guide A+

Dacatie Insulated Cavity Closers offer different insulation materials with the option of GWP levels of <5, ODP levels of zero and Green Guide ratings of A+.

## BREEAM (and Code for Sustainable Homes)

BRE has advised that Insulated Cavity Closers as a product do not gain Green Guide credits, since they do not enhance BREEAM scheme categories.



## Recycled Content

All Dacatie Cavity Closers are produced with a recycled content of approximately 50%. The materials used predominately comprise a blend of post-consumer and/or post-industrial recycled material.

The insulation materials used can typically contain a recycled content of approximately 5%. Colour may vary.

## Cold Bridging

The problems of cold bridging are recognised in the Part L Building Regulation 2010 and Scottish Building Regulations 2004. Dacatie Insulated Cavity Closers are used to overcome thermal loss that occurs around unprotected cavities and reveals. Thermal loss can result in problems of condensation, staining and mould growth at the reveals of these openings.

Prolonged exposure to such factors will lead to a deterioration of the internal plaster and paint work. The use of Dacatie Cavity Closers will help to prevent the occurrence of such factors.

