

**FORGEFAST**  
ELITE PERFORMANCE SCREWS  
COUNTERSUNK DECKING



## DESCRIPTION

- Elite performance self-drilling & low-torque decking screws
- Proprietary self-drilling thread - no pilot hole needed
- Proprietary self-drilling thread removes the need to pre-drill and reduces the probability of splitting
- A deep Torx® compatible head ensures reduced cam-out, higher torque levels and a firmer drive
- Recessed under-head ribs provide superb countersinking
- Elementech 2000 surface coating provides corrosion resistance up to twice as long as standard decking screws
- Super sharp tip gives immediate bite from the first turn
- Flexes to 35° reducing likelihood of screw shearing
- Available in Green or Tan

## APPLICATIONS

- For fixing into softwood or hardwood decking

## CE APPROVED



- Tested to European inspection and certification standards EN 14592:2008+A1:2012

## PRODUCT OVERVIEW

| Code       | Diameter (mm) | Length (mm) | Head        | Recess | Finish             | Tub Qty |
|------------|---------------|-------------|-------------|--------|--------------------|---------|
| FFDS4550GT | 4.5           | 50          | Countersunk | Torx®  | Elementech • Green | 600     |
| FFDS4560GT | 4.5           | 60          | Countersunk | Torx®  | Elementech • Green | 500     |
| FFDS4575GT | 4.5           | 75          | Countersunk | Torx®  | Elementech • Green | 400     |
| FFDS5100GT | 5.0           | 100         | Countersunk | Torx®  | Elementech • Green | 200     |
| FFDS4550TT | 4.5           | 50          | Countersunk | Torx®  | Elementech • Tan   | 600     |
| FFDS4560TT | 4.5           | 60          | Countersunk | Torx®  | Elementech • Tan   | 500     |
| FFDS4575TT | 4.5           | 75          | Countersunk | Torx®  | Elementech • Tan   | 300     |
| FFDS5100TT | 5.0           | 100         | Countersunk | Torx®  | Elementech • Tan   | 300     |

## TECHNICAL INFORMATION

| Size (mm) | Imperial Size | Insert Bit Size | Thread Length | Bending Torque Min. | Torsional Ratio | Tensile Strength |
|-----------|---------------|-----------------|---------------|---------------------|-----------------|------------------|
| 4.5 x 50  | 2" x 9        | T25             | 30mm          | 4.60Nm              | 3.07            | 8.52kN           |
| 4.5 x 60  | 2 3/8" x 9    | T25             | 40mm          | 4.60Nm              | 3.07            | 8.52kN           |
| 4.5 x 75  | 3" x 9        | T25             | 40mm          | 4.60Nm              | 3.07            | 8.52kN           |
| 5.0 x 100 | 4" x 10       | T25             | 60mm          | 6.70Nm              | 3.06            | 10.10kN          |

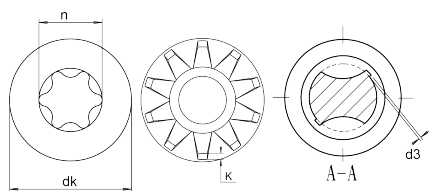
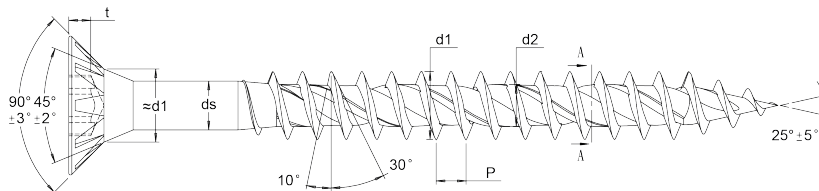

|             |      | dk  | d1  | d2  | ds   | d3   | P   | t    | n    | k    |
|-------------|------|-----|-----|-----|------|------|-----|------|------|------|
| <b>M4.5</b> | MIN. | 8.2 | 4.2 | 2.8 | 3.25 | 0.12 | 2.2 | 1.70 | 4.52 | 0.39 |
|             | MAX. | 8.5 | 4.7 | 3.1 | 3.30 | 0.12 | 2.2 | 2.00 | 4.52 | 0.39 |
| <b>M5.0</b> | MIN. | 9.2 | 4.7 | 3.2 | 3.60 | 0.12 | 2.6 | 1.90 | 4.52 | 0.46 |
|             | MAX. | 9.5 | 5.2 | 3.5 | 3.65 | 0.12 | 2.6 | 2.30 | 4.52 | 0.46 |

Protected by



**elementech**  
2000

2000 Hour Salt Spray Tested

- **Material:** C1022
- **Case Hardness:** 450-600 HV
- **Core Hardness:** 280-400 HV

TORX® compatible insert

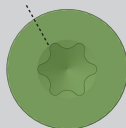

Improved holding power from reinforced countersunk neck

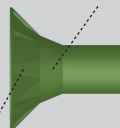

A sharp point for faster bite, capable of penetrating 0.8mm steel

Improved countersinking from recessed ribs

Proprietary drill/drive shank for faster drive, reduced splitting and 'jacking' of the timber, increased pull-out and firmer fix