

Installation Instructions

Garden Lake 200L Waterbutt



Please check you have 1 of each



- Water Butt with Lid
- Stand
- Tap
- The Diverter Kit - diverter with hose, Hex nut and rubber washer

You will require the following:

- Tape Measure
- Spirit level
- Marker/pencil
- Saw
- Screwdriver

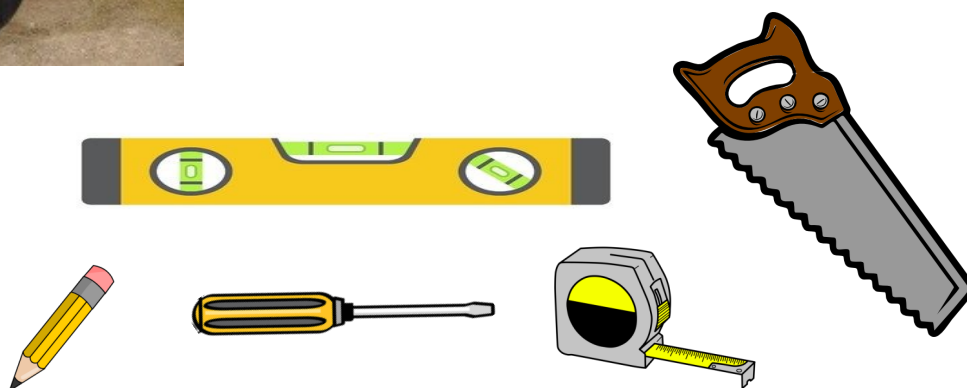

The Kit

This kit is for a stand alone water butt and should enable the user to connect to a standard downpipe, of 68mm round or 65mm square.

If you wish to link this Water Butt to 1 or more Butts, then you require a 'Linking Kit' (these are supplied separately)



Installation Guidelines

Position the Butt -

- The butt needs to be positioned next to the rainwater downpipe that you wish to collect water from. It must be close enough to allow the flexible hose to reach the downpipe from either hole location in the top of the Water butt.
-  The Ground must be level and firm. Do not fit on uneven or loose ground.
- Remove Lid (align mark on lid with arrow to unlock)
- Unpack your water butt, remove tap and secure using back nut and rubber washer fitted.
- Open Rain Diverter (Filler) kit and fit the hose connector to the butt, securing tightly with the rubber washer and Hex nut.
- Push the hose onto the connector

Mark the cut lines for the Rain Diverter

- Position Butt on the stand with Lid off in desired position.
- Using spirit level—Check Butt rim level both across and front to back.
- **Hint:** *If spirit level not as long as water butt diameter, you can use a length of wood wider than the water butt to check the butt level.*
- Transfer the height of the top of the water butt (rim) onto the downpipe, with the aid of a spirit level. Mark it on the downpipe.
- Then make a 2nd mark 15mm lower than this. **Cut line 1** (This is the 'overflow' height of the Butt)
- Make a 3rd mark 30mm below this cut line **Cut line 2**

Cut the downpipe.

- **Hint "Before cutting"** *To stop the downpipe slipping/moving while measuring/cutting, you can fit or reposition a down pipe bracket to just above the cutting area. (Squeeze clips together a little to ensure it grips pipe before marking the drill holes.*
-  **Recheck level and marked lines before cutting**
- Move water butt clear to enable ease of cutting.
- Using a suitable saw for plastic pipe. Cut-out the 30mm (3 cm) section for the diverter.
- You may need to release any clips supporting the downpipe in order to insert the rain diverter body. But these need to be refitted on completion.

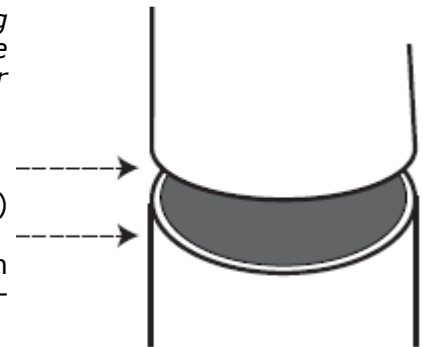

Fit the Diverter.

- Fit the rain diverter into the cut section of downpipe and refit brackets.
- Place the water butt back in position.
- Push fit the hose on to the diverter & fit Butt lid (align mark on lid with arrow to fit)

Important Notes

- Unsuitable for cast Iron pipes
- Does not use electric power tools in the rain or if there is water in the Butt
- Ensure rain diverter is level or slightly above the hose connector. This ensures the Butt will not overflow (the top of the hose should be lower than the rim of the butt at the down pipe)
- The Rain diverter should always fill the butt until water height reaches the level of the connector, then it will flow back down the hose into the centre of the downpipe.
- Do not leave water in the Butt in freezing conditions. (empty in Winter months)

