

# Primary Products



**PRO GRP Resin.**  
Specially formulated resin.

Cold applied and easy to form around complex situations, durable and able to resist foot traffic PRO GRP resin is an essential component in the roofing system.

Prod. Code	Size	Pallet Qty
G25/RES10	10kg	48
G25/25RESIN20	20kg	36



**PRO GRP Top Coat.**  
Speciality Top Coat.

Part of the PRO GRP Roofing System, the top coat is brush or roller applied in 1-2 coats, cold applied and fully bonds to the roof membrane to form a complete system.

Prod. Code	Size	Pallet Qty
G25/TOP10FR	10kg	48
G25/TOP20FR	20kg	36



**PRO GRP Hardener.**  
Catalyst.

General purpose MEKP gives consistent curing of unsaturated polyester resins and topcoats.

Prod. Code	Size	Box Qty
GH/1	1kg	10
GH/5	5kg	1



**Glass Fibre Matting.**  
High mechanical strength.

Part of the PRO GRP Glassfibre roofing system, the fibreglass matting is sandwiched between two layers of PRO GRP Resin.

Prod. Code	Size	Pallet Qty
GMAT/15	6.5Kg	49
GMAT/16.5	16.5Kg	25
GMAT/35	450gsm 33Kg	12
GMAT/35600	600gsm 33Kg	12



**Glass Fibre Jointing Bandage.**  
Excellent wet strength.

The jointing bandage is used to tape joints and seams on GRP roofs. The strands of the glassfibre are held together by an emulsion binder to form a mat.

Prod. Code	Size	Box Qty
GB/ROLL	100mm	10



# Catalyst Chart

Qty RESIN TOPCOAT (KG)	Temperature / Catalyst required (millilitres)			
	20-30 °C 1%	13-19°C 2%	9-12°C 3%	5-8°C 4%
1	10ml	20ml	30ml	40ml
2	20ml	40ml	60ml	80ml
3	30ml	60ml	90ml	120ml
4	40ml	80ml	120ml	160ml
5	50ml	100ml	150ml	200ml
6	60ml	120ml	180ml	240ml
7	70ml	140ml	210ml	280ml
8	80ml	160ml	240ml	320ml
9	90ml	180ml	270ml	360ml
10	100ml	200ml	300ml	400ml

# Usage Chart

Roof Area (m <sup>2</sup> )	ProGRP Resin required at a coverage rate of 1.5kg /m <sup>2</sup> (Allows for 10% wastage)		ProGRP Topcoat required at a coverage rate of 0.5kg /m <sup>2</sup>		ProGRP Standard Chopped Strand Matting 450gsm required (33kg covers approx 73m <sup>2</sup> )		Catalyst based on 4%	Decking Boards 2.4m x 0.6m x 18mm
	Kg	No. of Tins	Kg	No. of Tins	M <sup>2</sup>	Rolls (33kg)	Kg	1.44m <sup>2</sup> /board
		10kg + 20kg		10kg + 20kg				
5	7.5	1 + 0	2.5	1 + 0	5	1	1	5
10	15	0 + 1	5	1 + 0	10	1	1	8
15	22.5	1 + 1	7.5	1 + 0	15	1	2	12
20	30	1 + 1	10	1 + 0	20	1	2	15
25	37.5	0 + 2	12.5	0 + 1	25	1	2	19
30	45	1 + 2	15	0 + 1	30	1	3	23
35	52.5	0 + 3	17.5	0 + 1	35	1	3	26
40	60	0 + 3	20	0 + 1	40	1	3	30
50	75	0 + 4	25	1 + 1	50	2	5	38
60	90	1 + 4	30	1 + 1	60	2	6	46
70	105	1 + 5	35	0 + 2	70	2	7	54
80	120	0 + 6	40	0 + 2	80	2	7	61
90	135	0 + 7	45	1 + 2	90	2	7	69
100	150	1 + 7	50	1 + 2	100	2	7	77



# Product Guide



# PROGRP<sup>®</sup>

ADVANCED GLASSFIBRE ROOFING SYSTEM

## Product Guide

An advanced liquid applied GRP – Glass Reinforced Polyester- flat roof system. It has been specifically engineered for flat roof applications in the UK market. It is a fully integrated seamless system where all the components are designed to work together to ensure that you can take full advantage of this rapidly expanding market. ProGRP<sup>®</sup> can be used on virtually all types of flat roofs up to and including vertical surfaces for example the cheeks of a dormer or the inside face of a mansard or parapet roof.

**We always recommend professional installation of this system.**

- Range of profiled edge trims to suit all applications
- 25 Year materials warranty
- Low styrene emission resins
- UV resistant
- The ProGRP<sup>®</sup> laminate is fully resistant to wind uplift
- Anti slip resistant finish available
- Fire retardant (BS476 PART3 EXT.F.AB)



For upto date information please scan the code to visit our webpage.

### Pre-install

- Make sure substrate is:  
**New OSB T&G3 Board**  
**Clean**  
**Dry**  
**Avoid moisture at all times**  
**Never apply over wet substrates**  
**Do not apply below 5°C or above 30°C**

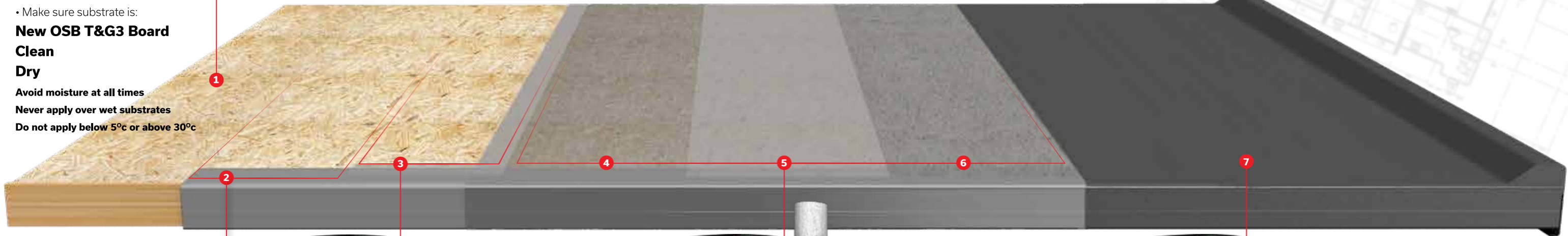

### Trimming

- Install trims to substrate



- Download or visit our website for more information on the trims used.

### Bandage Joints

Where the trims meet the deck 100mm 450gsm bandage should be applied.

Apply the catalysed resin down the trim/deck joint, half on the trim and half on the deck.

Unroll the bandage into the resin.

Impregnate the bandage with a further coat of resin. Consolidate the resin through the bandage using light pressure until the bandage is wet out.

#### PRO TIP

To soften the detailing on corners and drip overlaps use 'tissue'. Tear off a length and apply immediately after shaping the glass fibre bandage to the trim and work in with brush or roller.

### Resin Coat / Matting

To achieve the correct ratio of resin to CSM, approximately 1/3 needs to be applied to the deck and 2/3 on to the mat.

When laminating the main roof area, never mix more than 10 litre at a time, even less in warm weather. This will ensure that you DO NOT risk the basecoat resin going 'off' in the bucket and becoming unusable.

Consolidate using a bubble buster to evenly distribute the resin across the mat until it is fully wet out.

#### PRO TIP

Each strip of chop strand mat ideally requires a 50mm overlap to the next. Always overlap with the 'feathered' edge as this will make the joints appear less pronounced.

### Top Coat

Apply to the roof surface starting at the furthest point from the exit point on the roof and using the relevant sized soft application roller. The coat applied should allow the fibre pattern of the laminate to still be visible after application. If applied too thick, the topcoat may crack over a period of time.

If a non-slip finish is requested a grit or slate chippings can be sprinkled onto the topcoat. This needs to be added by hand or applicator as the roof is topcoated.

#### PRO TIP

Before applying the Topcoat lightly sand the whole of the roof surface. A smooth, unblemished surface will produce a high quality finish when topcoated. Once sanded an Acetone wipe will greatly aid the adhesion of the final topcoat.