

PIPE & FITTINGS



MLCP – MultiLayer Pipe & Fittings

By combining PE-RT and aluminium, a new technologically advanced material is formed, providing security and safety. Our Multitubo systems MLCP is designed for the specific requirements of drinking water and heating installations. The 5-layer structure combines the advantages of plastics and metal pipes. One polyethylene (PE) layer is applied to the inside and one to the outside of the welded aluminium pipe. Both PE layers are permanently bonded to the aluminium pipe by means of an adhesive layer. The PE used is a non-cross-linked polyethylene of raised temperature resistance according to DIN 16833 (PE-RT – polyethylene of raised temperature resistance).

MLCP's ultra smooth inner-layer – lasting its whole lifetime – prevents the formation of deposits and corrosion. The aluminium layer prevents any oxygen ingress and is the basis for the unique pipe installation properties such as the ability to bend the pipe and have it retain the new shape.

Why MLCP rather than copper or plastic pipe systems?

- Dimensions up to 25 mm can easily be bent by hand, therefore work can be carried out much more efficiently with fewer fittings required
- Installation times are reduced
- No hot works are required
- Low pipe coil weight makes for easier transportation
- MLCP is formstable, once bent into shape it keeps its shape, resulting in a significant reduction in fastening points
- Clipping distances as metal pipes
- Low heat expansion (up to 10x less than plastic systems)
- Meets the NHBS requirements for buried pipe detection with no additional metal tapes

Low Thermal Expansion

Due to the inner aluminium layer the thermal expansion is similar to that of metal pipes. Thus the fastening with slide points and fixed points corresponds to those of metal pipes.



Our MLCP product offering

- U Profile Pressing System fully compatible with competitors, see below
- 10 Bar at 95 Degrees
- 100% Oxygen Barrier
- Made in Germany
- WRAS approved
- Suitable for domestic & commercial projects
- Ideal for traditional and manifold plumbing
- Risers, radiators, hot & cold and manifold plumbing
- Sizes 16-110mm
- Available pre-insulated
- 25yr guarantee (50 years available on application)
- Insurance backed collateral damage warranty €2.0 Million

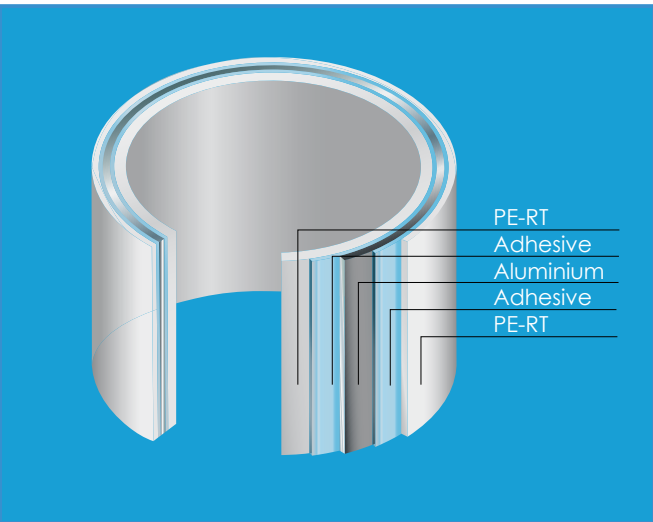
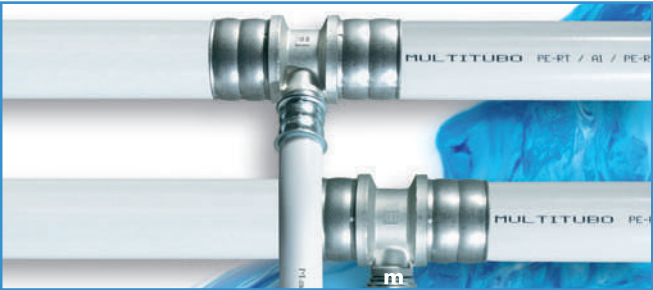

Multitubo pipe dimensions comparison to pipe materials

The dimensions of Multitubo systems pipes can be roughly compared with other materials like copper and galvanized steel according to the following list. (Only a hydraulic calculation can provide information on the dimensioning of whole installations).

DN	Multitubo	Copper	Steel
DN12	16 x 2.0	15 x 1	R ¾
DN12	20 x 2.25	18 x 1	R ½
DN20	25 x 2.5	22 x 1	R ¾
DN25	32 x 3	28 x 1.5	R1
DN32	40 x 4	35 x 1.5	R1 ¼
DN40	50 x 4.5	42 x 1.5	R1 ½
DN50	63 x 6	54 x 2	R2
DN65	75 x 7.5	67 x 2	R2 ⅓
DN80	90 x 8.5	76 x 2	R3
DN100	110 x 10	108 x 2.5	R4

MLCP PIPE AND FITTINGS

Metal Press Fittings

The Metal Press Fitting was the first type of connection developed by Multitubo systems and has been installed innumerable times. The fittings features enable quick and safe installation, 16mm - 75mm sizes.



Modular Press Fittings

90 - 110mm modular stainless steel press fittings are available for commercial riser pipes.



Composite Press Fittings

A cost-effective extension to the Metal-Press-Fitting range from 16mm up to 32mm.

To secure the highest quality requirements for this fitting, Multitubo systems uses the high performance plastic material PPSU. This material has a high impact resistance as well as high temperature and chemical resistance. The fitting bodies are white for a neat finish.



Composite Push Fittings

Safe connection with no pressing tools required. Sizes 16mm -25mm.

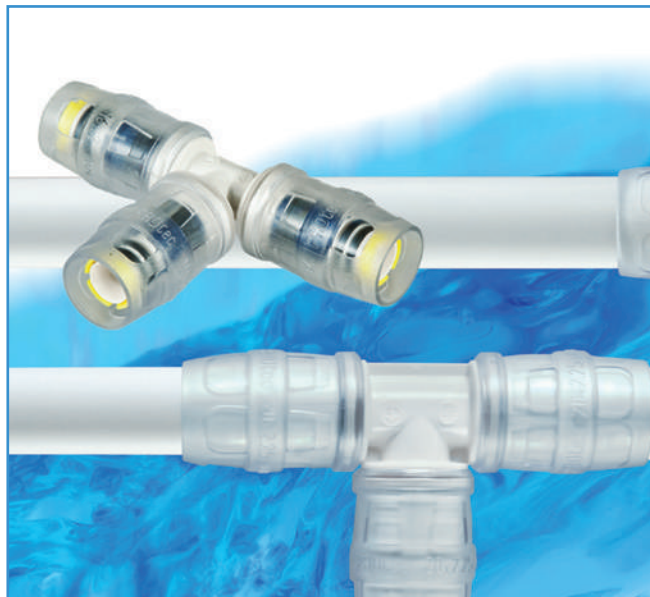

Welded Fittings

A revolution in welding technology. The Multitubo pipe and fitting are welded together, using a special tool, creating a perfectly protected joint. Sizes 32mm - 75mm.



Compression Fittings

A range of compression fittings for MLCP such as adapters used to connect to copper compression and radiator valves are available to complete our MLCP system offering.



PIPES



Multi-layer Pipe PE-RT/AL/PE-RT, white, coils

Multitubo systems multi-layer pipe, absolutely diffusion tight. Application: Installation of tap water- and heating-systems (tmax : 95°C; pmax : 10 bar at t = 70°C).

Part No.	Description (mm)	Unit	Pallet	Price p/m
10-12151	12 x 1.6mm	150m	3,000 m	£1.65
11-10011	16 x 2.00	100 m	2,000 m	£1.86
11-10010	16 x 2.00	200 m	2,600 m	£1.86
11-10015	16 x 2.00	500 m	3,000 m	£1.86
11-10030	20 x 2.25	100 m	1,300 m	£3.09
11-10037	20 x 2.25	50m	1,000 m	£3.09
11-10040	25 x 2.50	50 m	650 m	£4.92
11-10050	32 x 3.00	25 m	325 m	£7.15
11-10051	32 x 3.00	50 m	500 m	£7.15



Multi-layer Pipe PE-RT/AL/PE-RT, white, lengths

Multitubo systems multi-layer pipe, absolutely diffusion tight. Application: Installation of tap water- and heating-systems (tmax : 95°C; pmax : 10 bar at t = 70°C). Supplied in straight lengths of 3m or 5m. (Call for 3m delivery lead-time, 5m held in stock - 2-3 day delivery time).

* Sold in protective tubes, in bundles quantities only. * Suitable for heating only.

Part No.	Description (mm)	Unit	Pack	Price p/m
5 m Lengths				
11-15010	16 x 2.00*	5 m	60m	£2.36
11-15030	20 x 2.25*	5 m	85m	£4.32
11-15040	25 x 2.50*	5 m	50m	£6.25
11-15050	32 x 3.00*	5 m	35m	£7.60
11-15060	40 x 4.00*	5 m	20m	£12.40
11-15070	50 x 4.50*	5 m	10m	£18.52
11-15080	63 x 6.00*	5 m	15m	£29.93
11-15090	75 x 7.50*	5 m	5m	£51.44
11-15100	90 x 8.50* #	5 m	5m	£65.28
11-15110	110 x 10.0* #	5 m	5m	£90.36



Multi-layer Pipe white, in protective tube

Multitubo systems multi-layer pipe, in corrugated, black red or blue Polyethylene Protective Conduit. Suitable for use in screed.

Part No.	Description (mm)	Unit	Pallet	Price p/m
11-16110	16x2 MLCP in Black conduit	75 m coil	975 m	£3.36
11-16130	20x2.25 MLCP in Black Conduit	75 m coil	675 m	£4.69



Multi-layer Pipe Plus S9, white, insulation, coils

Multitubo systems multi-layer pipe, with round insulation, thickness of insulation 9 mm, heat conductance rate (WLG) 040.

Part No.	Description (mm)	Unit	Pallet	Price p/m
11-14310	16 x 2.00	50 m	500 m	£3.57
11-14310R	16 x 2.00 (Red) New!	50 m	500 m	£3.57
11-14330	20 x 2.25	50 m	400 m	£4.77
11-14330R	20 x 2.25 (Red) New!	50 m	400 m	£4.77
11-14340	25 x 2.50	50 m	400 m	£7.58
11-14340R	25 x 2.5 (Red) New!	50 m	400 m	£7.58
11-14350	32 x 3.00	50 m	300 m	£9.35
11-14350R	32 x 3.00 (Red) New!	50 m	300 m	£9.35



Multi-layer Pipe Plus S13, white, insulation blue, coils

Multitubo systems multi-layer pipe, with round insulation, thickness of insulation 13 mm, heat conductance rate (WLG) 040.

Part No.	Description (mm)	Unit	Pallet	Price p/m
11-14410	16 x 2.00	50 m	400 m	£3.94
11-14430	20 x 2.25	50 m	400 m	£5.24
11-14440	25 x 2.50	50 m	250 m	£8.45
11-14450	32 x 3.00	50 m	250 m	£11.87

METAL PRESS FITTINGS

mlcp



Metal Press Coupling

Multitubo tin-plated brass press-fit straight coupling with press sleeves and inspection windows to ensure correct installation. Available in sizes 16-75mm, for use with MLCP only. See compatibility chart on page 6. WRAS Approved.

Part No.	Description (mm)	Unit/Bag	Unit/Carton	Price Each
11-27010	16 x 16	10	200	£4.63
11-27030	20 x 20	10	160	£6.20
11-27040	25 x 25	10	100	£9.27
11-27050	32 x 32	10	60	£17.28
11-27060	40 x 40	1	18	£19.67
11-27070	50 x 50	1	12	£27.90
11-27080	63 x 63	1	8	£66.48
11-27090	75 x 75	1	2	£89.69



Metal Press Coupling, reduced

Multitubo tin-plated brass press-fit reducing coupling with press sleeves and inspection windows to ensure correct installation. Available in sizes 16-75mm. For use with MLCP only. See compatibility chart on page 6. WRAS Approved.

Part No.	Description (mm)	Unit/Bag	Unit/Carton	Price Each
11-27031	20 x 16	10	160	£5.75
11-27041	25 x 16	10	120	£7.54
11-27042	25 x 20	10	120	£8.36
11-27051	32 x 20	10	80	£13.56
11-27052	32 x 25	10	80	£14.51
11-27062	40 x 25	1	18	£19.39
11-27061	40 x 32	1	18	£22.03
11-27072	50 x 32	1	12	£26.71
11-27071	50 x 40	1	12	£28.79
11-27081	63 x 40	1	8	£65.20
11-27082	63 x 50	1	8	£62.61
11-27091	75 x 40	1	2	£79.44
11-27092	75 x 50	1	2	£80.00
11-27093	75 x 63	1	2	£83.90



Metal Press Elbow 90°

Multitubo tin-plated brass press-fit 90° elbow with press sleeves and inspection windows to ensure correct installation. Available in sizes 16-75mm, for use with MLCP only. See compatibility chart on page 6. WRAS Approved.

Part No.	Description (mm)	Unit/Bag	Unit/Carton	Price Each
11-23010	16 x 16	10	200	£5.12
11-23030	20 x 20	10	150	£6.71
11-23040	25 x 25	10	80	£11.31
11-23050	32 x 32	4	44	£16.28
11-23060	40 x 40	1	10	£26.12
11-23070	50 x 50	1	8	£37.03
11-23080	63 x 63	1	4	£88.93
11-23090	75 x 75	1	2	£136.03



Metal Press Tee

Multitubo tin-plated brass press-fit equal tee with press sleeves and inspection windows to ensure correct installation. Available in sizes 16-75mm, for use with MLCP only. See compatibility chart on page 6. WRAS Approved.

Part No.	Description (mm) A x B x C	Unit/Bag	Unit/Carton	Price Each
11-25010	16 x 16 x 16	10	150	£6.99
11-25030	20 x 20 x 20	10	100	£10.34
11-25040	25 x 25 x 25	4	40	£15.96
11-25050	32 x 32 x 32	4	32	£29.81
11-25060	40 x 40 x 40	1	8	£37.62
11-25070	50 x 50 x 50	1	6	£53.39
11-25080	63 x 63 x 63	1	2	£121.77
11-25090	75 x 75 x 75	1	2	£198.08

MultiFit Universal fitting

Introducing new MultiFit:

- Universal fittings - Connects to MLCP or PEX and PB pipe
- Available in a wide range of sizes for common plumbing & heating termination
- The connection is fully demountable for maintenance
- Suitable for use in flat face applications
- No special tools are required for installation - you only need a Hex Key or Allen key!

See Page 13

METAL PRESS FITTINGS



Metal Press Tee Reduced

Multitubo tin-plated brass press-fit reducing tee with press sleeves and inspection windows to ensure correct installation. Available in sizes 16-75mm, for use with MLCP only. See compatibility chart on page 6. See ABC for fitting sizes make-up. WRAS Approved.

Part No.	Description (mm) A x B x C	Unit/Bag	Unit/Carton	Price Each
11-25011	16 x 20 x 16	10	100	£11.43
11-25031	20 x 16 x 16	10	100	£10.77
11-25032	20 x 16 x 20	10	100	£11.33
11-25033	20 x 20 x 16	10	100	£11.36
11-25048	25 x 16 x 16	4	60	£12.03
11-25047	25 x 16 x 20	4	60	£13.23
11-25041	25 x 16 x 25	4	60	£13.43
11-25042	25 x 20 x 20	4	60	£13.27
11-25043	25 x 20 x 25	4	48	£14.75
11-25054	32 x 16 x 32	4	40	£18.95
11-25051	32 x 20 x 32	4	40	£21.34
11-25053	32 x 25 x 25	4	40	£21.63
11-25052	32 x 25 x 32	4	32	£21.59
11-25061	40 x 20 x 40	1	8	£27.61
11-25062	40 x 25 x 40	1	8	£31.04
11-25063	40 x 32 x 32	1	8	£30.34
11-25064	40 x 32 x 40	1	8	£34.04
11-25072	50 x 25 x 50	1	6	£48.67
11-25073	50 x 32 x 50	1	6	£49.90
11-25074	50 x 40 x 50	1	6	£58.82
11-25081	63 x 25 x 63	1	2	£101.21
11-25082	63 x 32 x 63	1	2	£104.73
11-25083	63 x 40 x 63	1	2	£111.35
11-25084	63 x 50 x 63	1	2	£112.45
11-25092	75 x 40 x 75	1	2	£164.91
11-25093	75 x 50 x 75	1	2	£168.83



Metal Press Connection Male Thread

Multitubo tin-plated brass press-fit male tapered threaded iron with press sleeves and inspection windows to ensure correct installation. Available in sizes 16-75mm, for use with MLCP only. See compatibility chart on page 6. WRAS Approved.

Part No.	Description	Unit/Bag	Unit/Carton	Price Each
11-20010	16 x ½" MT	10	200	£4.25
11-20014	16 x ¾" MT	10	200	£6.10
11-20030	20 x ½" MT	10	200	£5.87
11-20031	20 x ¾" MT	10	170	£6.37
11-20032	20 x 1" MT	10	170	£9.83
11-20040	25 x ¾" MT	10	100	£7.98
11-20041	25 x 1" MT	10	100	£10.44
11-20050	32 x 1" MT	10	80	£12.33
11-20060	40 x 1 ¼" MT	1	18	£19.81
11-20061	40 x 1 ½" MT	1	18	£26.35
11-20070	50 x 1 ½" MT	1	12	£26.75
11-20071	50 x 2" MT	1	12	£45.26
11-20080	63 x 2" MT	1	8	£64.63
11-20090	75 x 2 ½" MT	1	2	£93.28



Metal Press Connection Female Thread

Multitubo tin-plated brass press-fit female parallel threaded iron with press sleeves and inspection windows to ensure correct installation. Available in sizes 16-75mm, for use with MLCP only. See compatibility chart on page 6. WRAS Approved.

Part No.	Description	Unit/Bag	Unit/Carton	Price Each
11-21010	16 x ½" FT	10	200	£5.22
11-21014	16 x ¾" FT	10	200	£5.66
11-21030	20 x ½" FT	10	200	£5.82
11-21031	20 x ¾" FT	10	180	£7.67
11-21032	20 x 1" FT	10	180	£12.58
11-21040	25 x ¾" FT	10	100	£8.73
11-21041	25 x 1" FT	10	100	£14.77
11-21050	32 x 1" FT	10	80	£15.14
11-21051	32x1 ¼" FT	10	56	£22.51
11-21061	40 x 1 ¼" FT	1	18	£23.06
11-21062	40x1 ½" FT	1	18	£27.39
11-21071	50 x 1 ½" FT	1	10	£29.50
11-21080	63 x 2" FT	1	8	£57.42
11-21090	75 x 2 ½" FT	1	2	£97.12

METAL PRESS FITTINGS



Metal Press Screw Connection Female Thread

Multitubo tin-plated brass press-fit female parallel threaded swivel iron with press sleeves and inspection windows to ensure correct installation. Detachable fitting for surface mounted connections of filters, valves or taps. Supplied with fibre washer. Available in sizes 16-50mm, for use with MLCP only. See compatibility chart on page 6. WRAS Approved.

Part No.	Description	Unit/Bag	Unit/Carton	Price Each
11-28011	16 x ½" FT	10	200	£8.42
11-28010	16 x ¾" FT	10	200	£9.47
11-28031	20 x ½" FT	10	200	£10.73
11-28030	20 x ¾" FT	10	170	£11.53
11-28041	25 x ¾" FT	10	100	£12.79
11-28040	25 x 1" FT	10	100	£13.67
11-28050	32 x 1 ¼" FT	8	56	£22.52
11-F28051	32 x 1" FT (Unplated)	8	56	£17.68
11-F28061	40 x 1 ½" FT (Unplated)	1	18	£30.67
11-F28060	40 x 1 ½" FT (Unplated)	1	18	£30.67
11-F28070	50 x 2" FT (Unplated)	1	10	£44.43



Metal Press Tee Female Thread

Multitubo tin-plated brass press-fit female centre tee with press sleeves and inspection windows to ensure correct installation. Available in sizes 16-75mm, for use with MLCP only. See compatibility chart on page 6. WRAS Approved.

Part No.	Description mm (A x B x C)	Unit/Bag	Unit/Carton	Price Each
11-25015	16 x ½" FT x 16	10	100	£11.81
11-25035	20 x ½" FT x 20	10	100	£12.90
11-25038	20 x ¾" FT x 20	10	100	£13.31
11-25045	25 x ½" FT x 25	4	48	£16.14
11-25046	25 x ¾" FT x 25	4	44	£16.08
11-25056	32 x ½" FT x 32	4	40	£22.40
11-25055	32 x ¾" FT x 32	4	40	£25.77
11-25066	40 x 1" FT x 40	1	8	£31.67
11-25075	50 x 1" FT x 50	1	6	£36.66
11-25085	63 x 1" FT x 63	1	2	£103.95
11-25095	75 x 1" FT x 75	1	2	£156.57



Metal Press Elbow 45°

Multitubo tin-plated brass press-fit 45° elbow with press sleeves and inspection windows to ensure correct installation. Available in sizes 16-75mm, for use with MLCP only. See compatibility chart on page 6. WRAS Approved.

Part No.	Description (mm)	Unit/Bag	Unit/Carton	Price Each
11-23250	32 x 32	4	44	£25.39
11-23260	40 x 40	1	10	£46.85
11-23270	50 x 50	1	4	£48.35
11-23280	63 x 63	1	2	£85.98
11-23290	75 x 75	1	2	£196.30



Metal Press Elbow 90° Male Thread

Multitubo tin-plated brass press-fit 90° male threaded elbow with press sleeves and inspection windows to ensure correct installation. Available in sizes 16-32mm, for use with MLCP only. See compatibility chart on page 6. WRAS Approved.

Part No.	Description	Unit/Bag	Unit/Carton	Price Each
11-23015	16 x ½" MT	10	200	£6.68
11-23035	20 x ½" MT	10	160	£8.66
11-23037	20 x ¾" MT	10	120	£9.53
11-23045	25 x ¾" MT	10	90	£12.63
11-23047	25 x 1" MT	10	90	£15.36
11-23055	32 x 1" MT	6	54	£17.29



Metal Press Elbow 90° Female Thread

Multitubo tin-plated brass press-fit 90° female threaded elbow with press sleeves and inspection windows to ensure correct installation. Available in sizes 16-32mm, for use with MLCP only. See compatibility chart on page 6. WRAS Approved.

Part No.	Description	Unit/Bag	Unit/Carton	Price Each
11-23016	16 x ½" FT	10	180	£6.20
11-23036	20 x ½" FT	10	160	£8.22
11-23038	20 x ¾" FT	10	100	£9.92
11-23046	25 x ¾" FT	10	100	£12.64
11-23048	25 x 1" FT	6	54	£14.72
11-23056	32 x 1" FT	6	54	£17.29

METAL PRESS FITTINGS



Metal Press Elbow Female Thread (Swivel Elbow)

Multitubo tin-plated brass press-fit female parallel threaded swivel 90° elbow with press sleeves and inspection windows to ensure correct installation. Detachable fitting for surface mounted connections of filters, valves or taps. Supplied with fibre washer. Available in size 16mm, for use with MLCP only. See compatibility chart on page 6. WRAS Approved.

Part No.	Description	Unit/Bag	Unit/Carton	Price Each
11-F23013	16 x ½" FT Swivel Elbow brass press-fit	10	100	£8.21
11-F23033	20 x ½" FT Swivel Elbow brass press-fit	10	160	£12.23
11-F23034	20 x ¾" FT Swivel Elbow brass press-fit	10	120	£14.81



Metal Press Tab Connection Elbow Female Thread, with flange

Multitubo tin-plated brass press-fit 90° back plate elbow with female thread, press sleeves and inspection windows to ensure correct installation. Available in sizes 16-25mm, for use with MLCP only. See compatibility chart on page 6. WRAS Approved.

Part No.	Description	Unit/Bag	Unit/Carton	Price Each
11-29010	16 x ½" FT	10	100	£10.50
11-29030	20 x ½" FT	10	100	£9.83
11-29031	20 x ¾" FT	10	100	£12.18
11-29040	25 x ¾" FT	10	80	£17.19



Metal Press Re-Circulated System Elbow Female Thread

Multitubo tin-plated brass press-fit "U" bend back plate elbow with female thread, press sleeves and inspection windows to ensure correct installation. For use in re-circulated systems installations. Available in sizes 16-20mm, for use with MLCP only. See compatibility chart on page 6. WRAS Approved. A hygienic fitting used jointly to combat both the build-up and growth of legionella bacteria in cold water systems and also for minimising dead legs in hot water systems by allowing the hot water to pass through the fitting. WRAS Approved.

Part No.	Description	Unit/Bag	Unit/Carton	Price Each
11-29415	16 x ½" FTx16	10	50	£37.66
11-29435	20 x ½" FTx20	10	50	£39.48



Metal Press Lever Ball Valve

Pre-jointed isolation ball valves with Multitubo tin-plated brass press-fit male tapered threaded iron with blue handle, press sleeves and inspection windows to ensure correct installation. Available in sizes 16-63mm, for use with MLCP only. See compatibility chart on page 6. WRAS Approved.

Part No.	Description	Unit/Bag	Unit/Carton	Price Each
28-16161B	16mm	1	6	£26.23
28-20201B	20mm	1	6	£34.34
28-25251B	25mm	1	6	£36.66
28-32321B	32mm	1	6	£55.13
28-40401B	40mm	1	4	£91.27
28-50501B	50mm	1	4	£108.13
28-63631B	63mm	1	2	£203.86



Metal Press Radiator Connection Elbow

Multitubo tin-plated brass 16x15mm press-fit 90° elbow for radiator connection with press sleeve and inspection windows to ensure correct installation. For use with MLCP only. See compatibility chart on page 6. Sold individually. WRAS Approved.

Part No.	Description	Unit/Bag	Unit/Carton	Price Each
11-23508	16 x Cu 12 x 1 - 150mm	2	60	£13.84
11-23509	16 x Cu 15 x 1 - 150mm	2	60	£14.33
11-23510	16 x Cu 15 x 1 - 330 mm	2	60	£14.98



Metal Press Radiator Connection Tee

Multitubo tin-plated brass 15mm centre press-fit tee for radiator connection with press sleeves and inspection windows to ensure correct installation. Available in sizes 16-20mm. For use with MLCP only. See compatibility chart on page 6. WRAS Approved.

Part No.	Description	Unit/Bag	Unit/Carton	Price Each
11-25510	16 x 330 mm	2	32	£18.90
11-25530	20 x 330 mm	2	20	£19.94

METAL PRESS FITTINGS



Multi-Fit Fitting

A unique demountable fitting for connecting multilayer pipe to other heating, potable water and underfloor heating systems using only a beveling tool and Allen key. Available 16-32mm with ½" - 1" compression connections. The fitting is supplied with an o-ring for conical seats and a flat face washer for flat seats. WRAS Approved.

New!

Part No.	Description	Unit/Bag	Unit/Carton	Price Each
21-16210	16mm x ½" *	20	360	£2.68
21-16214	16mm x ¾"	20	160	£3.93
21-22530	20x2.25mm x ½" *	15	270	£3.80
21-22531	20x2.25mm x ¾"	15	195	£4.59
21-25240	25mm x ¾"	10	130	£6.04
21-25241	25mm x 1"	10	190	£9.54
21-32350	32mm x 1"	10	130	£12.10

See Tools Section for Multi-Fit Tool (Part No. 21-14026)

* ½" version can be used as a reusable test plug with item reference 21-53121. 10 bar max at 20°C. See page 29.



Metal Press to Brass Spigot Adapter

Multitubo compatible brass press-fit spigot adapter with press sleeve and inspection windows to ensure correct installation. Available in sizes 16x15mm & 20x22mm, for use with MLCP only. NOTE: Do not solder. Ideal for use with copper compression and press-fit fittings. See compatibility chart on page 6. WRAS Approved.

Part No.	Description	Unit/Bag	Unit/Carton	Price Each
11-29710	16x15	10	150	£4.74
12-29712	20x22	10	80	£5.67



Metal Press to Copper Spigot Adapter

Multitubo brass press-fit spigot adapter with press sleeve and inspection windows to ensure correct installation. Available in sizes 16-32mm, for use with MLCP only. NOTE: Do not solder. Ideal for use with copper compression and press-fit fittings. See compatibility chart on page 6. WRAS Approved.

Part No.	Description	Unit/Bag	Unit/Carton	Price Each
11-29706	16x10mm	10	200	£8.24
11-29708	16x12mm	10	200	£8.24
11-F29710	16x15mm	10	200	£7.54
11-F29731	20x22mm	10	200	£9.17
11-F29740	25x22mm	10	100	£11.98
11-F29750	32x28mm	10	50	£13.06



Metal Press to Copper Compression Adapter Male Thread

Multitubo brass press-fit to copper compression adapter. To be used with standard 15/22mm copper compression nut & olive (not supplied). WRAS Approved.

Part No.	Description	Unit/Bag	Unit/Carton	Price Each
11-F20710	16x15mm brass press-fit to copper compression adapter	10	200	£3.99
11-F20731	20x22mm brass press-fit to copper compression adapter	10	200	£7.08
11-F20740	25x22mm brass press-fit to copper compression adapter	10	200	£8.60
11-F23715	16x15mm brass press-fit Elbow to copper compression adapter	10	200	£4.99

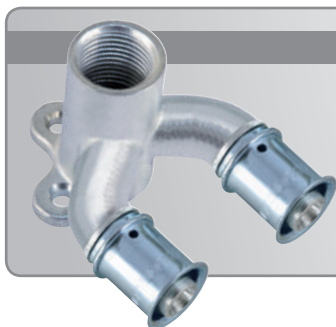

Re-circulated System Elbow

See
Page 12

New loop plumbing fittings from Multipipe for eliminating dead legs and standing water:

- Combats the potential build-up of legionella bacteria – the risk of standing water is minimised
- No dead legs in hot water systems
- Replaces tee fittings and reduces the number of joints required
- WRAS approved

METAL PRESS FITTINGS



MODULAR PRESS-FITTINGS 90 | 110

- Stainless steel fitting body: high performance – low weight
- Connection-technology: Simple and safe
- An economic installation of large sizes
- Less overhead work by modular pre-mounting
- Highest Flexibility in each project
- Fully compatible within the system
- Pressing on the workbench, installing on site

Modular Adapter MLC				
Multitubo Stainless Steel Press Adapter for Modular Riser System, with inspection window to ensure correct installation. Available in sizes 75-110mm. See compatibility chart on page 6.				
Part No.	Description	Unit/Bag	Unit/Carton	Price Each
11-M22063	63 x 6mm Coming Soon	1	1	
11-M22075	75 x 7.5mm	1	1	£76.74
11-M22090	90 x 8.5mm	1	1	£101.73
11-M22110	110 x 10.0mm	1	1	£121.16

Modular Base Body 90° Elbow				
Multitubo Stainless Steel 90° Modular Elbow. (2 x Gripper Clamps required per fitting, Product Code: 11-M28000)				
Part No.	Description	Unit/Bag	Unit/Carton	Price Each
11-M23000	Base Body 90° Elbow	1	1	£81.64

Modular Base Body 45° Elbow				
Multitubo Stainless Steel 45° Modular Elbow. (2 x Gripper Clamps required per fitting, Product Code: 11-M28000).				
Part No.	Description	Unit/Bag	Unit/Carton	Price Each
11-M23200	Base Body 45° Elbow	1	1	£67.60

METAL PRESS FITTINGS



Modular Base Body T-Piece

Multitubo Stainless Steel Modular Tee. (3 x Gripper Clamps required per fitting, Product Code: 11-M28000).

Part No.	Description	Unit/Bag	Unit/Carton	Price Each
11-M25000	Base Body T-Piece	1	1	£116.26

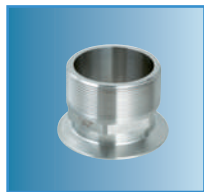

Modular Base Body MT Connector

Multitubo Stainless Steel Modular Male Tapered Threaded iron Connector. (1 x Gripper Clamp required per fitting, Product Code: 11-M28000).

Part No.	Description	Unit/Bag	Unit/Carton	Price Each
11-M20212	2 ½" MT Base Body Connector	1	1	£63.84
11-M20300	3" MT Base Body Connector	1	1	£70.18



Modular Base Body FT Connector

Multitubo Stainless Steel Modular Female Parallel Threaded iron Connector. (1 x Gripper Clamp required per fitting, Product Code: 11-M28000)

Part No.	Description	Unit/Bag	Unit/Carton	Price Each
11-M21034	¾" FT Base Body Connector	1	1	£40.66
11-M21112	1 ½" FT Base Body Connector Coming Soon	1	1	
11-M21134	1 ¾" FT Base Body Connector Coming Soon	1	1	
11-M21200	2" FT Base Body Connector	1	1	£49.54
11-M21212	2 ½" FT Base Body Connector	1	1	£57.64
11-M21300	3" FT Base Body Connector	1	1	£66.03



Modular Blind Cap

Multitubo Stainless Steel Modular Blank Cap. (1 x Gripper Clamp required per fitting, Product Code: 11-M28000).

Part No.	Description	Unit/Bag	Unit/Carton	Price Each
11-M29500	Blind Cap	1	1	£26.48



Modular Gripper clamp with Sealing

Multitubo Stainless Steel Modular Gripper Clamp with sealing ring.

Part No.	Description	Unit/Bag	Unit/Carton	Price Each
11-M28000	Gripper clamp with sealing	1	1	£19.66
11-M28010	Replacement sealing	1	1	£3.43



ADVANTAGES:

Easy handling:

Weight savings up to 50% compared to metal pipe.

Lighter fittings resulting from thinner wall-thickness.

Higher safety at work:

Lower material weights increase the safety at work in heights or working over-head.

COMPOSITE PRESS FITTINGS



Composite Press Stop End

Multitubo compatible brass press-fit stop end with press sleeve and inspection windows to ensure correct installation. Available in sizes 16-32mm, for use with MLCP only. See compatibility chart on page 6. WRAS Approved.

Part No.	Description	Unit/Bag	Unit/Carton	Price Each
11-29510	16x2mm	10	200	£3.13
11-29530	20x2.25mm	10	200	£3.60
11-29540	25x2.5mm	10	150	£3.88
11-29550	32x3.0mm	10	150	£4.97



Composite Press Coupling

Multitubo PPSU composite plastic press-fit straight coupling with press sleeves and inspection windows to ensure correct installation. Available in sizes 16-32mm, for use with MLCP only. See compatibility chart on page 6. WRAS Approved.

Part No.	Description	Unit/Bag	Unit/Carton	Price Each
11-57010	16x16mm	10	200	£3.22
11-57030	20x20mm	10	160	£4.31
11-57040	25x25mm	10	100	£6.84
11-57050	32x32mm	10	60	£10.82
11-57060	40x40mm	1	18	£9.18
11-57070	50x50mm New!	1	18	£POA



Composite Press Reducing Coupling

Multitubo PPSU composite plastic press-fit reducing coupling with press sleeves and inspection windows to ensure correct installation. Available in sizes 16-32mm. For use with MLCP only. See compatibility chart on page 6. WRAS Approved.

Part No.	Description	Unit/Bag	Unit/Carton	Price Each
11-57031	20x16mm	10	160	£3.94
11-57041	25x16mm	10	120	£6.23
11-57042	25x20mm	10	120	£6.31
11-57052	32x25mm	10	80	£10.37



Composite Press Elbow

Multitubo PPSU composite plastic press-fit 90° elbow with press sleeves and inspection windows to ensure correct installation. Available in sizes 16-32mm, for use with MLCP only. See compatibility chart on page 6. WRAS Approved.

Part No.	Description	Unit/Bag	Unit/Carton	Price Each
11-53010	16x16mm	10	200	£4.09
11-53030	20x20mm	10	150	£5.11
11-53040	25x25mm	10	80	£8.09
11-53050	32x32mm	4	44	£12.31
11-53060	40x40mm	1	10	£20.54
11-53070	50x50mm New!	1	10	£POA

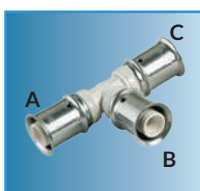

Composite Press Equal and Reducing Tee

Multitubo PPSU composite plastic press-fit equal & reducing tees with press sleeves and inspection windows to ensure correct installation. Available in sizes 16-32mm, for use with MLCP only. See compatibility chart on page 6. See "ABC" for fitting sizes make-up. WRAS Approved.

Part No.	Description (A x B x C)	Unit/Bag	Unit/Carton	Price Each
11-55010	16x16x16mm	10	150	£5.52
11-55030	20x20x20mm	10	100	£7.91
11-55040	25x25x25mm	10	40	£13.58
11-55050	32x32x32mm	4	32	£21.36
11-55060	40x40x40mm	1	8	£29.55
11-55070	50x50x50mm New!	10	100	£POA
11-55011	16x20x16mm	10	100	£7.34
11-55031	20x16x16mm	10	100	£7.29
11-55032	20x16x20mm	10	100	£7.29
11-55033	20x20x16mm	10	100	£7.29
11-55041	25x16x25mm	4	60	£10.77
11-55042	25x20x20mm	4	60	£10.54
11-55043	25x20x25mm	4	60	£11.65
11-55051	32x20x32mm	4	32	£17.35
11-55053	32x25x25mm	4	32	£18.74
11-55052	32x25x32mm	4	32	£19.03

Metal Press Ball Valve – 3 fittings in one:

See
Page 12



Metal Press Ball Valve – 3 fittings in one:

- Quick to install isolation points, minimises the number of components required
- Fully bench tested, saves having to screw together separate threaded components
- Range of sizes available to suit the application
- WRAS approved

COMPOSITE PUSH FITTINGS

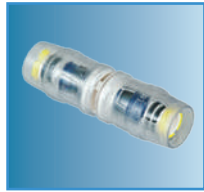

Push-Fit Composite Coupling

Multitubo PPSU composite push-fit straight coupling with clear sleeves to ensure correct installation. Available in sizes 16-25mm, for use with MLCP only. See compatibility chart on page 6.

Part No.	Description	Unit/Bag	Unit/Carton	Price Each
11-P67010	16x16mm	10	200	£4.51
11-P67030	20x20mm	10	140	£5.35
11-P67040	25x25mm	10	90	£8.72

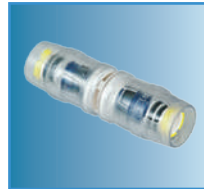

Push-Fit Composite Reducing Coupling

Multitubo PPSU composite plastic push-fit reducing coupling with clear sleeves to ensure correct installation. Available in sizes 16-25mm. For use with MLCP only. See compatibility chart on page 6.

Part No.	Description	Unit/Bag	Unit/Carton	Price Each
11-P67031	20x16mm	10	140	£6.31
11-P67042	25x20mm	10	120	£8.72



Push-Fit Composite Elbow

Multitubo PPSU composite plastic push-fit 90° elbow with clear sleeves to ensure correct installation. Available in sizes 16-25mm, for use with MLCP only. See compatibility chart on page 6.

Part No.	Description	Unit/Bag	Unit/Carton	Price Each
11-P63010	16x16mm	10	150	£5.10
11-P63030	20x20mm	10	100	£6.41
11-P63040	25x25mm	10	70	£10.25

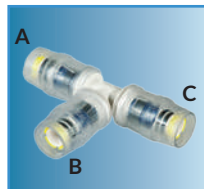

Push-Fit Composite Tee

Multitubo PPSU composite plastic push-fit equal tees with clear sleeves to ensure correct installation. Available in sizes 16-25mm, for use with MLCP only. See compatibility chart on page 6.

Part No.	Description (A x B x C)	Unit/Bag	Unit/Carton	Price Each
11-P65010	16x16x16mm	10	100	£7.44
11-P65030	20x20x20mm	10	80	£8.51
11-P65040	25x25x25mm	10	80	£15.21



Push-Fit Composite Reducing Tee

Multitubo PPSU composite plastic push-fit reducing tees with clear sleeves to ensure correct installation. Available in sizes 16-25mm, for use with MLCP only. See compatibility chart on page 6. See "ABC" for fitting size make-up.

Part No.	Description (A x B x C)	Unit/Bag	Unit/Carton	Price Each
11-P65031	20x16x16mm	4	10	£8.51
11-P65032	20x16x20mm	10	80	£8.51
11-P65041	25x16x25mm	4	40	£13.64
11-P65042	25x20x20mm	4	48	£13.64
11-P65043	25x20x25mm	4	48	£13.64

Please note: Your standard Terms may not apply on Composite Push Fittings - please call us for details.

PIPE CLIPS



Pipe Clip

Pipe to fix pipe in position. Made of plastic with snap into place mechanism. Sold in unit quantities only.

Part No.	Description	Unit	Price Each
14-19311	16mm	100	£0.27
14-19312	20mm	100	£0.34
14-19340	25mm	50	£0.44
14-19350	32mm	50	£0.70

COMPRESSION FITTINGS



Nut & Insert Adapter - Nickel Plated

Nickel plated brass nut and insert compression adapter for MLCP. Used to adapt to copper compression and radiator valves etc. NOTE: threads must be checked.

Part No.	Description	Unit/Bag	Unit/Carton	Price Each
34-13813G	12x15mm	10	200	£2.66
12-79710	16x15mm	10	200	£2.90



Nut & Insert Adapter - 2 piece

Nickel plated brass compression coupling for MLCP. Size 16mm and 20mm.

Part No.	Description	Unit/Bag	Unit/Carton	Price Each
11-79710	16mm x 15mm Nickel plated	10	100	£3.20
11-79731	20mm x 22mm Brass	10	100	£5.81



MLCP Compression Coupling

Nickel plated brass compression coupling for MLCP. Size 16mm and 20mm.

Part No.	Description	Unit/Bag	Unit/Carton	Price Each
15-16161	16mm	10	100	£9.34
15-20202	20mm	10	100	£13.90



MLCP to Copper Compression Couplings

Brass Compression Straight Coupling Multilayer pipe to copper pipe. Sizes 16mm.

Part No.	Description	Unit/Bag	Unit/Carton	Price Each
12-16151	16x15mm	10	80	£6.86
15-20152	20X15mm	10	80	£9.22



Chromed Radiator Compression Elbow

Nickel plated brass elbow with 15mm spigot for connecting MLCP to radiators using 12mm (34-13813) and 16mm (12-79710) compression adapters (see above)

Part No.	Description	Unit/Bag	Unit/Carton	Price Each
12-15015	½" Male iron x 15mm Dia spigot x 16mm long	10	10	£6.56



Push-Fit (Re-Usable) Stop End

Re-usable push fit brass stop end with key for easy removal. Rated for testing at Max 10 bar at 20°C.

New!

Part No.	Description	Unit/Bag	Unit/Carton	Price Each
21-62512	12mm (Reusable)	10	630	£3.51
21-62516	16mm (Reusable)	10	525	£4.05
21-62520	20mm (Reusable)	10	294	£5.65



21-67112	Disconnecting Clip (for 12mm Push Fit Stop End 21-62512)	1		£0.51
21-67116	Disconnecting Clip (for 16mm Push Fit Stop End 21-62516)	1		£0.54
21-67120	Disconnecting Clip (for 20mm Push Fit Stop End 21-62520)	1		£0.62

Plumbing for the 21st Century

Why choose manifold plumbing rather than traditional branching plumbing methods?

Widely used on the continent for many years, manifold plumbing and heating systems affords the installer greater peace of mind. With fewer fittings to purchase, install or worry about during and after any installation and with added benefits such as pre-insulated pipe and isolation at the manifold, these plumbing and heating systems lend themselves perfectly to new build and retro-fit installations.

Why Manifold Plumbing & Heating?

- No fittings in the floor or walls
- Speed and simplicity of installation
- Point to point installation – fewer fittings, less chance of leaks
- Massive reduction in fittings use
- Capital cost saving on specialist tools and fittings
- Full range of connection adaptors available
- Individual appliance isolation at the manifold
- Strong, flexible pipe, suitable for laying in screed
- Pipe traceable as required by NHBC
- Pipe available pre-insulated in red and blue for flow & return or hot & cold identification
- Individual room temperature control and system balancing
- Easy pressure testing
- Collateral Damage Warranty - €2 Million

Manifold Plumbing

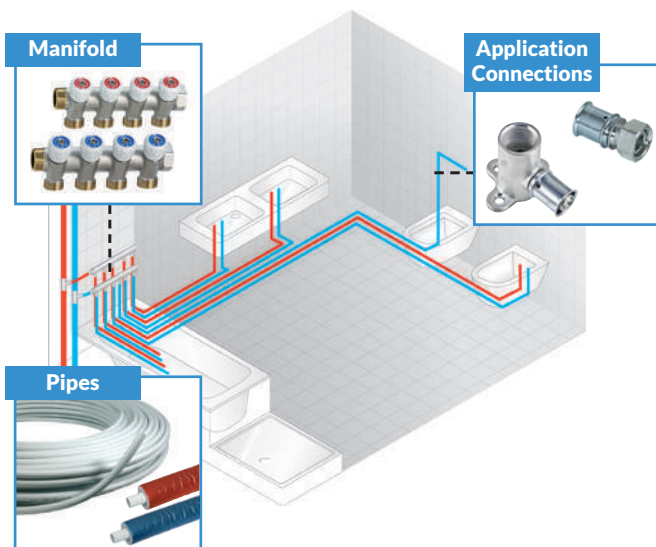

Manifold Heating

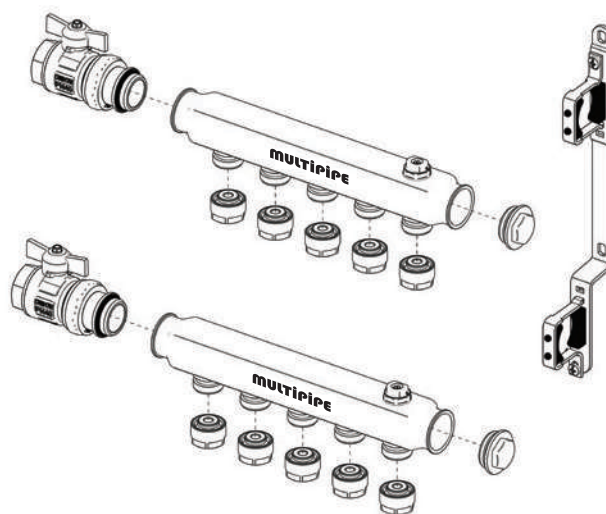
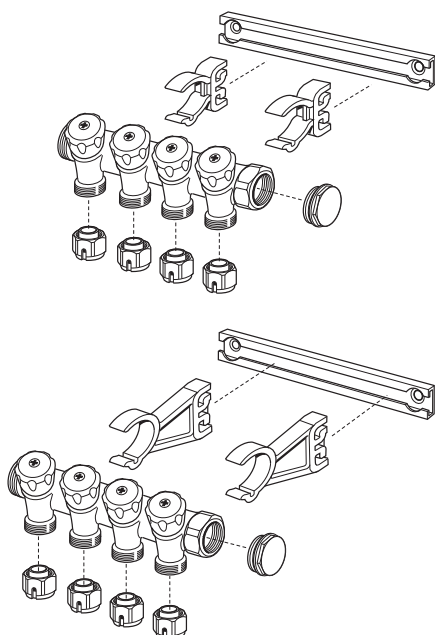
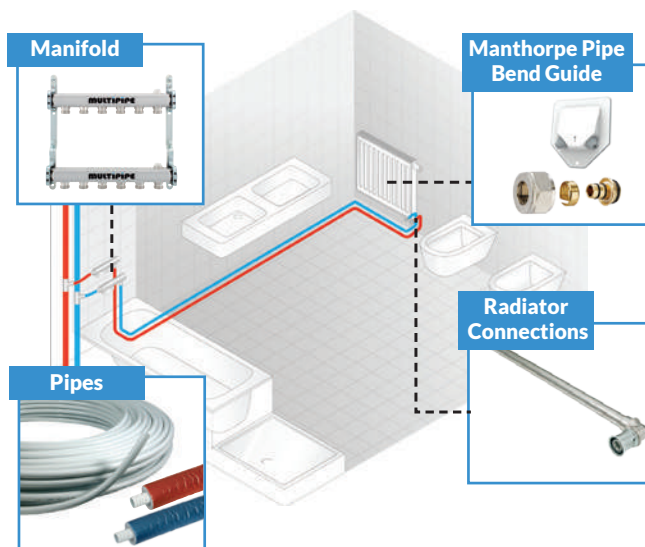

SANITARY MANIFOLDS



Modular Sanitary Manifolds & Accessories

Multipipe 3/4" or 1", male/female ended sanitary manifold range with all associated component parts and fixing, including bridging piece for connecting more than a single manifold. Product is Wras approved.



Manifold



Ball Valves



Female End Caps



Male Blanking Plugs

Description	Part No.	Price	Description	Part No.	Price	Description	Part No.	Price	Description	Part No.	Price
2 Port 3/4"	15-07260	£19.74	Pair 3/4" 3/4" FT x 3/4" MT	35-14050	£20.16	3/4"	15-91536	£2.37	3/4"	15-04820	£2.55
3 Port 3/4"	15-07265	£28.11									
4 Port 3/4"	15-07270	£37.18									
2 Port 1"	15-07280	£24.46	Pair 1" 1" FT x 1" MT	15-14049	£29.23	1"	15-91538	£3.65	1"	15-04830	£2.70
3 Port 1"	15-07285	£35.12									
4 Port 1"	15-07290	£46.54									

Manifold Plumbing

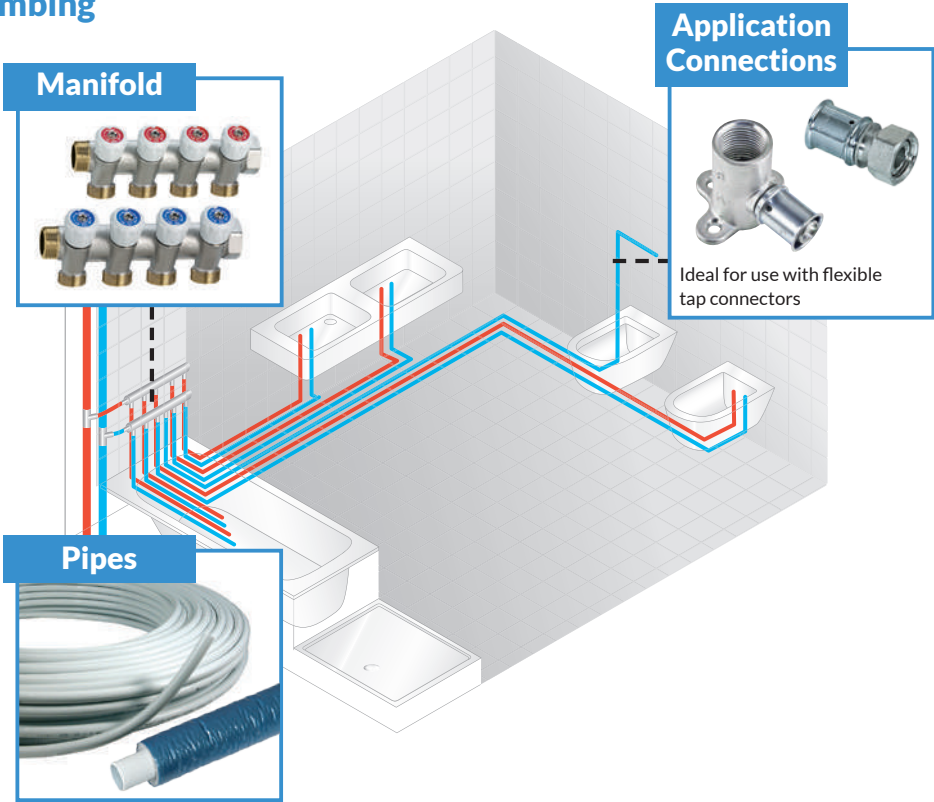

Modular Sanitary Manifold & Accessories

From left to right please select the appropriate manifold and associated parts for the complete manifold assembly. All parts supplied separately.

NOTE: Manifold pipe connectors must be selected according to the supply pipe specified. See descriptions below.

Please ensure correct quantities are ordered.



Bridging Piece



Slider Rail



Brackets



Pipe Connectors

Description	Part No.	Price	Description	Part No.	Price	Description	Part No.	Price	Description	Part No.	Price
3/4"	15-07200	£6.24	400mm	15-06400	£17.97	3/4"	15-02140	£10.83*	12x1.6mm MLCP	15-03121	£5.14
									16x2mm MLCP	15-03161	£3.27
									20mm MLCP / PEX / PE-RT / PB	15-03203	£4.44
1"	15-07210	£5.37	400mm	15-06400	£17.97	1"	15-02150	£11.01*	15mm Pex/PB	15-03151	£2.99
									16mm Pex/PB	15-03162	£4.60
									15mm Copper	15-21415	£1.82

*Price per 10 pairs

NOTE: All parts of the sanitary manifold are supplied seperately.

The table above shows sizing of manifold, (3/4" or 1"), along with all corresponding component parts.

Please ensure you select the correct sized manifold pipe connectors to suit the pipework to be installed. Each pipe type and size has different fittings.

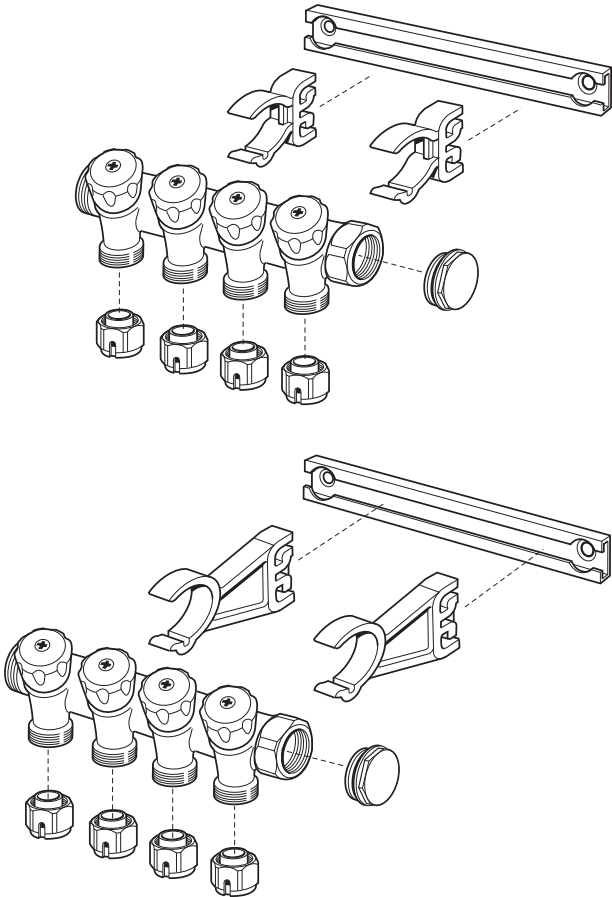

SANITARY MANIFOLDS



Multipipe Nickel Plated Brass Sanitary Manifolds & Accessories

Multipipe 3/4" sanitary manifold range with all associated component parts and fixing. Product is Wras approved.



Manifold



Ball Valves



Male Blanking Plugs

Description	Part No.	Price	Description	Part No.	Price	Description	Part No.	Price
2 Port 3/4"	15-82050	£36.36	Pair 3/4" Manifold Ball Valve 3/4" FT x 3/4" MT	35-14050	£20.16	3/4"	15-04820	£2.55
3 Port 3/4"	15-82052	£45.03						
4 Port 3/4"	15-82054	£56.39						
5 Port 3/4"	15-82056	£62.86						
6 Port 3/4"	15-82058	£71.45						
7 Port 3/4"	15-82060	£82.02						
8 Port 3/4"	15-82062	£94.95						
9 Port 3/4"	15-82064	£103.45						
10 Port 3/4"	15-82066	£117.75						
11 Port 3/4"	15-82068	£126.21						
12 Port 3/4"	15-82070	£134.56						

NOTE: All parts of the sanitary manifold are supplied seperately.

The table above shows sizing of manifold, along with all corresponding component parts.

Please ensure you select the correct sized manifold pipe connectors to suit the pipework to be installed. Each pipe type and size has different fittings.

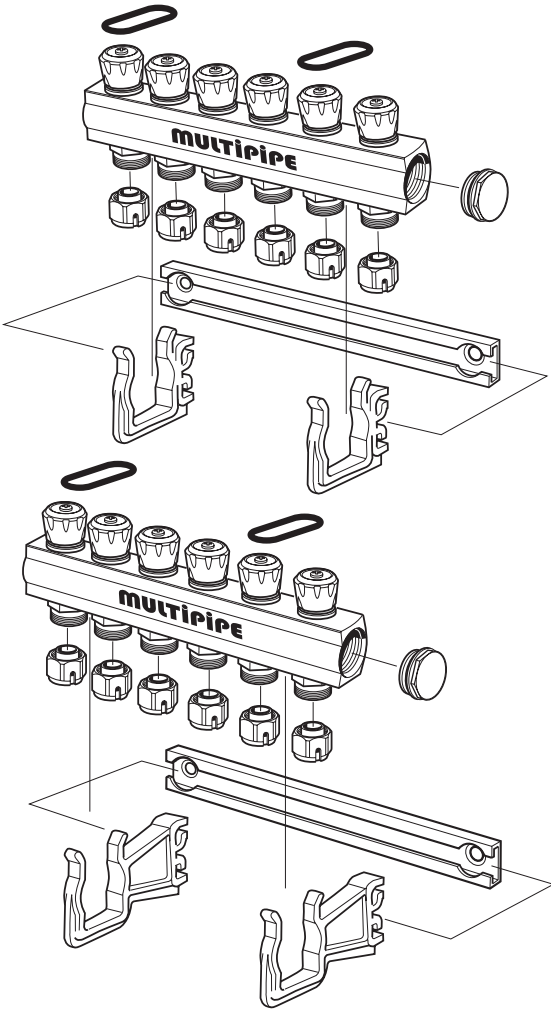

Multipipe Nickel Plated Brass Sanitary Manifolds & Accessories

From left to right please select the appropriate manifold and associated parts for the complete manifold assembly. All parts supplied seperately.
NOTE: Manifold pipe connectors must be selected according to the supply pipe specified. See descriptions below.
Please ensure correct quantities are ordered.



Slider Rail



Brackets



Pipe Connectors

Description	Part No.	Price	Description	Part No.	Price	Description	Part No.	Price
400mm	15-06400	£17.97	¾"	15-02120	£14.66*	12x1.6mm MLCP	15-03121	£5.14
						16x2mm MLCP	15-03161	£3.27
						20mm MLCP / PEX / PE-RT / PB	15-03203	£4.44
						15mm Pex/PB	15-03151	£2.99
						16mm Pex/PB	15-03162	£4.60
						15mm Copper	15-21415	£1.82

* Price is for 10 pairs

See Page 59

Pre-Insulated Pipe Systems for below ground installations

Multipipe is delighted to present our newest and incredibly exciting partnership with Terrendis. Multipipe now acts as sole UK distributor for Terrendis systems and products with high levels of stock in the UK, across the range of heating, sanitary and cooling pipe systems.

Terrendis is a pre-insulated, flexible, energy-saving PE-Xa piping system that is perfectly suited for transporting hot water between the remote heat source and the building applications.

- Unequalled flexibility for easy installation
- Perfect for renewable energy applications
- Supplied in 10m, 15m and 20m packs - or cut to length
- A solution for every application

See page 59 for more information



SANITARY MANIFOLD SYSTEMS



Modular Sanitary Manifold

Multiplex Brass Manifolds. WRAS approved nickel plated cast brass manifolds in ¾" and 1" sizes, and DN20 outlets.

Part No.	Description	Unit	Price Each
15-07260	2-Port ¾"	1	£19.74
15-07265	3-Port ¾"	1	£28.11
15-07270	4-Port ¾"	1	£37.18
15-07280	2-Port 1"	1	£24.46
15-07285	3-Port 1"	1	£35.12
15-07290	4-Port 1"	1	£46.54



End Caps & Blanking Plugs

Nickel plated brass Female end cap / Male plug for use with Sanitary Manifold ¾" & 1" Sizes.

Part No.	Description	Unit	Price Each
15-91536	Female cap & washer ¾"	1	£2.37
15-91538	Female cap & washer 1"	1	£3.65
15-04820	Male plug with o-ring seal ¾"	1	£2.55
15-04830	Male plug with o-ring seal 1"	1	£2.70



Ball Valves

Pair of ball valves suitable for sanitary or Wall Hung radiator systems, ¾" and 1" options.

Part No.	Description	Unit	Price Each
35-14050	Pair ¾" Manifold Ball Valves (Red) ¾" FT x ¾" MT Union Valve	Pair	£20.16
15-14049	Pair 1" Manifold Ball Valves FT x MT Red and Blue Union Valve	Pair	£29.23

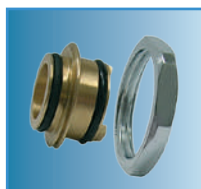

Bridging Pieces

Nickel plated brass Bridging Piece for use with Sanitary Manifold ¾" & 1" Sizes. For use when coupling manifolds together.

Part No.	Description	Unit	Price Each
15-07200	¾" Manifold bridging piece	1	£6.24
15-07210	1" Manifold bridging piece	1	£5.37



Eurocone Connectors 24x19mm Threads

Nickel plated brass Eurcone Pipe and Manifold connector for use with Sanitary Manifold (Please ensure correct pipe connector is chosen as pipe dimensions differ).

Part No.	Description	Unit	Price Each
15-03121	MLCP Manifold Connector (Brass UFH) 12x1.6	1	£5.14
15-03161	MLCP Manifold Connector (Brass UFH) 16mm	1	£3.27
15-03203	PEX / PE-RT / MLCP Manifold Connector (Brass UFH) 20mm	1	£4.44
15-03151	PEX / PB Pipe Manifold Connector (Brass UFH) 15mm	1	£2.99
15-03162	PEX / PB Pipe Manifold Connector (Brass UFH) 16mm	1	£4.60
15-21415	15mm copper pipe connector 24x19	1	£1.82



Slider Rail & Brackets

Aluminium Slider Rail for use with with plastic slider brackets and sanitary manifolds - Note 400mm Brackets are snapable - complete with required fixings. Plastic sanitary manifold brackets for use with slider rail, ¾" & 1" Sizes. Supplied in pairs. 10 pairs per bag.

Part No.	Description	Unit	Price Each
15-06400	Manifold Bracket Slider Rail 400mm	1	£17.97
15-02140	Pair ¾" Manifold Brackets - supplied as 10 pairs	10	£10.83
15-02150	Pair 1" Manifold Brackets - supplied as 10 pairs	10	£11.01



Nut & Insert Adapter - Nickel Plated

Nickel plated brass nut and insert compression adapter for MLCP. Used to adapt to copper compression and radiator valves etc. NOTE: threads must be checked.

Part No.	Description	Unit/Bag	Unit/Carton	Price Each
34-13813G	12x15mm	10	200	£2.66
12-79710	16x15mm	10	200	£2.90

SANITARY MANIFOLD SYSTEMS



Sanitary/Heating Manifold

Topsan Nickel-plated brass banifolds. WRAS approved nickel plated cast brass manifolds in ¾" size, and 24 x 19 Takeoff connections.

Part No.	Description	Unit	Price Each
15-82050	2 Port ¾"	1	£36.36
15-82052	3 Port ¾"	1	£45.03
15-82054	4 Port ¾"	1	£56.39
15-82056	5 Port ¾"	1	£62.86
15-82058	6 Port ¾"	1	£71.45
15-82060	7 Port ¾"	1	£82.02
15-82062	8 Port ¾"	1	£94.95
15-82064	9 Port ¾"	1	£103.45
15-82066	10 Port ¾"	1	£117.75
15-82068	11 Port ¾"	1	£126.21
15-82070	12 Port ¾"	1	£134.56



End Caps & Blanking Plugs

Nickel plated brass Female end cap / Male plug for use with Sanitary Manifold ¾".

Part No.	Description	Unit	Price Each
15-04820	Male plug with o-ring seal ¾"	1	£2.55



Ball Valves

Pair of ball valves suitable for sanitary or Wall Hung radiator systems, ¾" and 1" options.

Part No.	Description	Unit	Price Each
35-14050	Pair ¾" Manifold Ball Valves (Red) ¾" FT x ¾" MT Union Valve	Pair	£20.16



Eurocone Connectors 24x19mm Threads

Nickel plated brass Eurcone Pipe and Manifold connector for use with Sanitary Manifold (Please ensure correct pipe connector is chosen as pipe dimensions differ).

Part No.	Description	Unit	Price Each
15-03121	MLCP Manifold Connector (Brass UFH) 12x1.6	1	£5.14
15-03161	MLCP Manifold Connector (Brass UFH) 16mm	1	£3.27
15-03203	PEX / PE-RT / MLCP Manifold Connector (Brass UFH) 20mm	1	£4.44
15-03151	PEX / PB Pipe Manifold Connector (Brass UFH) 15mm	1	£2.99
15-03162	PEX / PB Pipe Manifold Connector (Brass UFH) 16mm	1	£4.60
15-21415	15mm copper pipe connector 24x19	1	£1.82



Slider Rail & Brackets

Aluminium Slider Rail for use with with plastic slider brackets and sanitary manifolds - Note 400mm Brackets are snapable - complete with required fixings. Plastic sanitary manifold brackets for use with slider rail, ¾" size. Supplied in pairs. 10 pairs per bag.

Part No.	Description	Unit	Price Each
15-06400	Manifold Bracket Slider Rail 400mm	1	£17.97
15-02120	Pair ¾" Manifold Brackets - supplied as 10 pairs	10	£14.66



Nut & Insert Adapter - Nickel Plated

Nickel plated brass nut and insert compression adapter for MLCP. Used to adapt to copper compression and radiator valves etc. NOTE: threads must be checked.

Part No.	Description	Unit/Bag	Unit/Carton	Price Each
34-13813G	12x15mm	10	200	£2.66
12-79710	16x15mm	10	200	£2.90



Chromed Radiator Compression Elbow

Nickel plated brass elbow with 15mm spigot for connecting MLCP to radiators using 12mm (34-13813) and 16mm (12-79710) compression adapters (see above)

Part No.	Description	Unit/Bag	Unit/Carton	Price Each
12-15015	½" Male iron x 15mm Dia spigot x 16mm long	10	10	£6.56

WALL HUNG RADIATOR MANIFOLD SYSTEMS

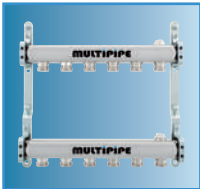

Multipipe Wall Hung Radiator Nickel Plated Brass Manifold

1" pre-assembled stainless steel manifold designed for point to point radiator installation. Available from 2 to 12 ports with flow and returns manifolds. See below table for selection of the correct components required. NOTE: which run-out pipe being used will determinethe manifold/pipe connector required. Sizes are listed within the below chart. If you require any assistance here, please call our team. Manifolds have 3/4 " take-offs to suit eurocone pipe connectors and include Pair of End Caps and Manual Air Vents.

New!



Manifold



Ball Valves



Eurocone Manifold Pipe Connectors

Description	Part No.	Price	Description	Part No.	Price	Description	Part No.	Price
2-Port 1" Manifold	21-99670	£80.48	Pair 1" Manifold Ball Valves 1" FT x 1" MT	21-14049	£35.51	12x1.6mm (3/4" FT)	20-03123	£3.78
3-Port 1" Manifold	21-99672	£94.50				15mmx2mm (3/4" FT)	20-03151	£3.78
4-Port 1" Manifold	21-99674	£107.27				16x2mm (3/4" FT)	20-03161	£3.78
5-Port 1" Manifold	21-99676	£128.71				20x2mm (3/4" FT)	20-03203	£4.07
6-Port 1" Manifold	21-99678	£144.10						
7-Port 1" Manifold	21-99680	£167.56						
8-Port 1" Manifold	21-99682	£187.32						
9-Port 1" Manifold	21-99684	£203.41						
10-Port 1" Manifold	21-99686	£220.68						
11-Port 1" Manifold	21-99688	£235.71						
12-Port 1" Manifold	21-99690	£250.04						

Pair 1" Isolating ball valves
21-14049

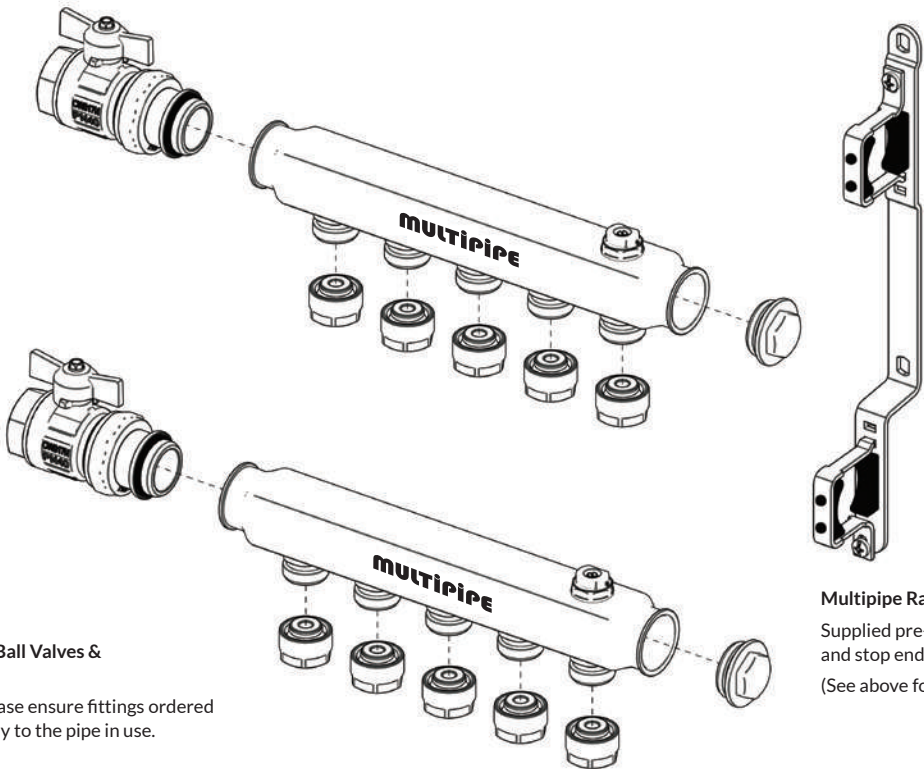

Manifold Isolating Ball Valves & Pipe connectors
Sold Separately, please ensure fittings ordered correspond correctly to the pipe in use.

Multipipe Radiator Manifold 1"
Supplied pre-assembled including brackets and stop end plugs
(See above for codes)

WALL HUNG RADIATOR MANIFOLD SYSTEMS

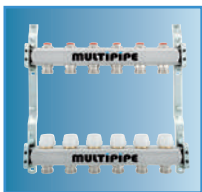

Multipipe Pre-Mounted Wall Hung Radiator Nickel Plated Brass Manifold with Zone & Flow Rate Control

1" pre-assembled stainless steel lockshield manifold designed for point to point radiator installation. Available from 2 to 12 ports with flow and returns manifolds. See below table for selection of the correct components required. NOTE: which run-out pipe being used will determine the manifold/pipe connector required. Sizes are listed within the below chart. If you require any assistance here, please call our team. Manifolds have 3/4" take-offs to suit eurocone pipe connectors and include Pair of End Sets complete with fill, drain points and Manual Air Vents.

New!



Manifold



Ball Valves



Actuators



Eurocone Manifold Pipe Connectors

Description	Part No.	Price	Description	Part No.	Price	Description	Part No.	Price	Description	Part No.	Price
2-Port 1" Manifold	21-06113	£105.54	Pair 1" Manifold Ball Valves 1" FT x 1" MT	21-14049	£35.51	Actuator Head 230V	22-23023	£25.25	12x1.6mm (3/4" FT)	20-03123	£3.78
3-Port 1" Manifold	21-06114	£130.89							15mmx2mm (3/4" FT)	20-03151	£3.78
4-Port 1" Manifold	21-06115	£158.80							16x2mm (3/4" FT)	20-03161	£3.78
5-Port 1" Manifold	21-06116	£182.07				Actuator Head 24V	22-02422	£25.25	20x2mm (3/4" FT)	20-03203	£4.07
6-Port 1" Manifold	21-06117	£216.03									
7-Port 1" Manifold	21-06118	£264.36									
8-Port 1" Manifold	21-06119	£297.45									
9-Port 1" Manifold	21-06120	£328.76									
10-Port 1" Manifold	21-06121	£358.52									
11-Port 1" Manifold	21-06122	£384.73									
12-Port 1" Manifold	21-06123	£410.33									

NOTE: For full system controls see page 46 - 48

Pair 1" Isolating Ball Valves
21-14049 – supplied separately

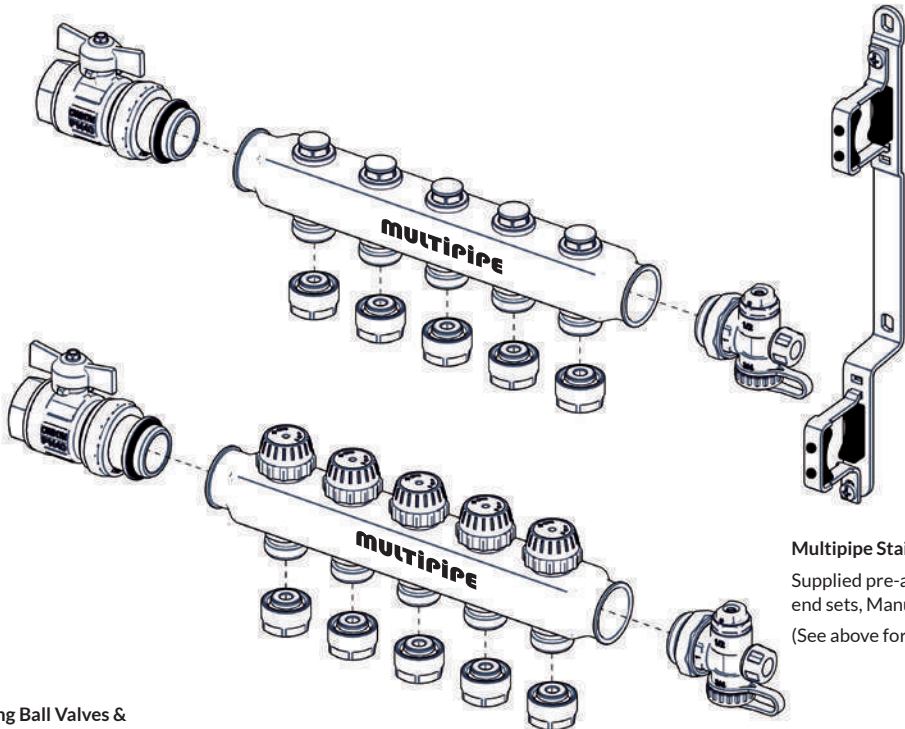

Multipipe Stainless Steel Lockshield Manifold 1"
Supplied pre-assembled including brackets, and end sets, Manual Air Vents and fill/drain valves.
(See above for codes)

Manifold Isolating Ball Valves &
Pipe connectors

Sold Separately, please ensure fittings ordered correspond correctly to the pipe in use.

WALL HUNG RADIATOR MANIFOLD SYSTEMS



Multipipe Wall Hung Stainless Steel Radiator Manifold

Pre-assembled unit designed for a faster, easier, more efficient installation, allowing you to minimise the number of joints, and making control of commissioning and maintenance simple. Valves sold separately. Manifolds have ¼" take-offs to suit eurocone pipe connectors and include Pair of End Caps and Manual Air Vents.

New!

Part No.	Description	Unit	Price Each
21-99670	2-Port 1" Manifold	1	£80.48
21-99672	3-Port 1" Manifold	1	£94.50
21-99674	4-Port 1" Manifold	1	£107.27
21-99676	5-Port 1" Manifold	1	£128.71
21-99678	6-Port 1" Manifold	1	£144.10
21-99680	7-Port 1" Manifold	1	£167.56
21-99682	8-Port 1" Manifold	1	£187.32
21-99684	9-Port 1" Manifold	1	£203.41
21-99686	10-Port 1" Manifold	1	£220.68
21-99688	11-Port 1" Manifold	1	£235.71
21-99690	12-Port 1" Manifold	1	£250.04



Ball Valves

Pair of ball isolation valves suitable for Stainless Steel Radiator Manifolds, 1" options.

New!

Part No.	Description	Unit	Price Each
21-14049	Pair 1" Manifold Ball Valves 1" FT x 1" MT (Red / Blue)	Pair	£35.51



Eurocone Pipe Connectors (¾" FT)

Female thread ¾" compression Eurocone for use with Stainless Steel Radiator Manifolds.

Part No.	Description	Unit	Price Each
20-03123	Eurocone Manifold Pipe Connector 12x1.6mm (¾" FT)	1	£3.78
20-03151	Eurocone Manifold Pipe Connector 15x2mm (¾" FT)	1	£3.78
20-03161	Eurocone Manifold Pipe Connector 16x2mm (¾" FT)	1	£3.78
20-03203	Eurocone Manifold Pipe Connector 20x2mm (¾" FT)	1	£4.07



Manifold & Parts Accessories (for Stainless Steel UFH Manifolds)

New!

Part No.	Description	Unit	Price Each
21-53135	1" Male Manifold End Cap with O Ring	1	£3.68
21-53121	Manual Air Vent (½")	1	£1.75
21-06298	Manifold End T Piece with ½" Outlets	1	£8.38
21-06426	1" Male - Male Coupling with O ring	1	£20.43
21-53114	Adapter Seat (½"MT x ¾"MT) for Use with Radiator Manifold	1	£2.80



Pipe and Seal Guide for 12mm Systems, Nut and Insert Adapter for 12mm Pipe

This Manthorpe pipe bend guide allows for a neat and accurate way to bring pipework through the wall into a room. (For use with 12mm pipework only)

Part No.	Description	Unit	Price Each
34-10001	Manthorpe Pipe and Seal Guide for 12mm pipe systems	1	£14.75
34-13813G	12x15mm	10	£2.66
12-15015	½" Male iron x 15mm Dia spigot x 16mm long	10	£6.56

Weld fittings



Weld fittings:

- Patented technology - Extremely secure connections as a result of specially engineered fitting geometry and material locking
- Welded inside and outside for the highest degree of safety
- Up to 90% weight reduction compared to metal press fittings
- Sizes from 16-75mm for a wide range of applications
- Cost effective solution

Contact us on 01245 227630 for further details.



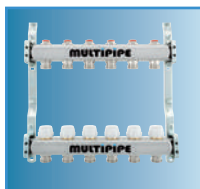

Multipipe Wall Hung Stainless Steel Lockshield Radiator Manifold

Pre-assembled unit designed for a faster, easier, more efficient installation, allowing you to minimise the number of joints, and making control of commissioning and maintenance simple. Valves sold separately. Manifolds have ¼" take-offs to suit eurocone pipe connectors and include Pair of End Sets complete with fill, drain points and Manual Air Vents.

New!

Part No.	Description	Unit	Price Each
21-06113	2-Port 1" Manifold	1	£105.54
21-06114	3-Port 1" Manifold	1	£130.89
21-06115	4-Port 1" Manifold	1	£158.80
21-06116	5-Port 1" Manifold	1	£182.07
21-06117	6-Port 1" Manifold	1	£216.03
21-06118	7-Port 1" Manifold	1	£264.36
21-06119	8-Port 1" Manifold	1	£297.45
21-06120	9-Port 1" Manifold	1	£328.76
21-06121	10-Port 1" Manifold	1	£358.52
21-06122	11-Port 1" Manifold	1	£384.73
21-06123	12-Port 1" Manifold	1	£410.33



Ball Valves

Pair of ball isolation valves suitable for Stainless Steel Lockshield Manifolds, 1" options.

New!

Part No.	Description	Unit	Price Each
21-14049	Pair 1" Manifold Ball Valves 1" FT x 1" MT	Pair	see page 28



Eurocone Pipe Connectors (¾" FT)

Female thread ¾" compression Eurocone for use with Stainless Steel Radiator Manifolds.

Part No.	Description	Unit	Price Each
20-03123	Eurocone Manifold Pipe Connector 12x1.6mm (¾" FT)	1	£3.78
20-03151	Eurocone Manifold Pipe Connector 15x2mm (¾" FT)	1	£3.78
20-03161	Eurocone Manifold Pipe Connector 16x2mm (¾" FT)	1	£3.78
20-03203	Eurocone Manifold Pipe Connector 20x2mm (¾" FT)	1	£4.07



Lockshield for LSP Manifold

Lockshield for LSP Manifold

New!

Part No.	Description	Unit	Price Each
21-53129	Lockshield for LSP Manifold	1	£4.28
21-53114	Adapter Seat (½"MT X ¾"MT) for Use only with Lockshield Valve	1	£2.80



Manifold & Parts Accessories (for Stainless Steel UFH Manifolds)

New!

Part No.	Description	Unit	Price Each
21-53135	1" Male Manifold End Cap with O Ring	1	£3.68
21-53121	Manual Air Vent (½")	1	£1.75
21-53119	Automatic Air Vent (½")	1	£7.75
21-53120	Adjustable Drain Valve (½")	1	£11.12
21-06298	Manifold End T Piece with ½" Outlets	1	£8.38
21-06426	1" Male - Male Coupling with O ring	1	£20.43
21-53116	Lockshield Pin Assembly for Actuator	1	£6.46
21-53114	Adapter Seat (½"MT X ¾"MT) for Use only with Lockshield Pin Assembly	1	£2.80
21-53127	Pressure Gauge 0-6 bar (½")	1	£12.02
22-23023	230V Actuator (Normally closed. 2 wire, For use with Lockshield Manifold)	1	£25.25
22-02422	24V Actuator (Normally closed. 2 wire, For use with Lockshield Manifold)	1	£25.25



Pipe and Seal Guide for 12mm Systems, Nut and Insert Adapter for 12mm Pipe

This Manthorpe pipe bend guide allows for a neat and accurate way to bring pipework through the wall into a room. (For use with 12mm pipework only)

Part No.	Description	Unit	Price Each
34-10001	Manthorpe Pipe and Seal Guide for 12mm pipe systems	1	£14.75
34-13813G	12x15mm	10	£2.66
12-15015	½" Male iron x 15mm Dia spigot x 16mm long	10	£6.56